

CERTIFIED LAND CORNER RESTORATION

Index No. N-12

**N12**

State of Wisconsin }  
County of Forest } ss.

History of original corner establishment:

No evidence of any previous corner.

I Glen Barker, do hereby certify that on the 14th day of October, 19 82, I found evidence of the E 1/16 corner of Sections 16 & 21 Township 35, North, Range 13 East, Fourth Principal Meridian, as described hereon; and that from this evidence I established a new monument and accessories as described hereon to perpetuate the original location of this corner.

Description of corner evidence found:

Total distance from section corner 15-16-21-22 to 1/4 between 16-21 is 2615.11 ft. at bearing N88-31-59W. Set E1/16 1307.56 ft. intermediate.

Resident witnesses:

J. Claflin - R.L.

H. Wagoner

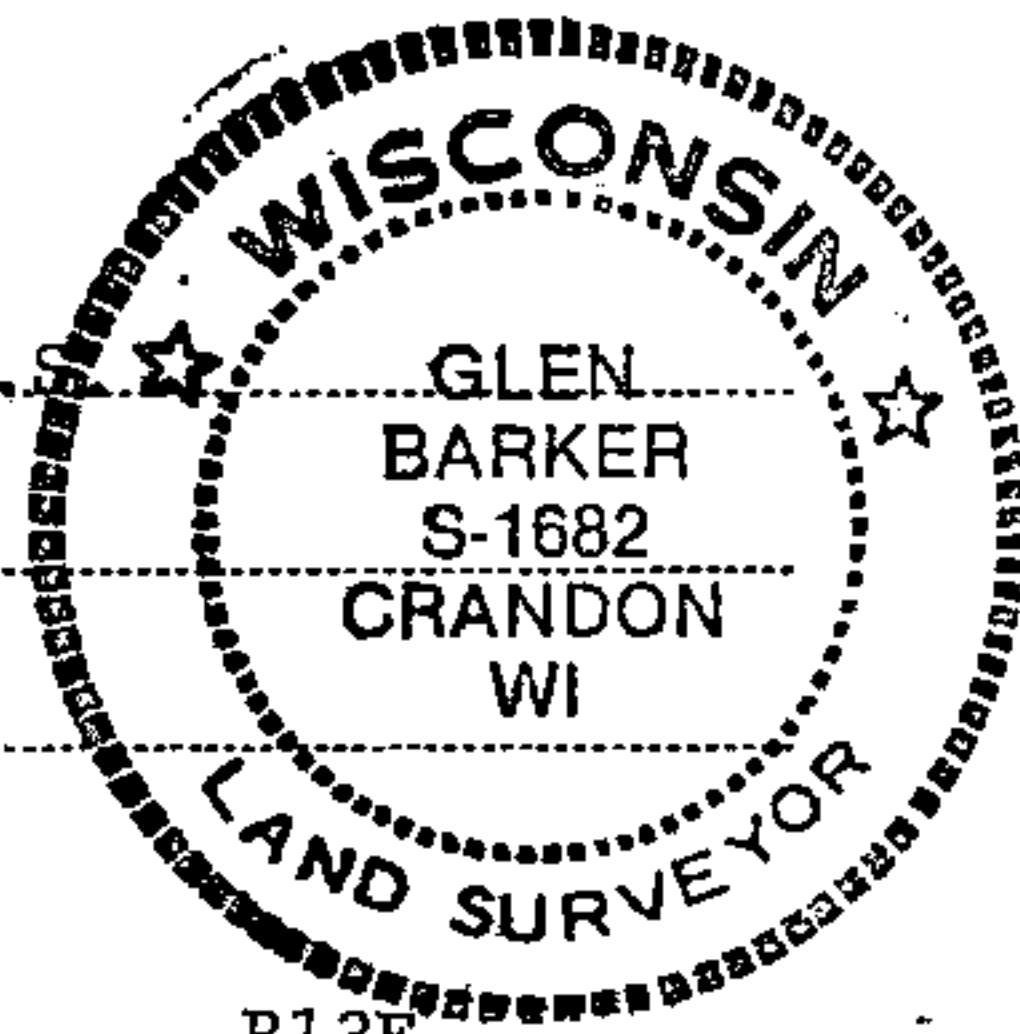

Description of monument and accessories I established to perpetuate the original location of this corner.

Set an iron railroad spike for true corner approximately 2 ft. south of centerline of Keith Siding Road. Set a 1" iron pipe with 2" diameter alloy cap for reference corner stamped:

Monument projects 18" above ground.

Marked NBTs to true corner

Maple 6" S13E 51.64 ft.

W. Birch 8" S34W 51.84 ft.

S1682

T35N R13E

E 1/16 S 16 Ref  
S 21 Cor.

N. 40 Ft.

C.P.I. - 1982

FORM 985 H. C. MILLER CO., MILWAUKEE

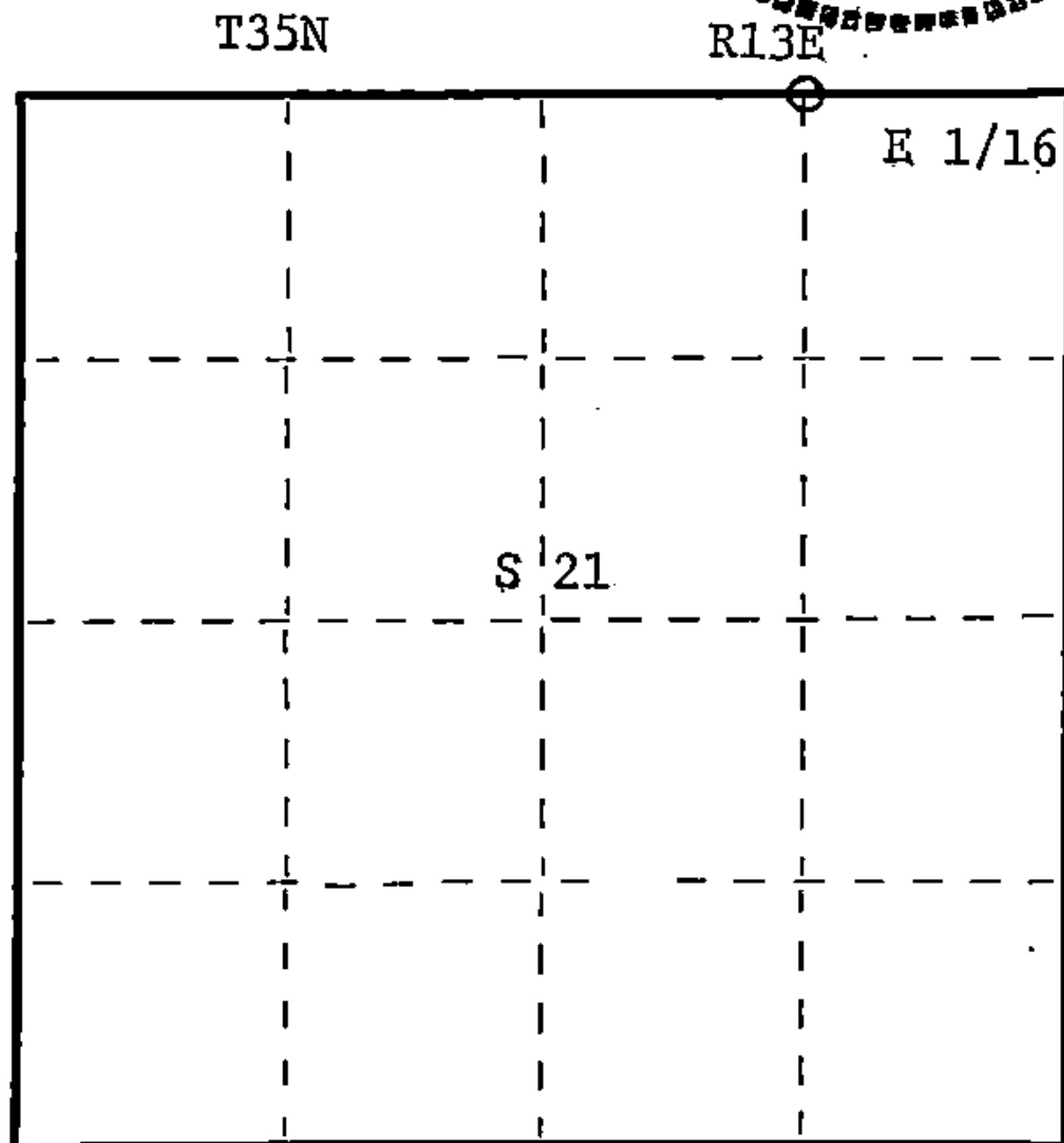

○ = Corner monument restored.

Dated at Rhineland, Wis., this 30th day of Dec., 1982

Signature Glen Barker Title Registered Land Surveyor Registration No. S1682  
(County Surveyor, Registered Land Surveyor, or other duly authorized official)

Office of Register of Deeds, County of Forest, I hereby certify that the within instrument was filed in this office for record on the 16th day of February, 1983 at 10:30 o'clock A. M.

Eugene Staszny  
(Register of Deeds)

DOCUMENT NO. **122911**

By \_\_\_\_\_ Deputy

43513160010