

CERTIFIED LAND CORNER RESTORATION

Index No. N-24

State of Wisconsin }
County of Forest } ss.

I Glen Barker, do hereby certify that on the 16th day of September, 1984, I ~~found~~ established evidence of the E 1/16 corner of Sections 13 & 24 Township 35, North, Range 13 East, Fourth Principal Meridian, as described hereon; and that from this evidence I established a new monument and accessories as described hereon to perpetuate the original location of this corner.

Resident witnesses:

N. Spiess

H. Wagoner

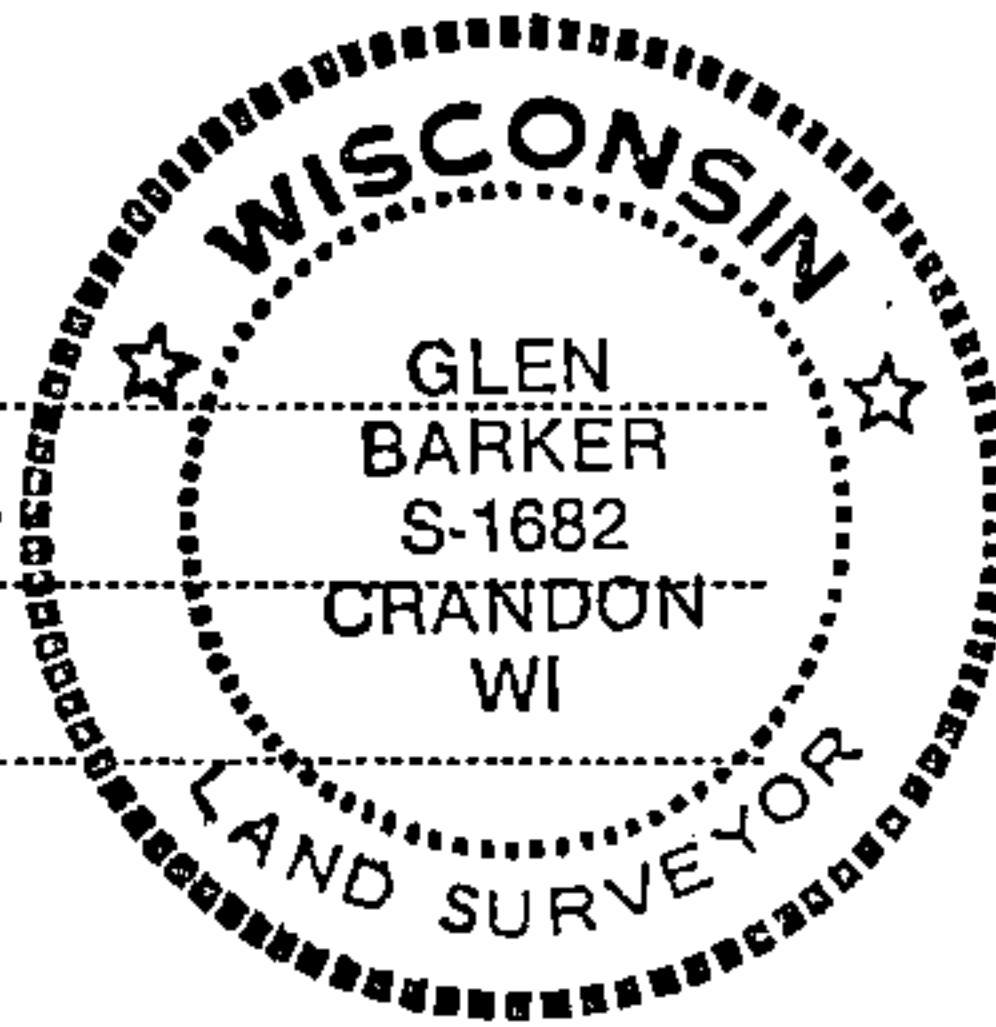

T35N R13E

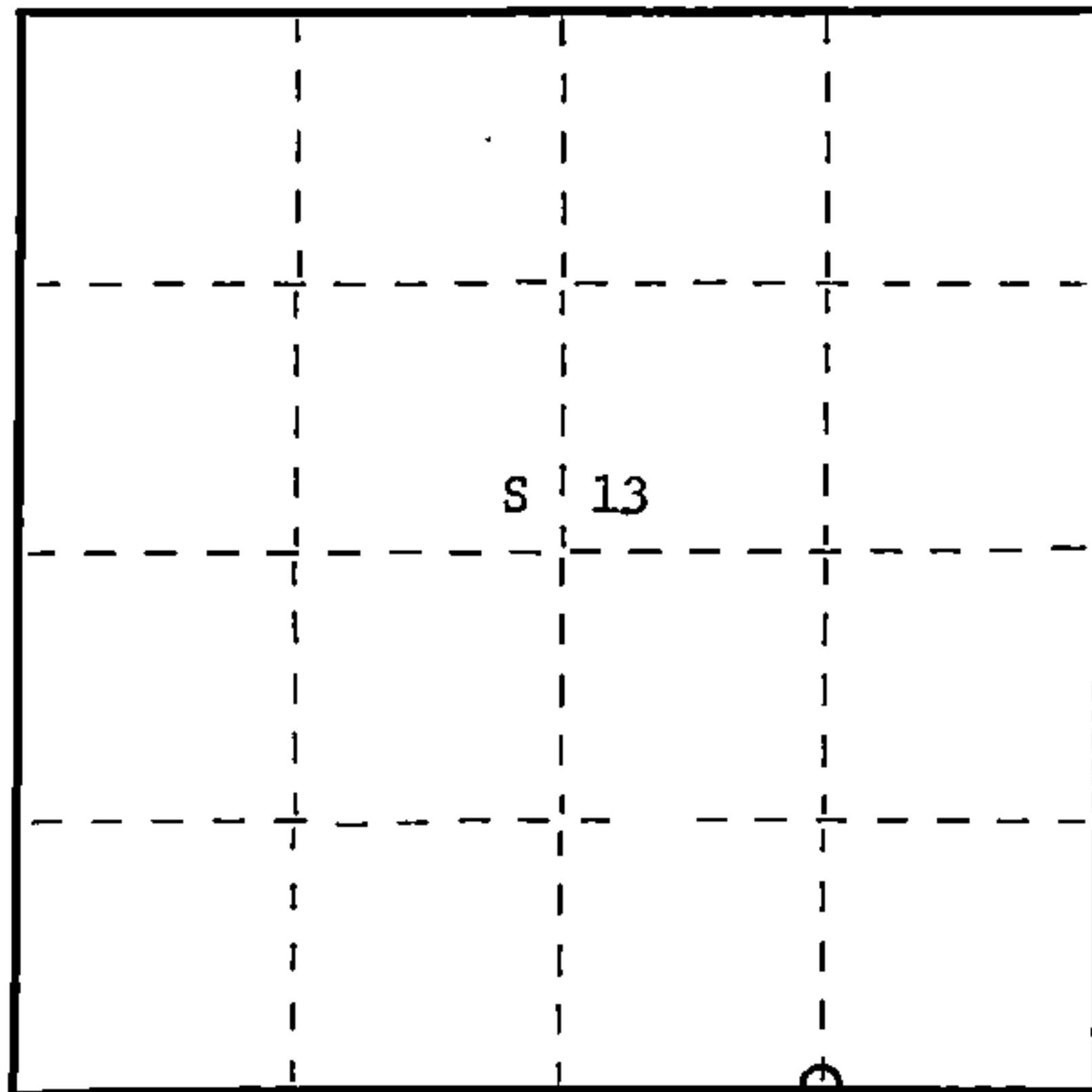

○ = Corner monument restored.

History of original corner establishment:

3"x3" wood post set by Kimberly Clark Corp. in 1964. Post set by compass and is not a recorded corner.

Description of corner evidence found:

Total distance from Section corner 13-24 - ~~18019~~ T35N R13 & 14E to 1/4 corner between 13 & 24 is 2612.64'. Set E 1/16 1306.32' intermediate.

3"x3" wood post bears S88W 8.10'

Description of monument and accessories I established to perpetuate the original location of this corner.

Set a 1" iron pipe with 2" diameter alloy cap stamped: S1682

Monument projects 18" above ground. T35N

Marked NBTs:

Yellow birch 6" S15W 15.56' E 1/16 S 13
Sugar 6" N26W 18.0' S 24
R13E

CPI - 1984

Dated at Rhinelander, Wis., this 12th day of October, 1984

Signature Glen Barker Title Registered Land Surveyor Registration No. 1682

(County Surveyor, Registered Land Surveyor, or other duly authorized official)

Office of Register of Deeds, County of Forest, I hereby certify that the within instrument was filed in this office for record on the 20th day of December, 1984 at 1:15 o'clock P. M.

Eugene Staszynski
(Register of Deeds)

Document Number **126961**

By _____ Deputy

FORM 985 H. C. MILLER CO., MILWAUKEE

43513130010