

U. S. PUBLIC LAND SURVEY MONUMENT RECORD

INSTRUCTIONS:

This record shall show the location of the corner and shall include all of the following nine elements (a through i).

- (a) Identify the corner by reference to the U.S. public land survey system.
- = Corner monument restored.

Quarter Corner Common to Sections 1 and 6,
T.35 N., R.14 E., Forest County, Wisconsin.

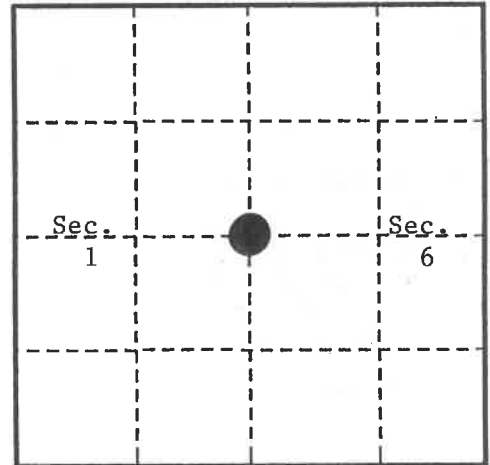

- (b) Describe any record evidence, monument evidence, occupational evidence, testimonial evidence or any other material evidence you considered, and whether the monument was found or placed.

In 1857 Alfred Millard set a post with the following references: Yellow Birch 18" N.27°E. 33 links; Hemlock 11" S.12°W. 25 links.

In 1940 C.E. Walker, County Surveyor, set a brass capped monument for corner.

In 1976 Thomas Arnott found corner as set by Walker and made the following references: Maple 10" S.84°W 7.32'; Maple 6" N.54°W. 10.65'.

In October, 1992 Alan Harrison found brass capped monument for corner as set by Walker and Arnotts references in good shape. Added one more B.T.

- (c) In the plan view drawing below, provide reference ties to at least 4 witness monuments, or, if the location is within a municipality, to at least 2 witness monuments. (witness monuments shall be made of concrete, natural stone, iron or other equally durable material.)

- (d) Show a plan view drawing depicting the relevant monuments and reference ties which is sufficient in detail to enable accurate relocation of the corner monument if the corner monument is disturbed. Indicate north.

1. 2" iron pipe monument with brass cap stamped to identify corner location.
2. Sugar 4" N.89°E. 29.43 feet
3. Maple 12" S.84°W. 7.32 feet
4. Maple 9" N.54°W. 10.65 feet
5. Steel Sign Post North 1.10 feet

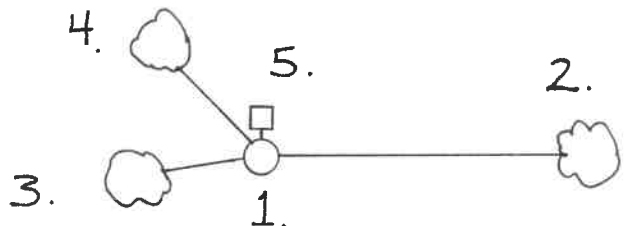

REGISTER'S OFFICE }
Forest County, Wis. }

Received for record this 20th day
of May A.D. 1993 at
8:45 o'clock A.M. and recorded
in Vol. Cooper Restorations
page

Paul Chubb, Deputy
Register of Deeds

0-1

(a) Describe any material discrepancy between the location of the corner as restored or reestablished and the location of that corner as previously restored or reestablished by distance and direction. Show the discrepancy on the plan view drawing under (d), above. Show the distances between the corner as previously restored or reestablished and (1) the corner as restored or reestablished, and (2) to at least 2 of the witness monuments shown on the drawing in (d), above.

None

(f) Was the corner restored through acceptance of (1) an obliterated evidence location, or, (2) a found perpetuated location?

(2) a found perpetuated location.

(g & h) Was the corner reestablished through lost corner proportionate methods? If so, show the method, including the directions and distances to other public land survey corners used as evidence or used for proportioning in determining the corner location?

No

(1) I, Alan D. Harrison, R.L.S.

(type or print name) certify that the corner location shown on this record was determined by me or under my direction and control and that this U.S. Public Land Survey Monument Record is correct and complete to the best of my knowledge and belief.



Signature

3/17/93

Date

CERTIFICATE READY FOR FILING:

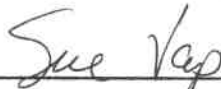

District Ranger

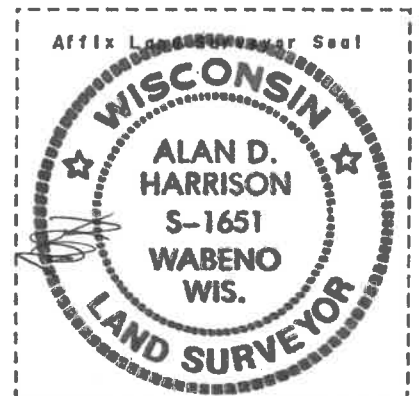

CERTIFIED LAND CORNER RESTORATION

Index No. **C 25**

State of Wisconsin }
County of Forest } ss.

History of original corner establishment:

I, Thomas R. Arnott, do hereby certify that on the 20th day of January, 1976, I found evidence of the 1/4 corner of Sections 1 & 6 Township 35, North, Range 13 & 14 E., Fourth Principal Meridian, as described hereon; and that from this evidence I established a new monument and accessories as described hereon to perpetuate the original location of this corner.

Y. Birch 18 N27E 33 Lks.
Hemlock 11 S12W 25 Lks.

Description of corner evidence found:

2" iron pipe 5' long with brass cap set by C.E. Walker in 1940

Resident witnesses:

.....
.....
.....

Description of monument and accessories I established to perpetuate the original location of this corner.

Left monument set by Walker

Ties:

Maple 6 N54W 10.65 feet
Maple 10 S84W 7.32 feet

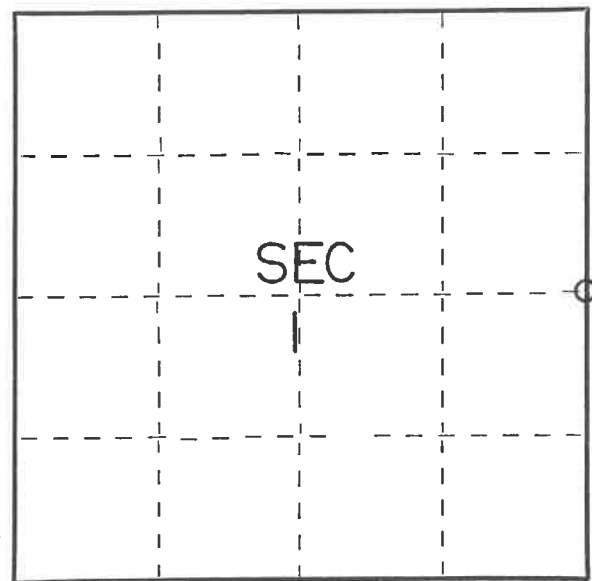

○ = Corner monument restored.

Dated at Crandon, Wis., this 23rd day of January, 1976.

Signature Thomas R. Arnott Title Surveyor Registration No. S-887
(County Surveyor, Registered Land Surveyor, or other duly authorized official)

Office of Register of Deeds, County of Forest, I hereby certify that the within instrument was filed in this office for record on the 23rd day of January, 1976 at 3 o'clock P. M.

Eugene Staszny Document Number **108633**
(Register of Deeds)

By..... Deputy

FORM 985 H. C. MILLER CO., MILWAUKEE

4351301 2000