

CERTIFIED LAND CORNER RESTORATION

Index No. G-18

G 18

State of Wisconsin }
County of Forest } ss.

History of original corner establishment:
No evidence of any previous corner.

I, Glen Barker, do hereby certify that on the 14th day of October, 19 83, ~~found~~ found evidence of the WC 1/16 corner of Section 11 Township 35, North, Range 12 East, Fourth Principal Meridian, as described hereon; and that from this evidence I established a new monument and accessories as described hereon to perpetuate the original location of this corner.

Description of corner evidence found:
Total distance from 1/4 corner between sections 10 and 11 to C1/4 Section 11 is 2593.46'.
Set WC 1/16 1296.73 intermediate.

Resident witnesses:

J. Claflin - RLS

H. Wagoner

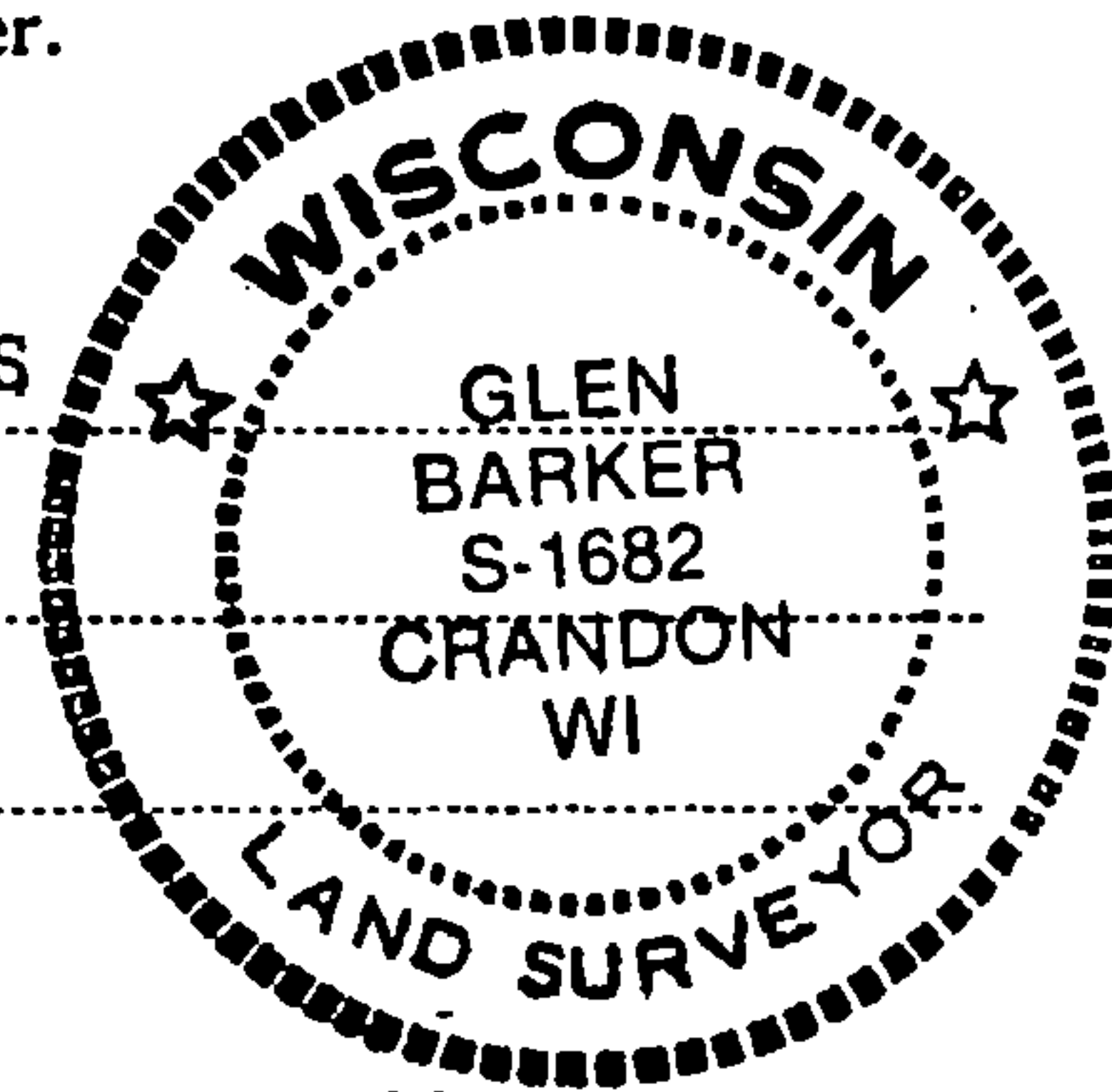

Description of monument and accessories I established to perpetuate the original location of this corner.
Set a 1" iron pipe with 2" diameter alloy cap stamped:

Monument projects 18" above ground.
Marked NBTs

Twin sugar 5" N64W 24.75'
Sugar 5" N86E 7.02'
Scribed 1/16 - B.T.

S1682
T35N R11E
S 11
WC 1/16
CPI - 1983

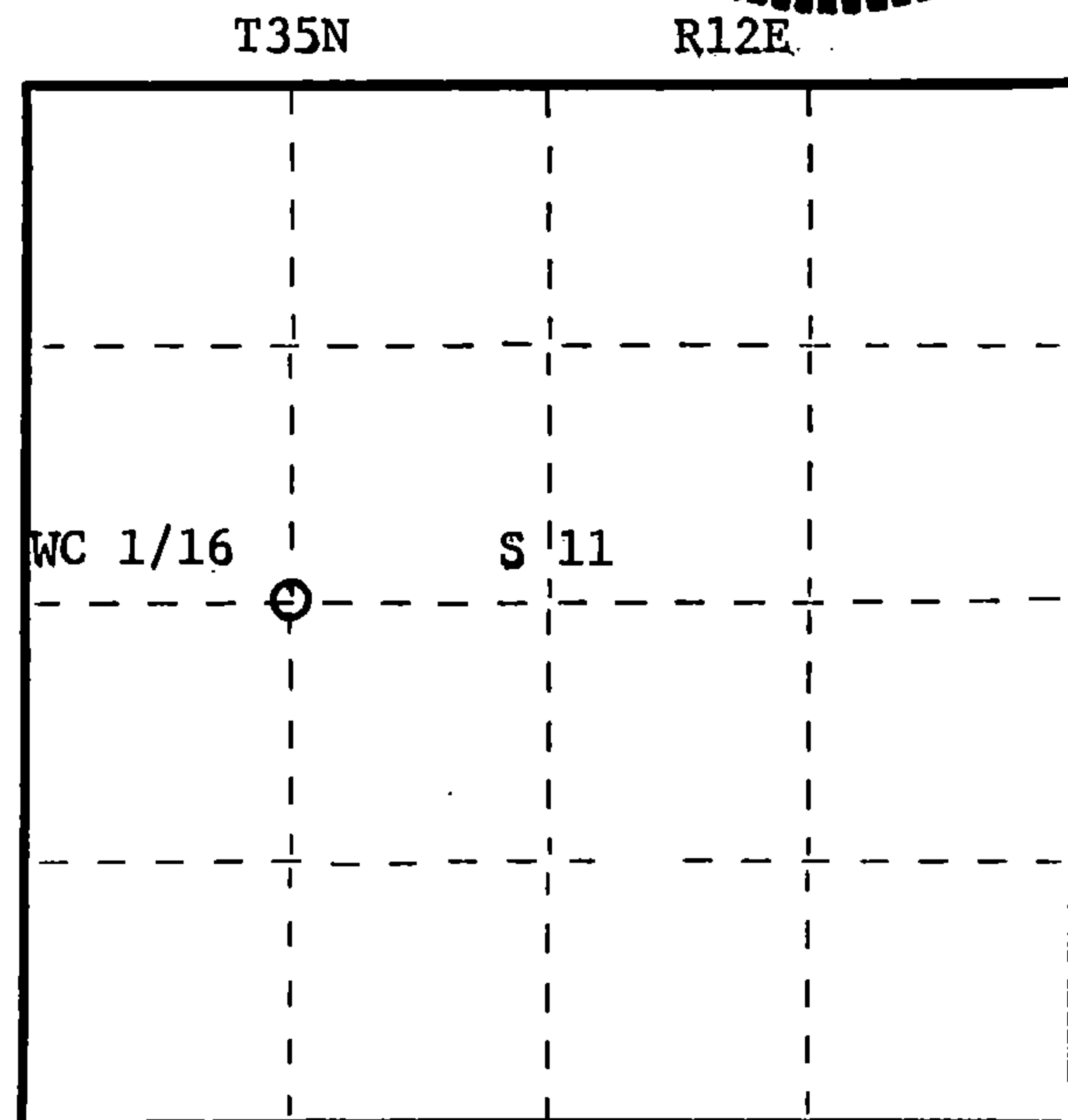

○ = Corner monument restored.

Dated at Rhinelander, Wis., this 22nd day of November, 19 83

Signature Glen Barker Title Registered Land Surveyor Registration No. S1682
(County Surveyor, Registered Land Surveyor, or other duly authorized official)

Office of Register of Deeds, County of Forest, I hereby certify that the within instrument was filed in this office for record on the 13th day of December, 19 83 at 10:30 o'clock A. M.

Eugene Stutzman
(Register of Deeds)

DOCUMENT NO. **124850**

By _____ Deputy

Stock No. 26272

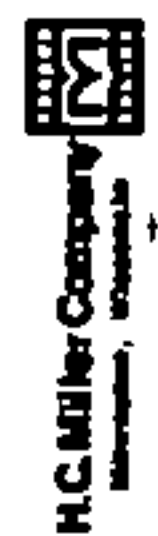

FORM 985

4351212030