

CERTIFIED LAND CORNER RESTORATION

Index No. F-5

State of Wisconsin }  
County of Forest } ss.

History of original corner establishment:  
No record of any previous survey.

I, Philip T. Hansen, do hereby certify that on the 2nd day of September, 1977, I found established ~~corner~~ of the N 1/16 corner of Section 7 & 8 Township 35, North, Range 12 East, Fourth Principal Meridian, as described hereon; and that from this evidence I established a new monument and accessories as described hereon to perpetuate the original location of this corner.

Description of corner evidence found:

No evidence of any corner recovered.  
Corner established by proportion from previously established 1/4 corner between Section 7 & 8, and Section 5, 6, 7 & 8. Computed 2685.605 (40.691 chains) at bearing S 0° 11' 21" E.  
Established N 1/16 at 20.345 chains intermediate.

Resident witnesses:

Glen Barker

Jim Claflin

Herb Wagoner

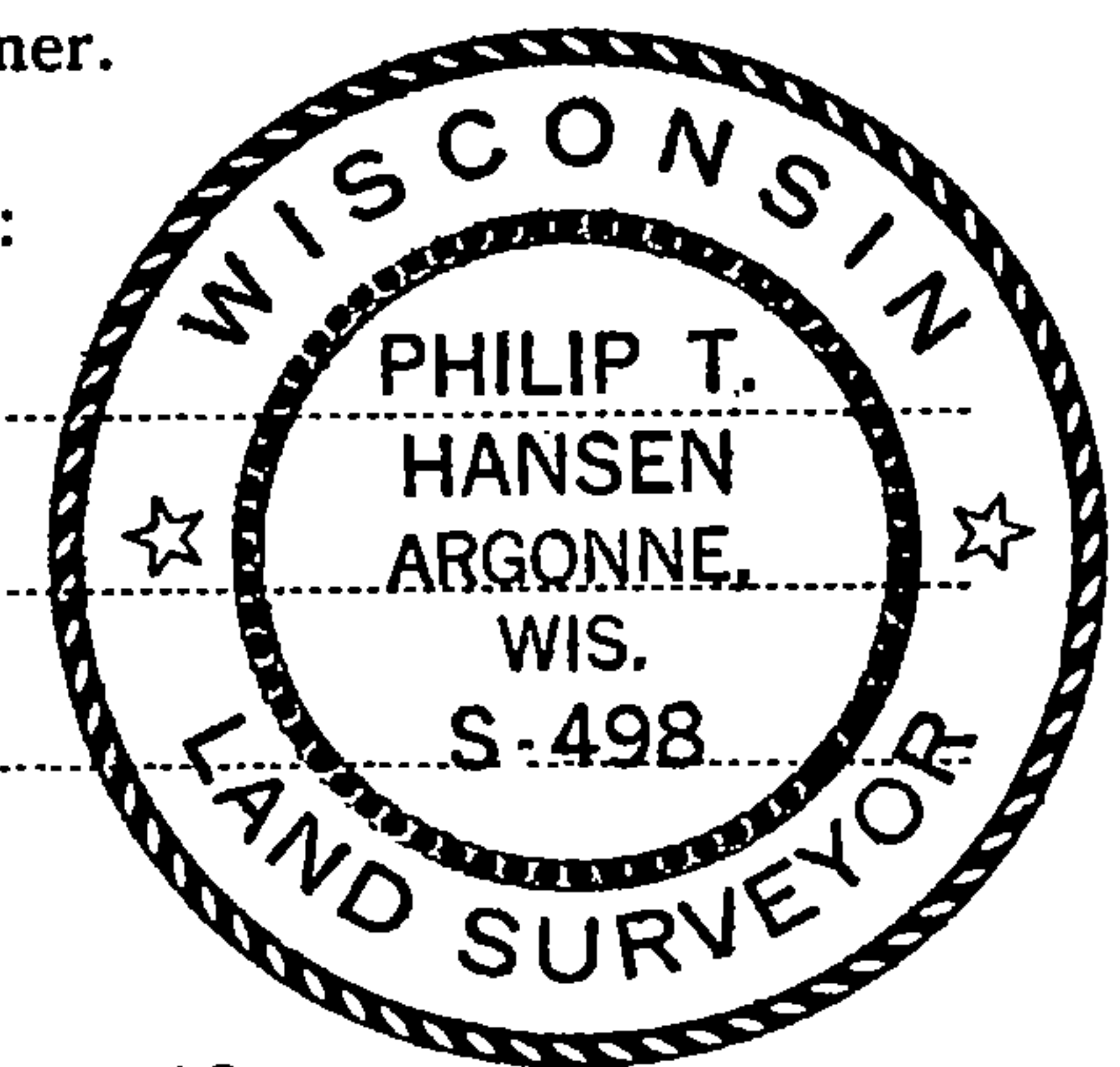

Description of monument and accessories I established to perpetuate the original location of this corner.

Set RR spike in blacktop road 2' east of centerline flush with surface for true corner.  
Set 1 1/2" iron pipe with 2" brass cap, projecting 24" above ground 55 links east of centerline of town road. Cap stamped:

Marked BT - White Birch 7" S50° E, 77.7 links, scribed N 1/16 BT.  
BO - Hi line pole 3512 8W5 N74° E, 28.3 links.

S498  
T35N R12E  
N 1/16 <sup>7</sup>+<sup>8</sup> W.C.  
CPI-1977

FORM 985 H. C. MILLER CO., MILWAUKEE

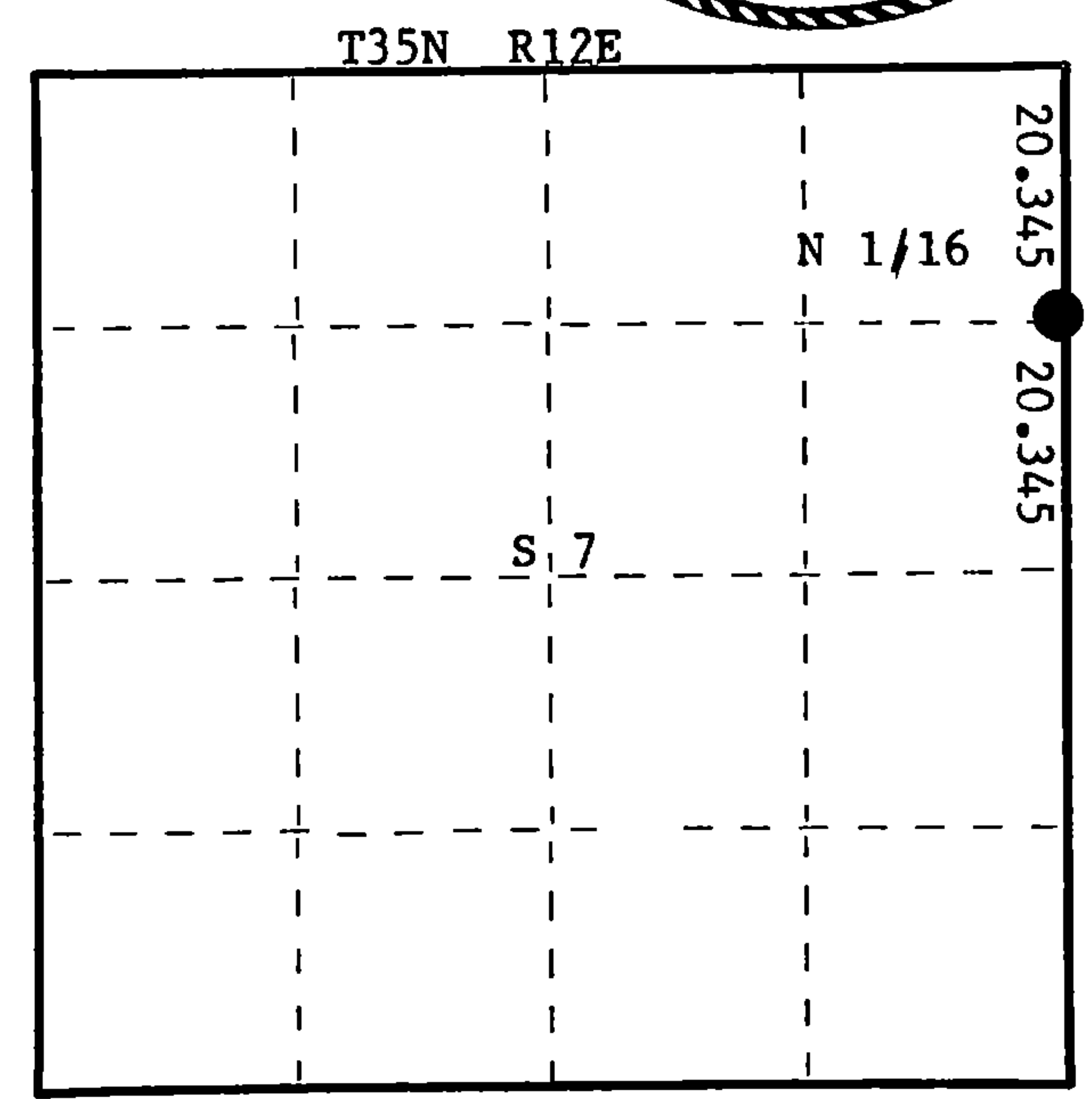

○ = Corner monument restored.

Dated at Rhineland, Wis., this 6th day of September, 1977.

Signature Philip T. Hansen Title Registered Land Surveyor Registration No. S-498  
(County Surveyor, Registered Land Surveyor, or other duly authorized official)

Office of Register of Deeds, County of Forest, I hereby certify that the within instrument was filed in this office for record on the 7th day of September, 1977 at 2:30 o'clock P. M.

Eugene Staszny  
(Register of Deeds)

By \_\_\_\_\_ Deputy

DOCUMENT NUMBER **-112282**

0003L02153h