

CERTIFIED LAND CORNER RESTORATION

Index No D-17

State of Wisconsin }
County of Forest } ss.

I, Philip T. Hansen, do hereby certify that on the 12th day of October, 1977, I ~~found~~ established evidence of the S 1/16 corner of Section 2 & 3 Township 35 North, Range 12 East, Fourth Principal Meridian, as described hereon; and that from this evidence I established a new monument and accessories as described hereon to perpetuate the original location of this corner.

Resident witnesses:

Glen Barker

Jim Claflin

Herb Wagoner



FORM 985 H. C. MILLER CO., MILWAUKEE

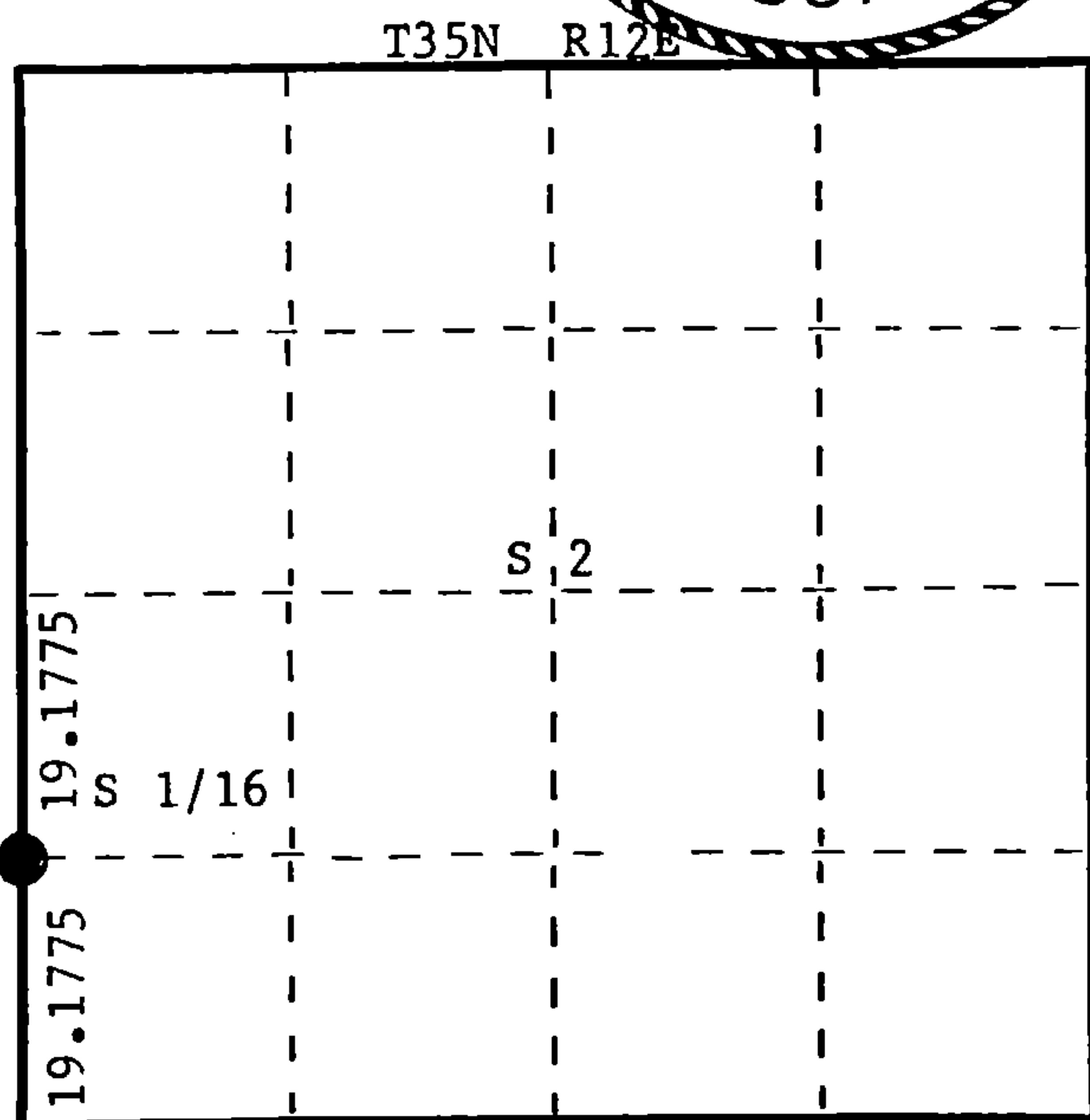

○ = Corner monument restored.

History of original corner establishment:

No records of any previous survey.

Description of corner evidence found:

No evidence of any corner recovered.

Corner established by proportional measurement, from previously established 1/4 corner and computed distance to section corner, Sec. 2, 3, 10 & 11 at bearing S 2° 31' 04" E. Set S 1/16 corner at 1265.71335 ft. (19.1775 chains) intermediate.

Description of monument and accessories I established to perpetuate the original location of this corner.

Set 1 1/2" iron pipe with 2" brass cap projecting 28" above ground. Cap stamped:

Marked NBTs - Sugar 9" S20°W, 65.15 links.

Sugar 7" N52°E, 52.88 links, scribed 1/16 BT.

S498

T35N R12E

S 1/16 3+2

CPI-1977

Dated at Rhinelander, Wis., this 17th day of October, 1977

Signature *Philip T. Hansen* Title Registered Land Surveyor Registration No. S-498
(County Surveyor, Registered Land Surveyor, or other duly authorized official)

Office of Register of Deeds, County of Forest, I hereby certify that the within instrument was filed in this office for record on the 20th day of October, 1977 at 4:20 o'clock P.M.

EUGENE STATEZNY
(Register of Deeds)

DOCUMENT NUMBER 112607

By *Eileen Schmidt* Deputy

43512031000