

U. S. PUBLIC LAND SURVEY MONUMENT RECORD

INSTRUCTIONS: This record shall show the location of the corner and shall include all of the following nine elements (a through i).

(a) Identify the corner by reference to the U.S. public land survey system.

○ = Corner monument restored.

Section corner to Sections 10, 11, 14, and 15, T.34N., R.16E.

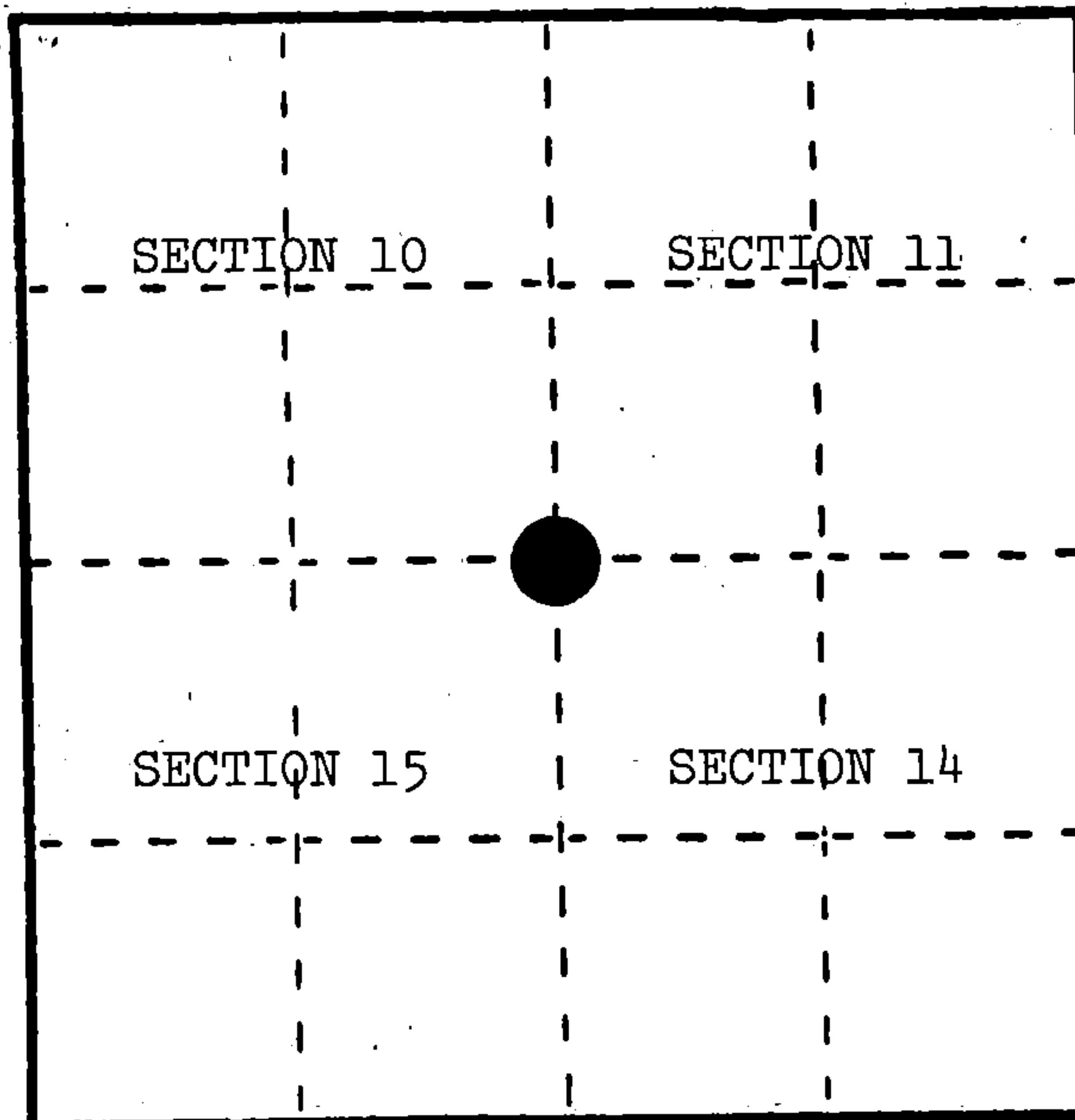

(b) Describe any record evidence, monument evidence, occupational evidence, testimonial evidence or any other material evidence you considered, and whether the monument was found or placed.

In 1858, James McBride set wood post with the following BTs: Tamarack, 14", N.20°W., 57 links; Tamarack, 12", N.29°E., 20 links; Black Ash, 12", S.44°E., 30 links; Birch, 16", S.11°W., 17 links.

January 11, 1935, C. J. Priegal--Truck Trail #344 found a fence line and Forest Service poster.

January, 1984, Milo Stefan, Bay Shore Farm Road runs north and south from section corner. Found no evidence of fence line or corner position.

(c) In the plan view drawing below, provide reference ties to at least 4 witness monuments, or, if the location is within a municipality, to at least 2 witness monuments. (Witness monuments shall be made of concrete, natural stone, iron or other equally durable material.) Describe witness monuments.

(d) Show a plan view drawing depicting the relevant monuments and reference ties which is sufficient in detail to enable accurate relocation of the corner monument if the corner monument is disturbed. Indicate north.

1. A 2" x 36" aluminum monument stamped to identify the corner.
2. Tamarack, 5", N.25°E., 88.68'
3. Aspen, 6", S.39°E., 68.32'
4. Tamarack, 14", S.38°W., 44.44'
5. White Spruce, 7", N.86°W., 36.73'
6. Steel Sign Post, Northwest, 0.7'

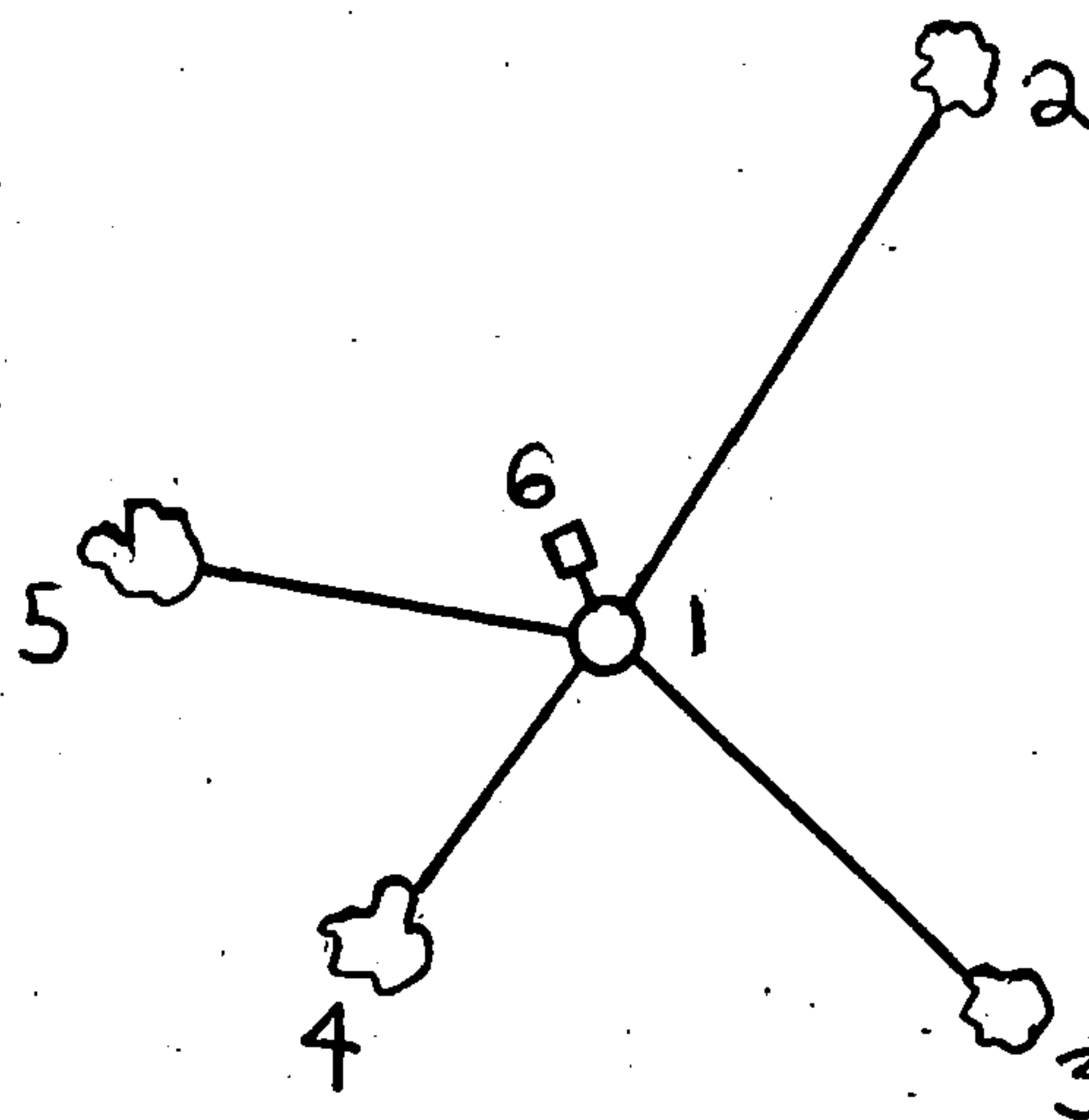

REGISTER'S OFFICE }
Forest County, Wis. }

Received for record this... 24th day
of... January A. D., 1985 at
..... 10:30 o'clock... A..... M. and

recorded in Vol. CORNER RESTORATIONS

on page J-17...
Paul A. Schumacher
REGISTER

(e) Describe any material discrepancy between the location of the corner as restored or reestablished and the location of that corner as previously restored or reestablished by distance and direction. Show the discrepancy on the plan view drawing under (d), above. Show the distances between the corner as previously restored or reestablished and (1) the corner as restored or reestablished, and (2) to at least 2 of the witness monuments shown on the drawing in (d), above.

None.

(f) Was the corner restored through acceptance of (1) an obliterated evidence location, or, (2) a found perpetuated location?

No.

(g&h) Was the corner reestablished through lost corner proportionate methods? If so, show the method, including the directions and distances to other public land survey corners used as evidence or used for proportioning in determining the corner location?

Yes.

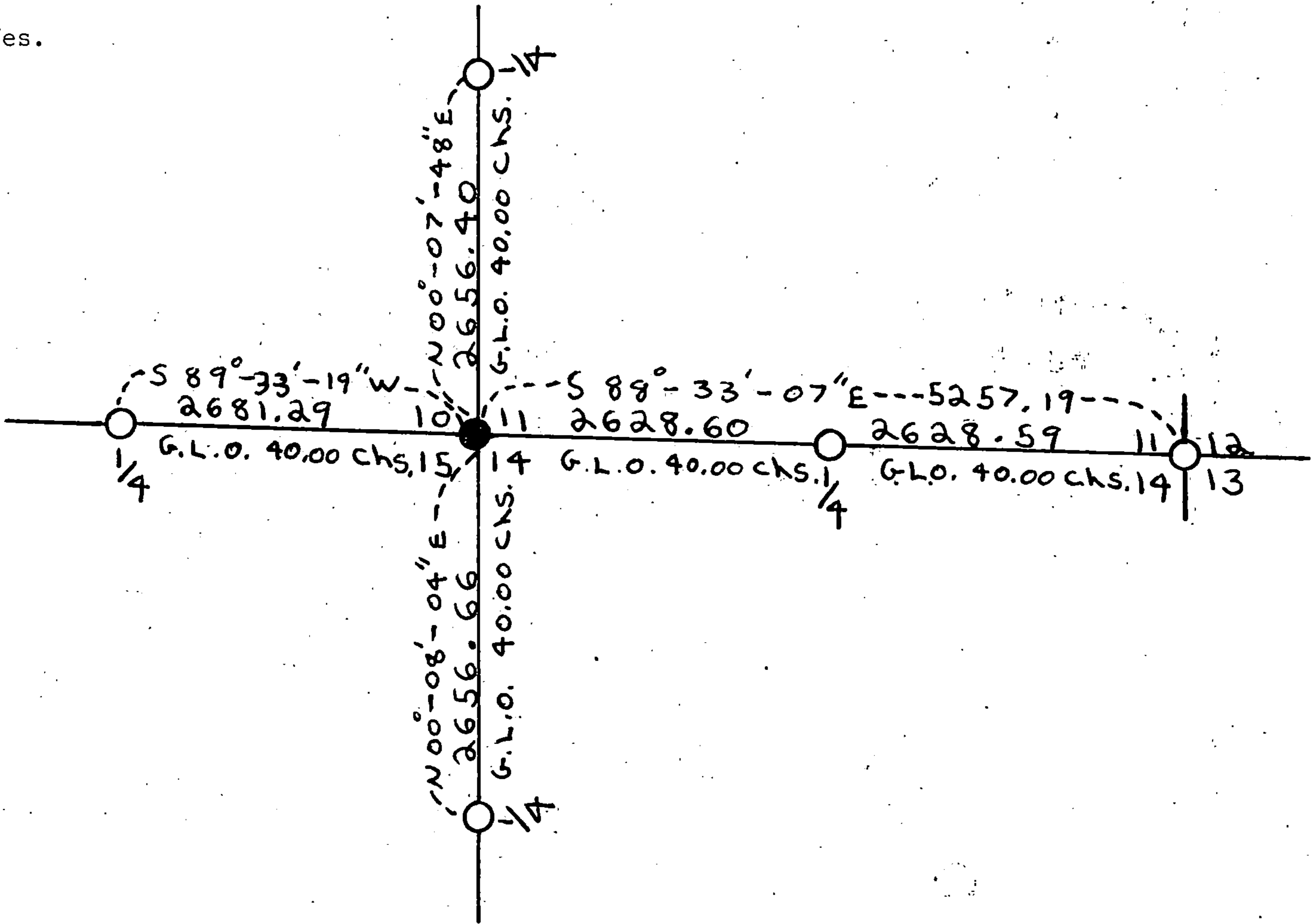

Affix Land Surveyor Seal



(1) I, Milo E. Stefan
(type or print name) certify that the corner location shown on this record was determined by me or under my direction and control and that this U.S. Public Land Survey Monument Record is correct and complete to the best of my knowledge and belief.

Milo E. Stefan
Signature

11/30/84
Date

U. S. PUBLIC LAND SURVEY MONUMENT RECORD

INSTRUCTIONS: This record shall show the location of the corner and shall include all of the following nine elements (a through i).

- (a) Identify the corner by reference to the U.S. public land survey system.
- = Corner monument restored.

Section Corner to Sections 10, 11, 14 & 15;
T.34N., R.16E., 4th P.M.

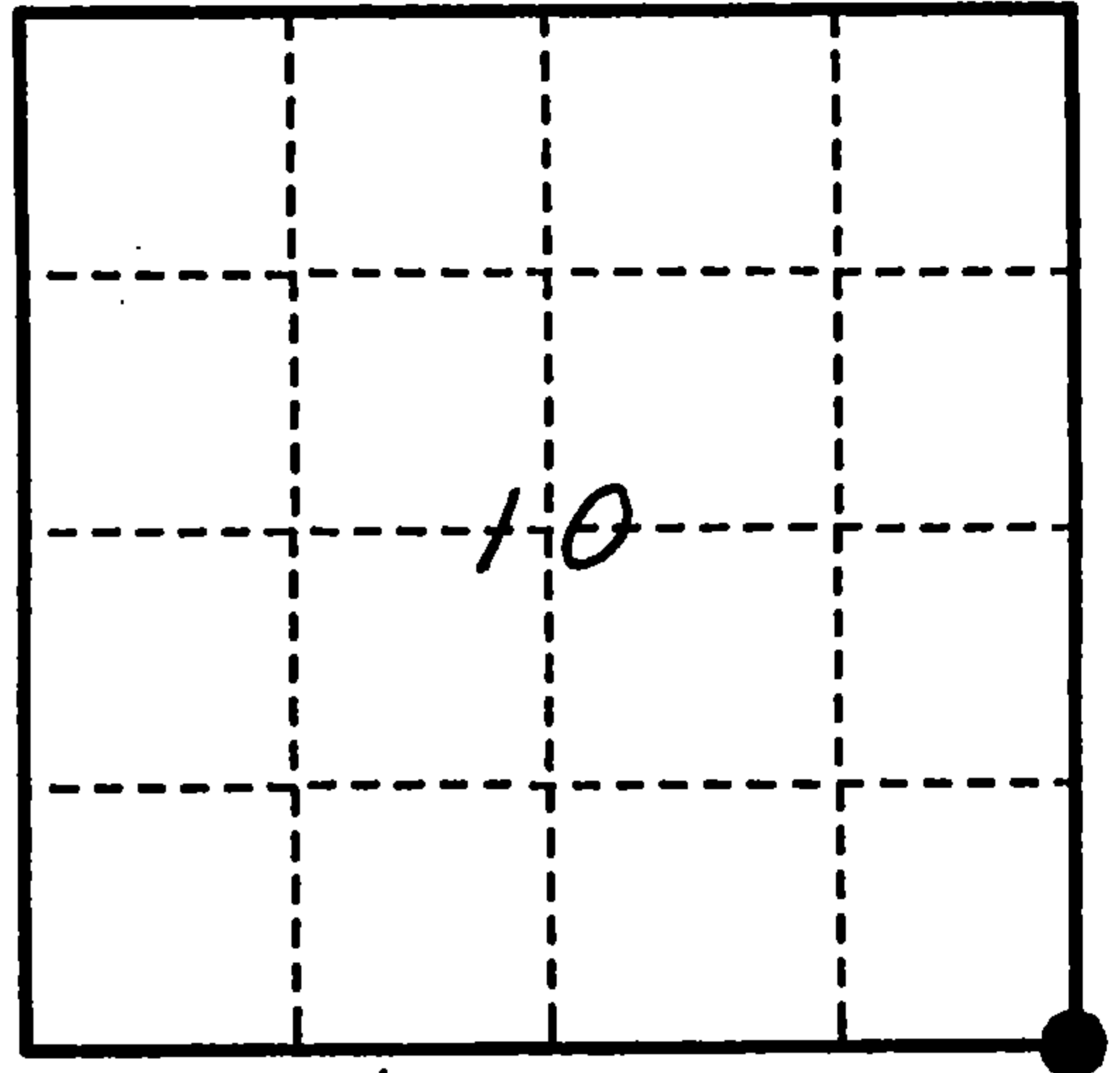

- (b) Describe any record evidence, monument evidence, occupational evidence, testimonial evidence or any other material evidence you considered, and whether the monument was found or placed.

Found aluminum monument, sign post and two BTs in good condition. Aspen and 5" Tamarack dead and down. This corner was restored by myself in 1983.

We made two new BTs:
Black Spruce, 6", S.15°E., 123.04'
White Pine, 6", S.3°W., 139.59'

- (c) In the plan view drawing below, provide reference ties to at least 4 witness monuments, or, if the location is within a municipality, to at least 2 witness monuments. (witness monuments shall be made of concrete, natural stone, iron or other equally durable material.)

- (d) Show a plan view drawing depicting the relevant monuments and reference ties which is sufficient in detail to enable accurate relocation of the corner monument if the corner monument is disturbed. Indicate north.

1. 2" Aluminum monument.
2. Black Spruce, 6", S.15°E., 123.04'.
3. White Pine, 6", S.3°W., 139.59'.
4. Tamarack, 14", S.38°W., 44.44'.
5. White Spruce, 7", N.86°W., 36.73'.
6. Steel sign post, Northwest, .70'.

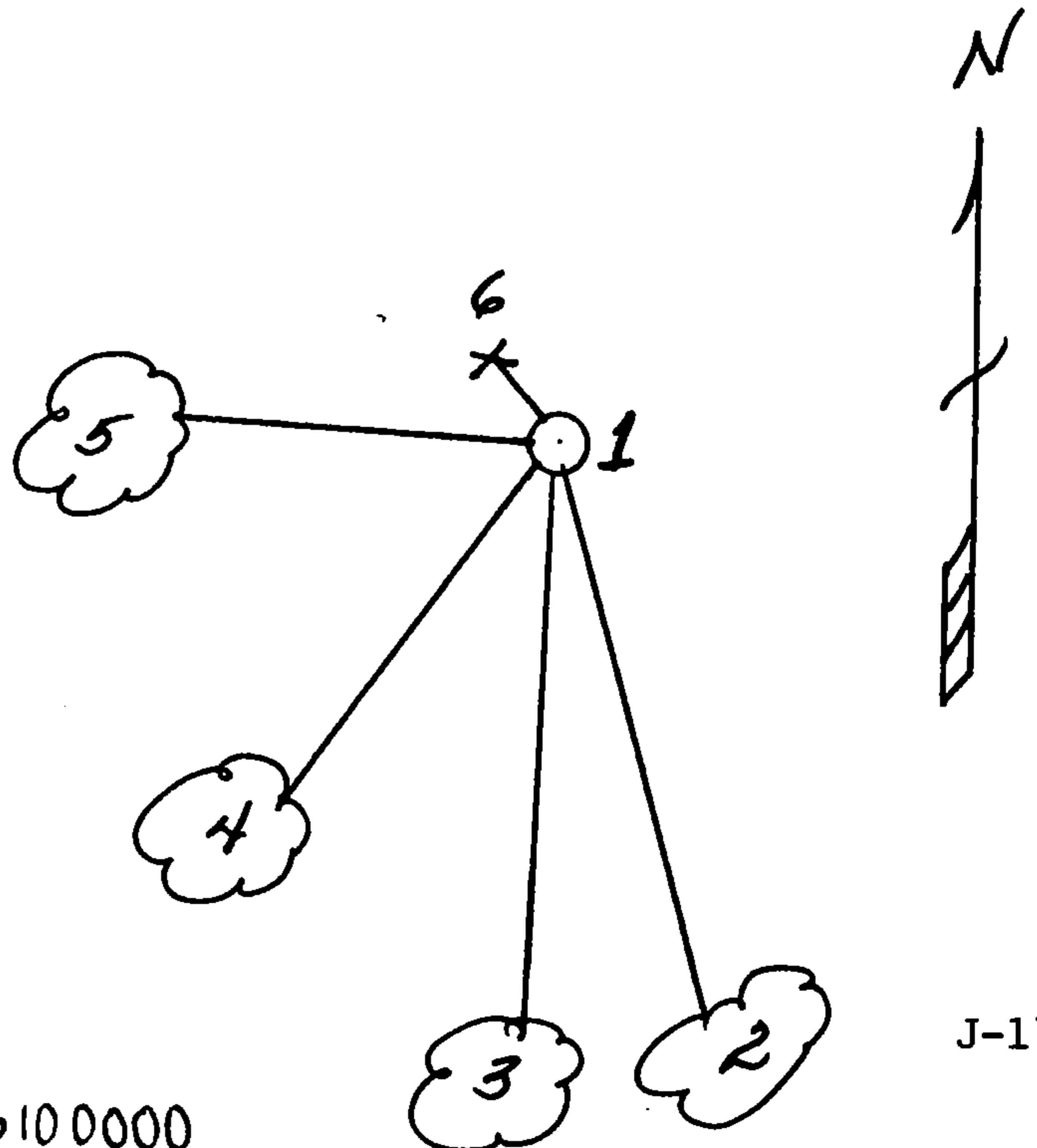

REGISTER'S OFFICE
Forest County, Wis.
Received for record this 9th day
of March, A.D., 1993 at
9:15 o'clock A.M. and recorded
in Vol. 34-16 Corner Restorations
page J-17
Chad Chitko, Deputy
Register of Deeds

(e) Describe any material discrepancy between the location of the corner as restored or reestablished and the location of that corner as previously restored or reestablished by distance and direction. Show the discrepancy on the plan view drawing under (d), above. Show the distances between the corner as previously restored or reestablished and (1) the corner as restored or reestablished, and (2) to at least 2 of the witness monuments shown on the drawing in (d), above.

N/A

(f) Was the corner restored through acceptance of (1) an obliterated evidence location, or, (2) a found perpetuated location?

(2)

(g & h) Was the corner reestablished through lost corner proportionate methods? If so, show the method, including the directions and distances to other public land survey corners used as evidence or used for proportioning in determining the corner location?

N/A

(1) I, Milo E. Stefan

(type or print name) certify that the corner location shown on this record was determined by me or under my direction and control and that this U.S. Public Land Survey Monument Record is correct and complete to the best of my knowledge and belief.

Milo E. Stefan
Signature

November 20, 1992

Date

CERTIFICATE READY FOR FILING:

Dale R. Covey
Acting District Ranger

