

CERTIFIED LAND CORNER RESTORATION

Index No. **G 6**

State of Wisconsin }
County of Forest } ss.

History of original corner establishment:

Original corners set by Railroad surveyors
Said corner used by N. H. Smith, in the staking
of Schroeder Plat of June 1905.

I Paul N. Smith, do hereby
certify that on the 30th day
of April, 1976, I found
evidence of the 1/8 cor. East of West 1/4
~~corner on East & West 1/4 line in~~ Section 8,
Township 34, North, Range
15 East, Fourth Principal Meridian,
as described hereon; and that from this evidence
I established a new monument and accessories
as described hereon to perpetuate the original
location of this corner.

Description of corner evidence found:

Found original ties and original rods as set in staking of the
Schroeder Plat. Wood stake called for in original notes bulldozed
out in building of Light Street.

Resident witnesses:

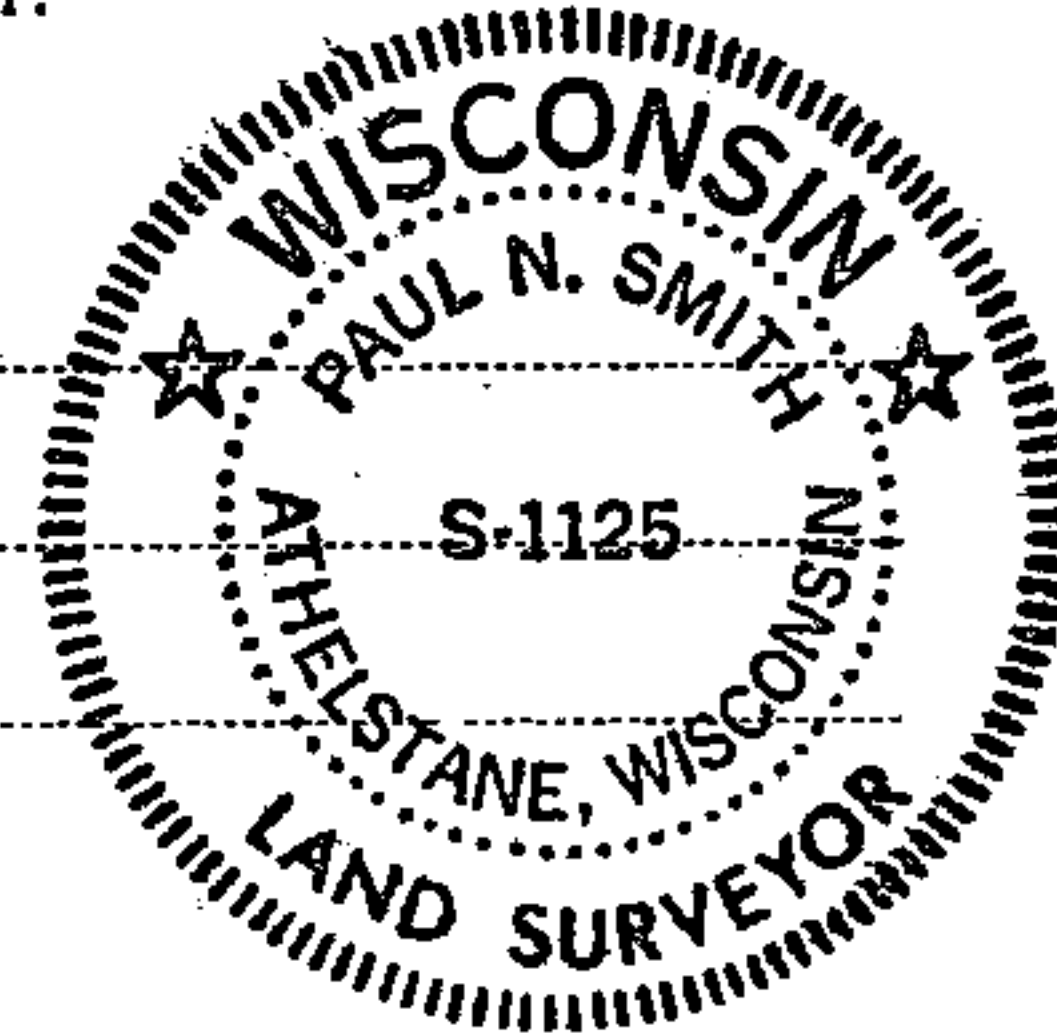

Description of monument and accessories I established to perpetuate the original location of this corner.

Standard Forest County monument 2 inches below blacktop surface of
road.

Iron rod - South 77°30'20" East 19.57 feet
Iron rod - South 43°05'20" West 25.51 feet
All Bearings magnetic and under power line

FORM 985 H. C. MILLER CO., MILWAUKEE

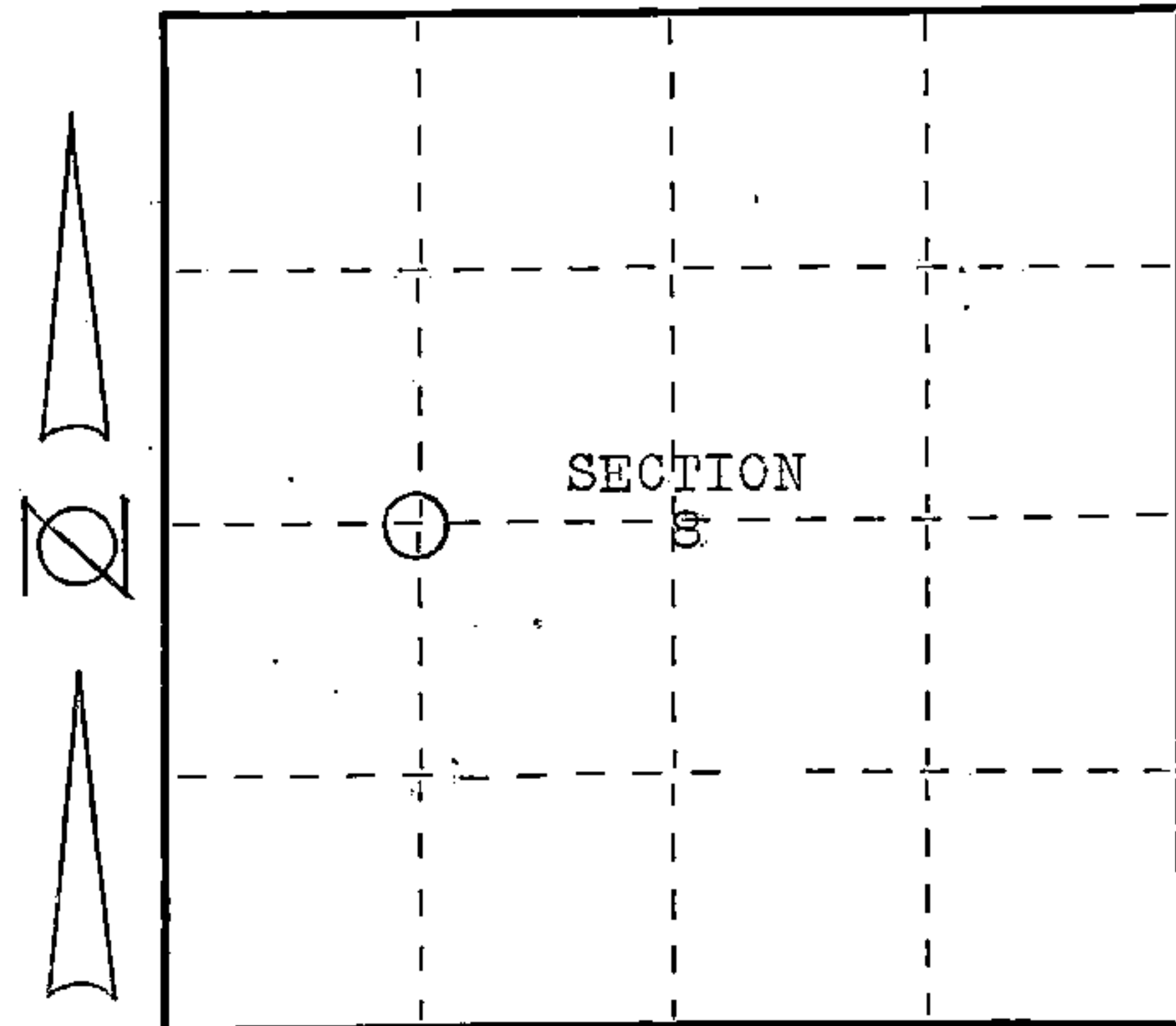

○ = Corner monument restored.

Dated at Athelstane, Wis., this 30th day of April, 1976.

Signature Paul N. Smith Title Land Surveyor Registration No. S-1125
(County Surveyor, Registered Land Surveyor, or other duly authorized official)

Office of Register of Deeds, County of Forest, I hereby certify that the within
instrument was filed in this office for record on the 23rd day of July, 1976
at 4:15 o'clock P. M.

Eugene Stutzman
(Register of Deeds)

By _____ Deputy

DOCUMENT NUMBER
109761

43415082030