

CERTIFIED LAND CORNER RESTORATION

State of Wisconsin }  
County of Forest } ss.

I Paul N. Smith, do hereby certify that on the 30th day of April, 1976, I found evidence of the West 1/4 corner of Section 8 Township 34 North, Range 15 East, Fourth Principal Meridian, as described hereon; and that from this evidence I established a new monument and accessories as described hereon to perpetuate the original location of this corner.

Resident witnesses:

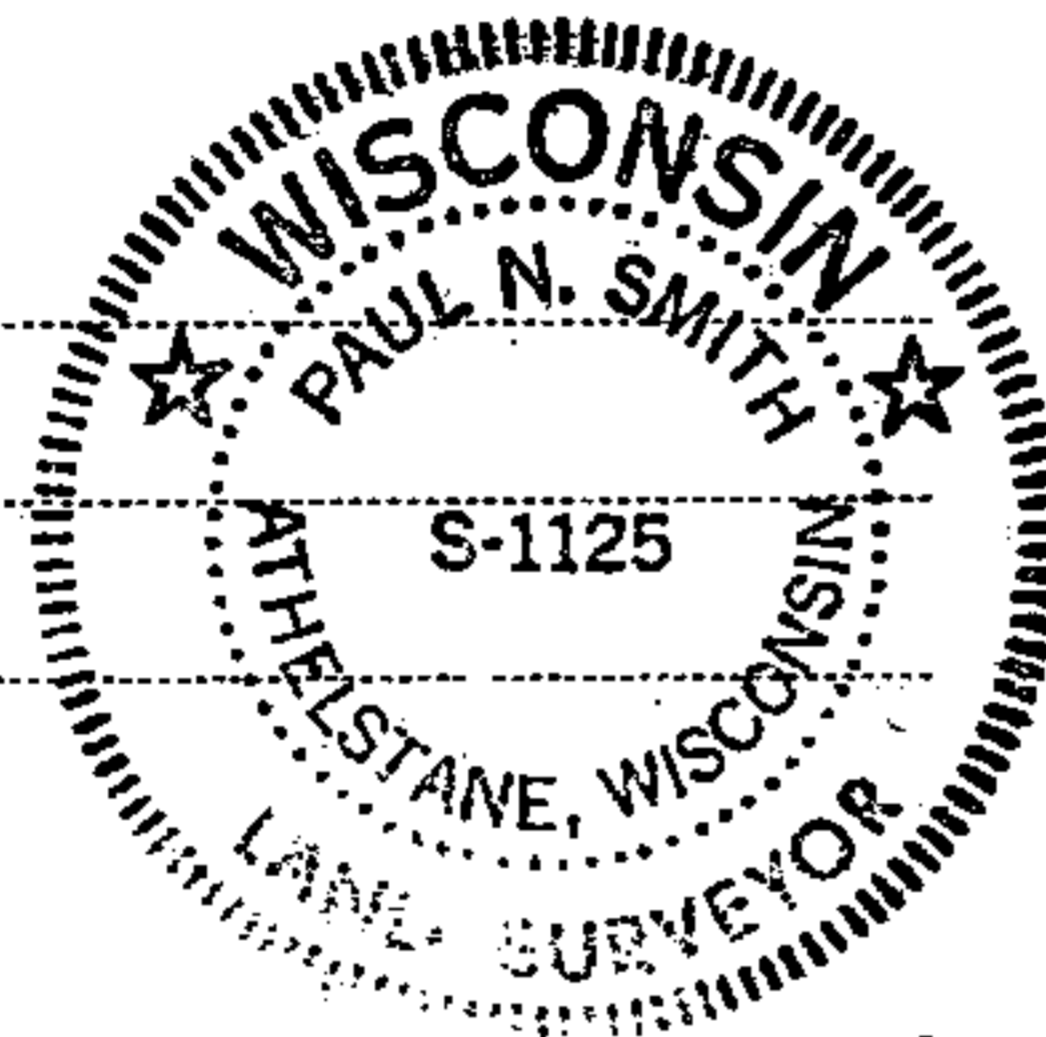

FORM 985 H. C. MILLER CO., MILWAUKEE

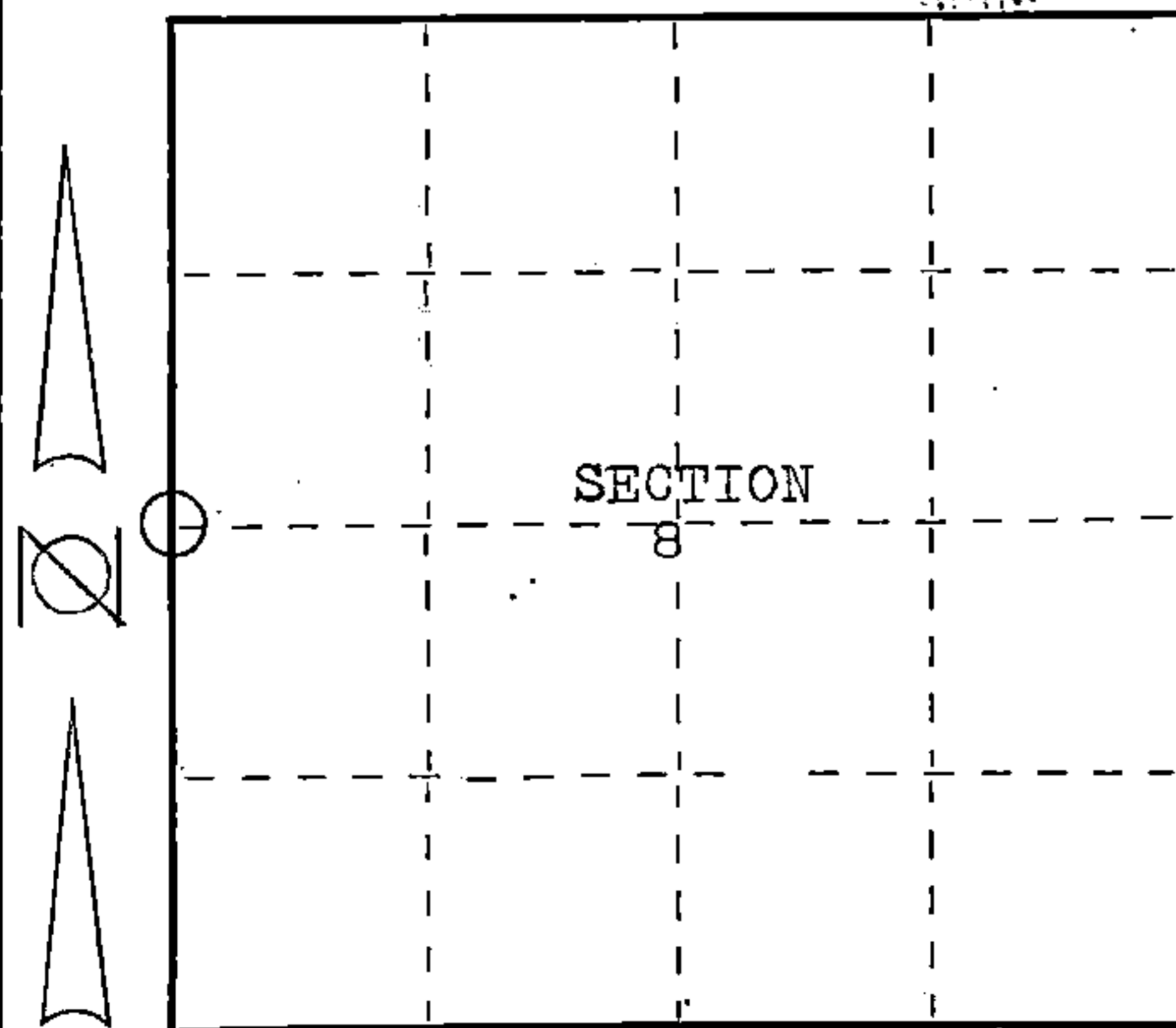

○ = Corner monument restored.

History of original corner establishment:

Subdivision by James McBride, 1859  
Original Bearing trees:  
Elm - 10 inches South 41° East - 17 links  
Ironwood - 6 inches North 36° West - 24 links  
Original Bearing trees removed in building of Town Road

Description of corner evidence found:

Two inch iron pipe set by Public Service Survey for gas line. Said two inch iron pipe checks with plat corners on original Wabeno Plats.

Description of monument and accessories I established to perpetuate the original location of this corner.

Forest County standard monument 4 ft. aluminum pipe with aluminum cap

Elm - South 37°41'40" West 48.61 feet  
Elm - South 68°23'40" East 45.80 feet  
White Pine - North 29°48'40" East 35.86 feet

Dated at Athelstane, Wis., this 30th day of April, 1976.

Signature Paul N. Smith Title Land Surveyor Registration No. S-1125  
(County Surveyor, Registered Land Surveyor, or other duly authorized official)

Office of Register of Deeds, County of Forest, I hereby certify that the within instrument was filed in this office for record on the 23rd day of July, 1976 at 4:15 o'clock P.M.

Eugene Stetson  
(Register of Deeds)

DOCUMENT NUMBER 109762

By Deputy

43415072000