

CERTIFIED LAND CORNER RESTORATION

State of Wisconsin }
County of Forest } ss.

I, Jean F. Resvick, do hereby certify that on the 1 day of June, 1976, I found evidence of the South Quarter corner of Section 34 Township 34 North, Range 14 East, Fourth Principal Meridian, as described hereon; and that from this evidence I established a new monument and accessories as described hereon to perpetuate the original location of this corner:

Description of original monument and accessories and subsequent restorations:

Surveyed in 1857 by Alfred Millard
40.00 chains west between sections 3 & 34
Set Quarter Section Post
Y. Birch 24", N52°W, 64 links
Y. Birch 20", S30°E, 45 links

Description of corner evidence found:

4" x 4" wood post, scribed, from which evidence of original bearing trees were located. Large yellow birch stump and root remain N52°W, 64 links. Large yellow birch stump and root remains S30°E, 45 links.

Description of monument and accessories I established to perpetuate the location of this corner:

Replaced wood post with a 2 inch inside diameter, galvanized iron pipe, 3 feet long, filled with concrete, with brass cap stamped: T34N & T33N, R14E, 1/4, S3, S34, 1976, S-802.

Blazed and scribed the following new bearing trees:

Sugar maple, 15", S83°E, 30.25 feet
Basswood, 10", N54°W, 22.28 feet
Set a steel sign post north of the monument, 0.50 feet.

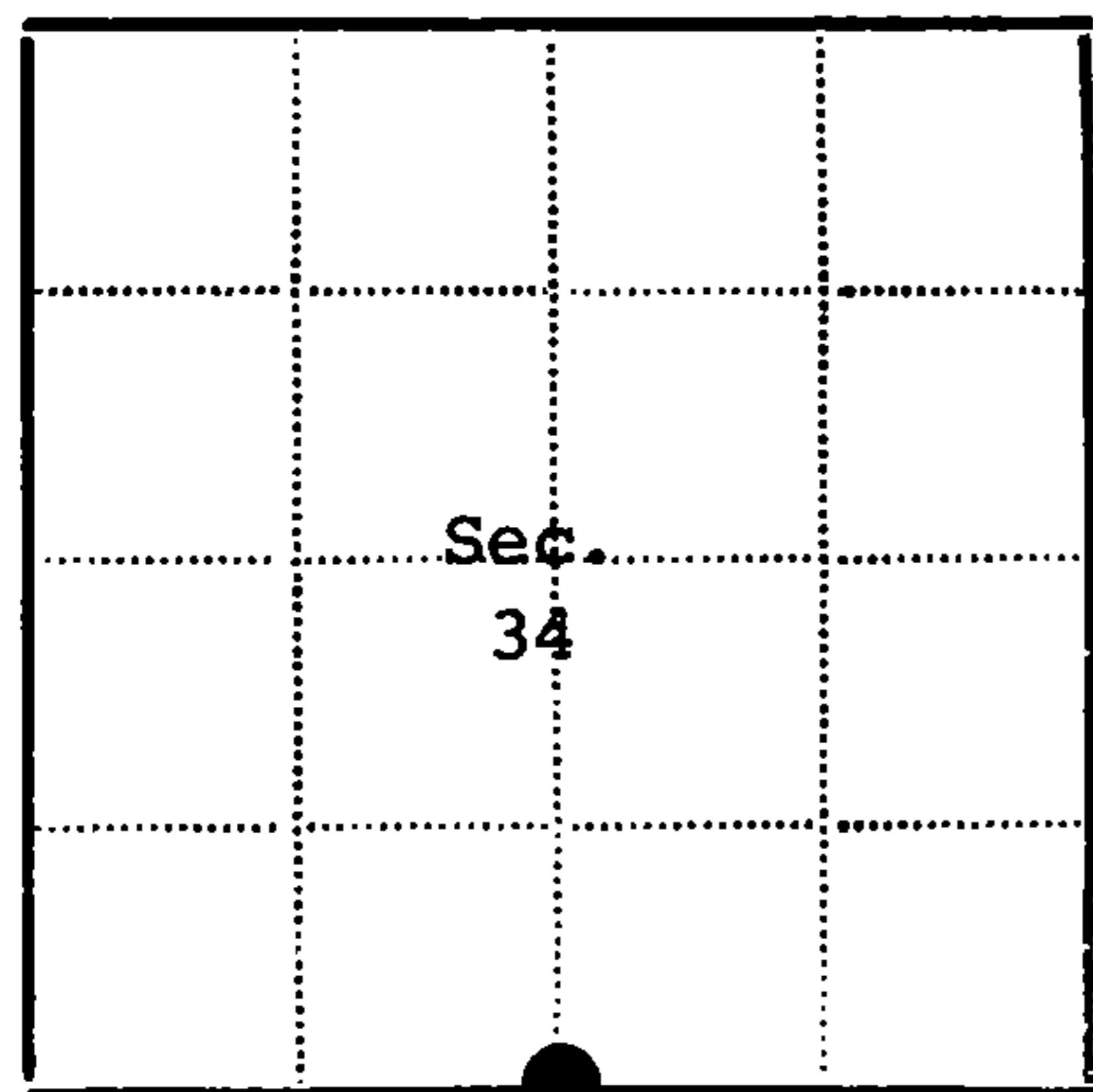

● - Corner monument restored
□ -

Resident witnesses.....

Dated at Rhinelander Wisconsin, this 1 day of April 1977.

Signature *Jean F. Resvick* Title Land Surveyor
(County Surveyor, Registered Land Surveyor, or other duly authorized official)

Surveyors Registration No. S-802

DOCUMENT NUMBER - 111428

Office of Register of Deeds County of Forest

I hereby certify that the within instrument was filed in this office for record on the 13th day of May 1977, and was filed in Book No. Page No. of County Records.

Signature *Eugene Stutz* Title Register of Deeds

Township 34 North, Range 14 East, Section 34, Index No. Z-15, Page No.

U. S. PUBLIC LAND SURVEY MONUMENT RECORD

INSTRUCTIONS:

This record shall show the location of the corner and shall include all of the following nine elements (a through i).

- (a) Identify the corner by reference to the U.S. public land survey system.
○ = Corner monument restored.

Quarter Corner to Sections 3 and 34,
T.33-34N., R.14E., Langlade and
Forest Counties, WI.

State Plane Coordinates
Wisconsin North Zone
79863.56878-N
2294981.34714-E

Geographic Coordinates
45-22-42.67918-N
088-43-46.25053-W

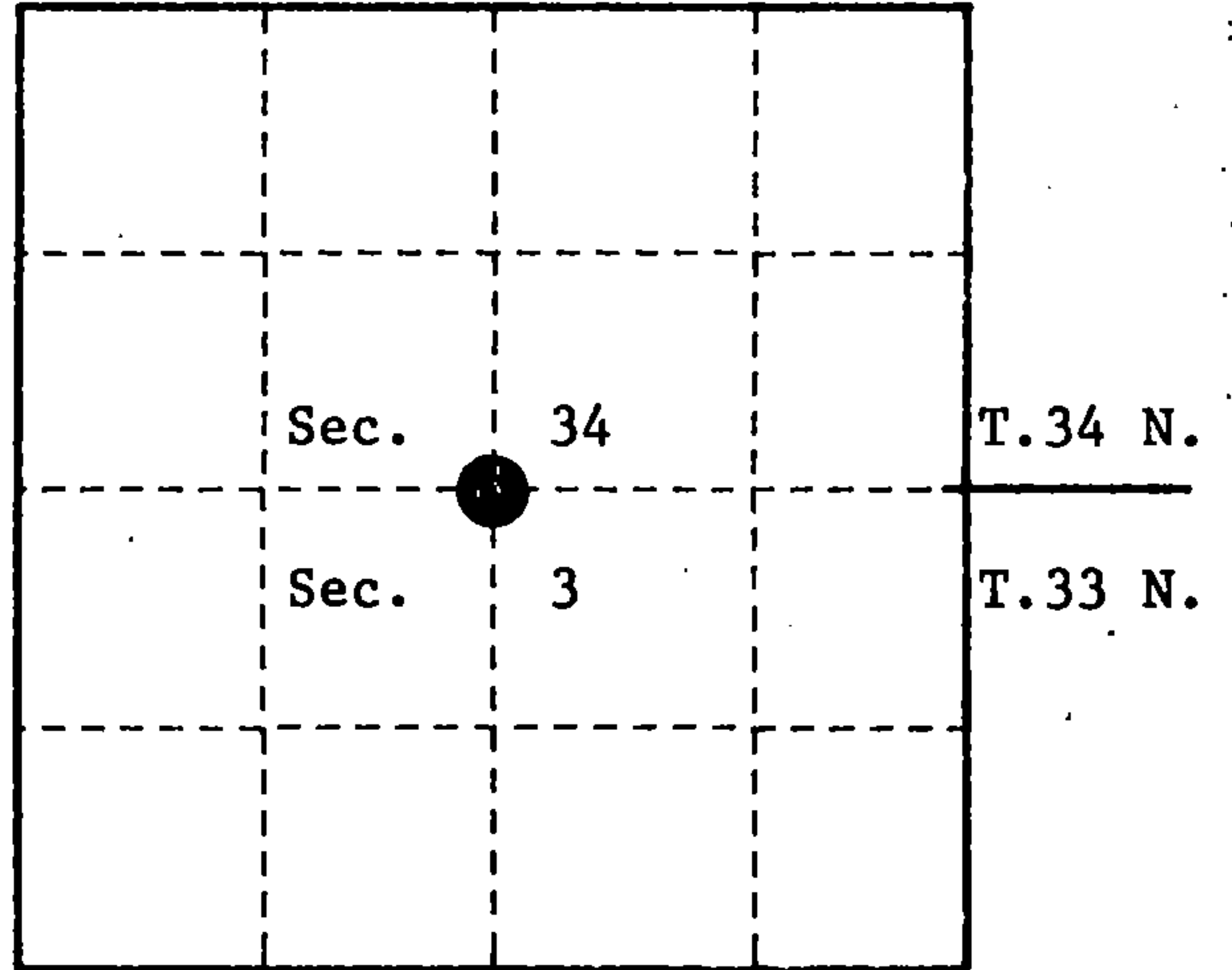

- (b) Describe any record evidence, monument evidence, occupational evidence, testimonial evidence or any other material evidence you considered, and whether the monument was found or placed.

Original survey in 1857 by Alfred Millard, set wood post and the following bearing trees; Yellow Birch, 24", N.52°W., 64 links, Yellow Birch, 20", S.30°E., 45 links.

In 1976, Jean Resvick, R.L.S., found a scribed 4" x 4" wood post and stump remains from both original bearing trees. Replaced wood post with a 2" x 36" galvanized iron pipe with a brass cap stamped to identify corner. Blazed and scribed new bearing trees; Sugar, 15", S.83°E., 30.25 feet, Basswood, 10", N.54°W., 22.28 feet, Steel Sign Post, North, 0.50 feet.

On October 22 1993, Alan Harrison, R.L.S., found monument and bearing trees as set by Resvick in 1976. Blazed and scribed 1 new bearing tree; Sugar, 9", S.57°W., 25.36 feet.

- (c) In the plan view drawing below, provide reference ties to at least 4 witness monuments, or, if the location is within a municipality, to at least 2 witness monuments. (witness monuments shall be made of concrete, natural stone, iron or other equally durable material.)

- (d) Show a plan view drawing depicting the relevant monuments and reference ties which is sufficient in detail to enable accurate relocation of the corner monument if the corner monument is disturbed. Indicate north.

1. 2" x 36" galvanized iron pipe with brass cap stamped to identify corner.
2. Sugar, 15", S.83°E., 30.25 feet.
3. Sugar, 9", S.57°W., 25.36 feet.
4. Basswood, 10", N.54°W., 22.28 feet.
5. Steel Sign Post, North, 0.50 feet.

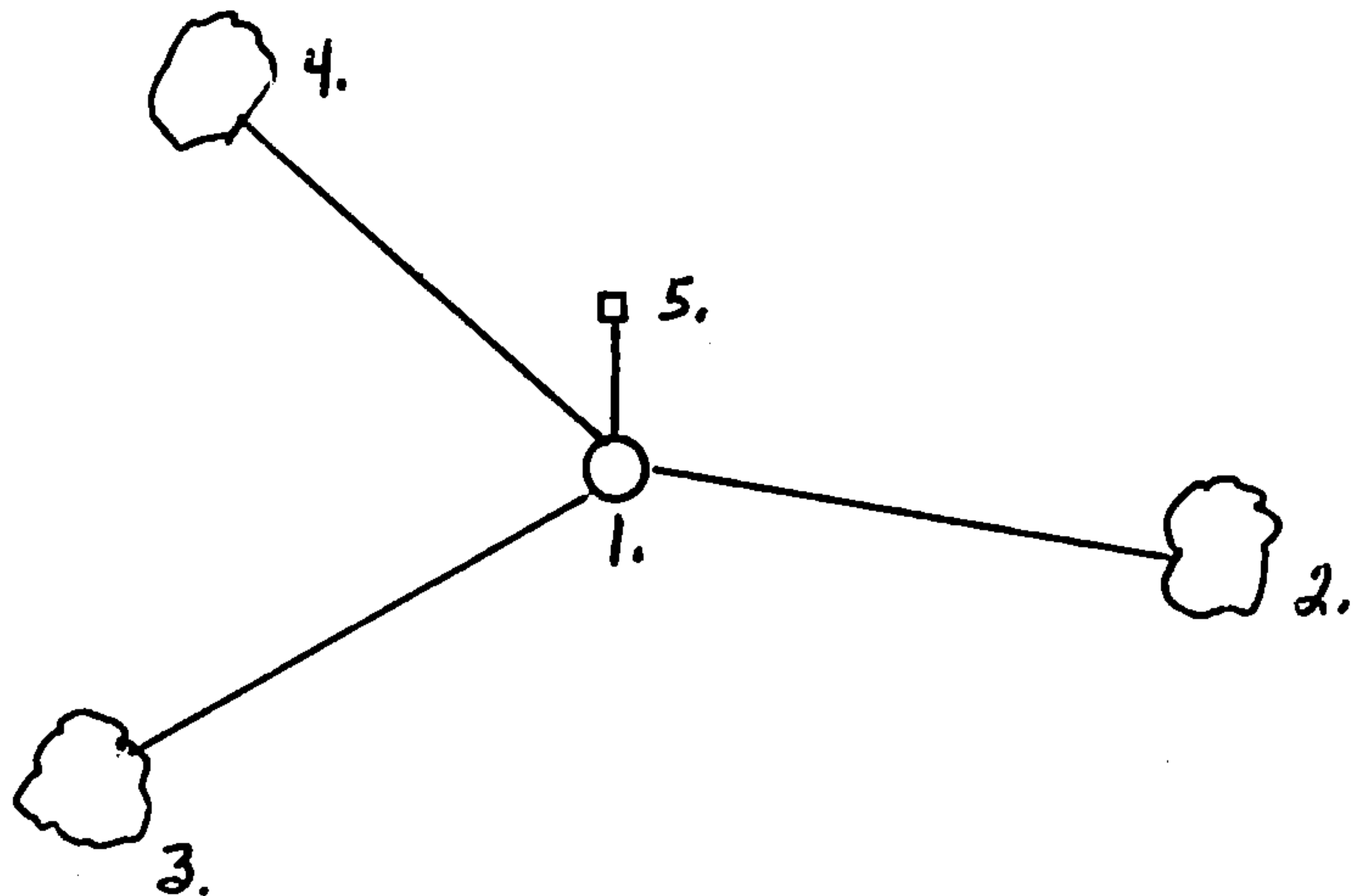

(e) Describe any material discrepancy between the location of the corner as restored or reestablished and the location of that corner as previously restored or reestablished by distance and direction. Show the discrepancy on the plan view drawing under (d), above. Show the distances between the corner as previously restored or reestablished and (1) the corner as restored or reestablished, and (2) to at least 2 of the witness monuments shown on the drawing in (d), above.

None

(f) Was the corner restored through acceptance of (1) an obliterated evidence location, or, (2) a found perpetuated location?

(2)

(g & h) Was the corner reestablished through lost corner proportionate methods? If so, show the method, including the directions and distances to other public land survey corners used as evidence or used for proportioning in determining the corner location?

No

REGISTER'S OFFICE
Forest County, Wis.
Received for record this 23rd day
of November, A.D., 1994 at
9:00 o'clock A.M. and recorded
in Vol. Case Restoration
page 34-14, A-15
Leah C. Little, Deputy
Register of Deeds

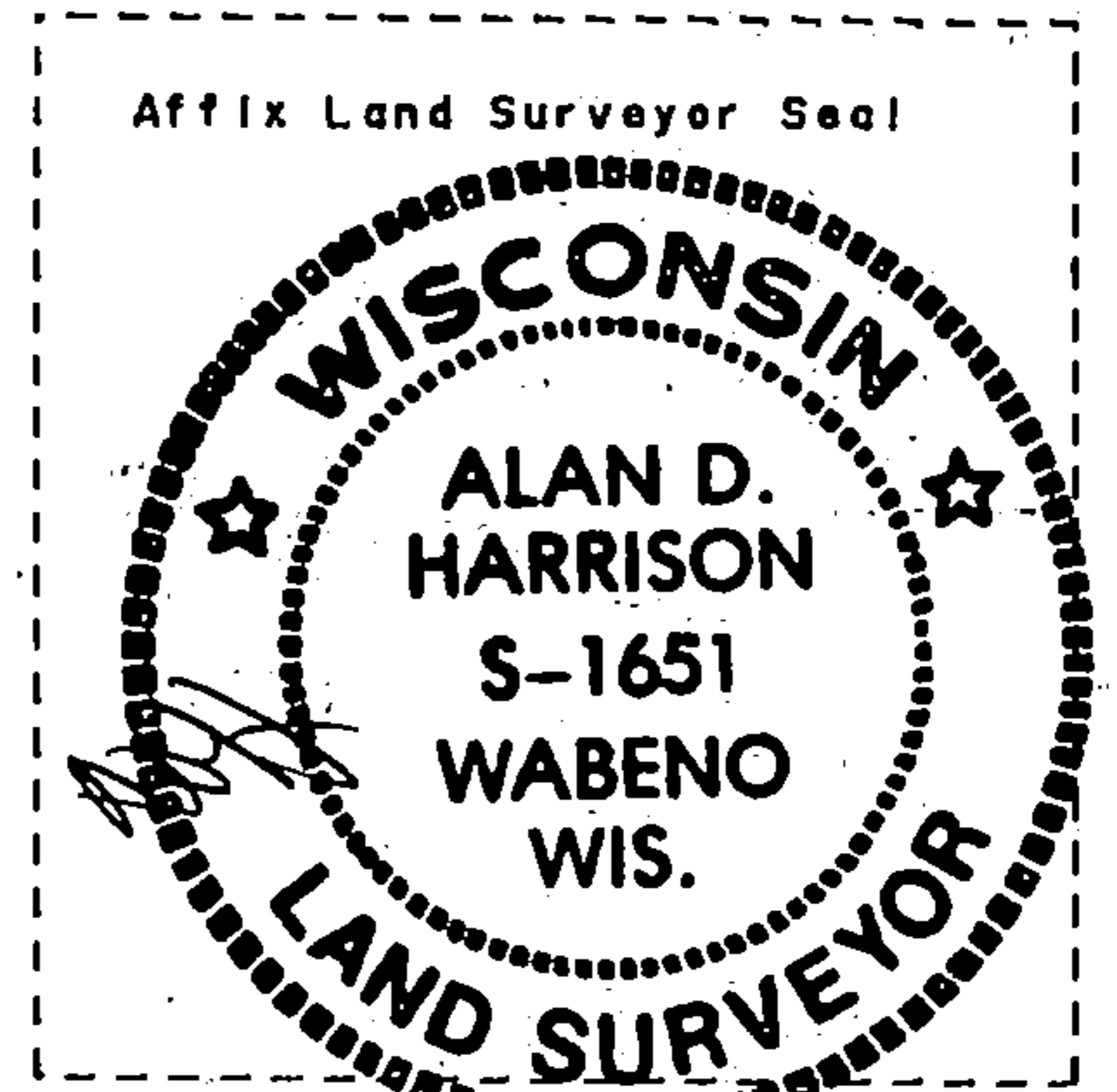

(1) I, Alan D. Harrison

(type or print name) certify that the corner location shown on this record was determined by me or under my direction and control and that this U.S. Public Land Survey Monument Record is correct and complete to the best of my knowledge and belief.

Alan D. Harrison 10/26/94
Signature Date

CERTIFICATE READY FOR FILING: Sue Vap
District Ranger

225167

U.S. PUBLIC LAND SURVEY MONUMENT RECORD

Note: This form is intended and designed to fulfill all requirements of Wisconsin Administrative Code, Chapter A-E 7.08 U.S. Public Land Survey Monument Record (3)(a-l).

(a) CORNER LOCATION
1/4 Cor. of Secs. 3 & 34
Township 33 & 34 North
Range 14 East of the 4th P.M.
Town of Wolf River/Freedom
County of Langlade/Forest

WISCRS - Langlade County
N: 427,336.75 USft
E: 729,079.09 USft
WISCRS - Forest County
N: 500,611.64 USft
E: 880,282.36 USft
Datum: NAD 83(2011)
GNSS Method: WISCORS STATIC

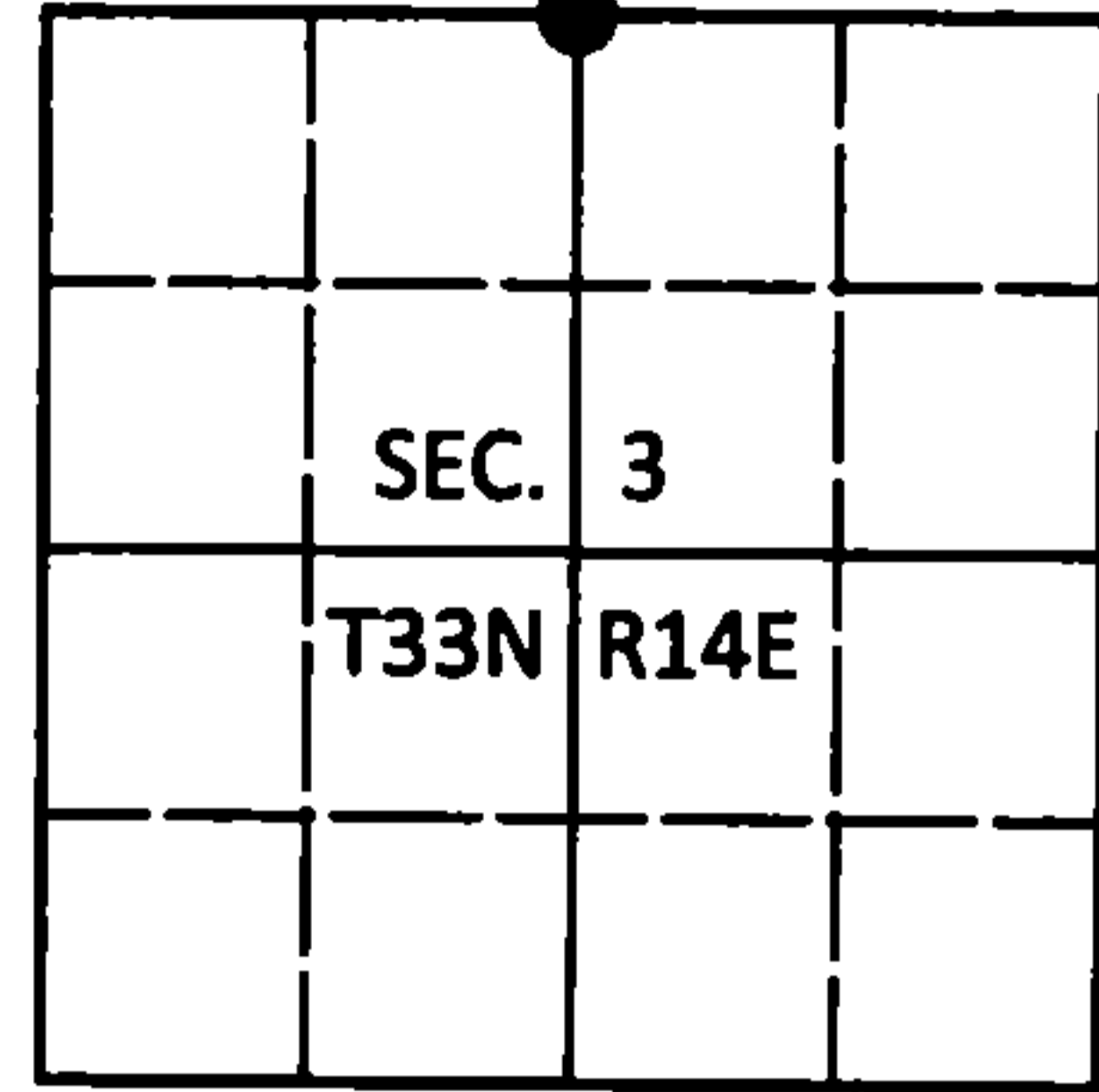

(b) HISTORY OF ORIGINAL CORNER ESTABLISHMENT

Original Surveyor: Alfred Millard

Original Accessories:

Date of Survey Commenced: August, 1857
Completed: August, 1857

Y. Birch 24" N52°W, 64 lks.
Y. Birch 20" S30°E, 45 lks.

(b)(f)(g)(h) Description of monument found at this corner and if it was accepted, state all evidence (material, testimonial, occupational, plats, records, other monuments) used as a basis for accepting. If not accepted or if nothing was found, state evidence used as basis for establishing location. If re-established through lost corner proportionate methods, indicate all monuments, distances and directions used to establish. Indicate type of monument and sign post found or set.

This is a perpetuation of a previous USPLS Monument Record by William F. Kelly, RLS dated December 27, 1987 and filed in the office of the Langlade County Surveyor. A complete history of the corner can be found on the previous monument record. I accept the previous location as a true and faithful perpetuation or reestablishment of the original corner location and further perpetuate it as follows.

This is a perpetuation of a previous USPLS Monument Record by Alan D. Harrison, RLS dated October 26, 1994 and filed in the office of the Langlade County Surveyor. A complete history of the corner can be found on the previous monument record. I accept the previous location as a true and faithful perpetuation or reestablishment of the original corner location and further perpetuate it as follows.

November 4, 2016: I found and accepted the record monument, a 2-1/2" diam. iron pipe with a 3" diam. brass cap projecting 3" above the ground surface. The record bearing tree at N45°E is now a stump, the tree at S77°W is gone. I found or established accessories as shown below. A USFS steel sign post bears North, 0.5 ft. I set a white vinyl sign post bearing Southwest, 1.2 ft.

(c)(d)(e) Plan view of corner with ties to at least 4 witness monuments. If in disagreement with previously established corner, show the distances between the two corners and also indicate the ties to the disputed.

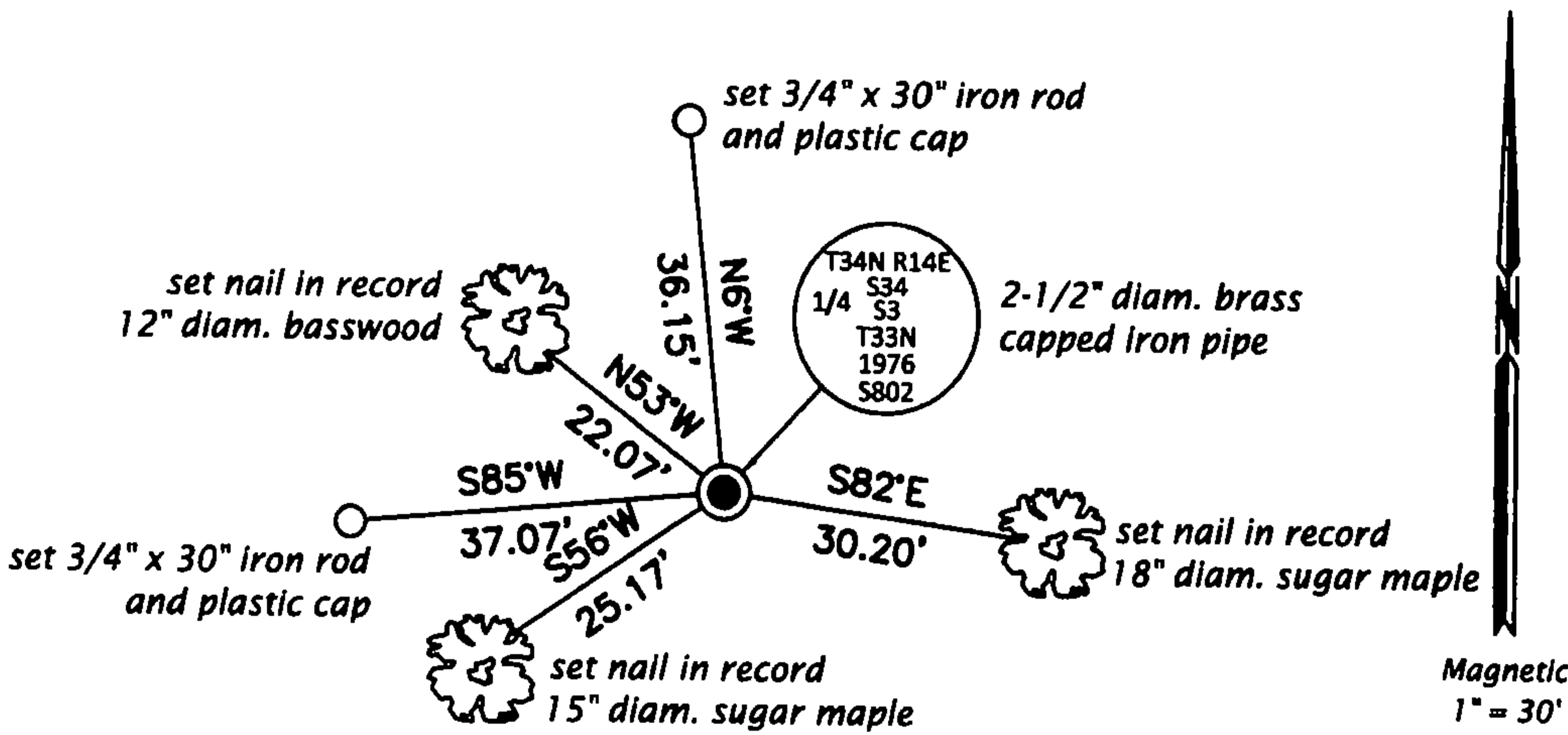

FOREST COUNTY, WI
CORTNEY BRITTEN CLEEREMAN
REGISTER OF DEEDS
RECEIVED FOR RECORD

APR 27 2018

Time: 10:00 A.M.
Vol.: Corner Restoration
Page Number: 2-15

(i) I, Jeffrey W. Austin, Professional Land Surveyor No. S-1885, hereby certify that the corner location on this record was determined by me or under my direction and control and that this U.S. Public Land Survey Monument Record is correct and complete to the best of my knowledge and belief.



Handwritten signature of Jeffrey W. Austin.

MAY 4, 2017
Date

3414340020 (INDEX NO. A-15)

43414 34 0020