

CERTIFIED LAND CORNER RESTORATION

Index No. **Y-18**

State of Wisconsin }
County of Forest } ss.

History of original corner establishment:
No evidence of any previous corner.

I Glen Barker, do hereby
certify that on the 12th day
of December, 19 82, I ~~found~~ estab.
~~evidence of the~~ SW 1/16
corner of Section 35
Township 34, North, Range
13 East, Fourth Principal Meridian,
as described hereon; and that from this evidence
I established a new monument and accessories
as described hereon to perpetuate the original
location of this corner.

Description of corner evidence found:
Corner established by subdivision of the SW 1/4.
Location of SW 1/16 is 1315.50 ft of SC 1/16 and 1382.86 ft of W 1/16 between sections
2 & 35 T33 & 34N R13E.

Resident witnesses:

J. Claflin -

H. Wagoner

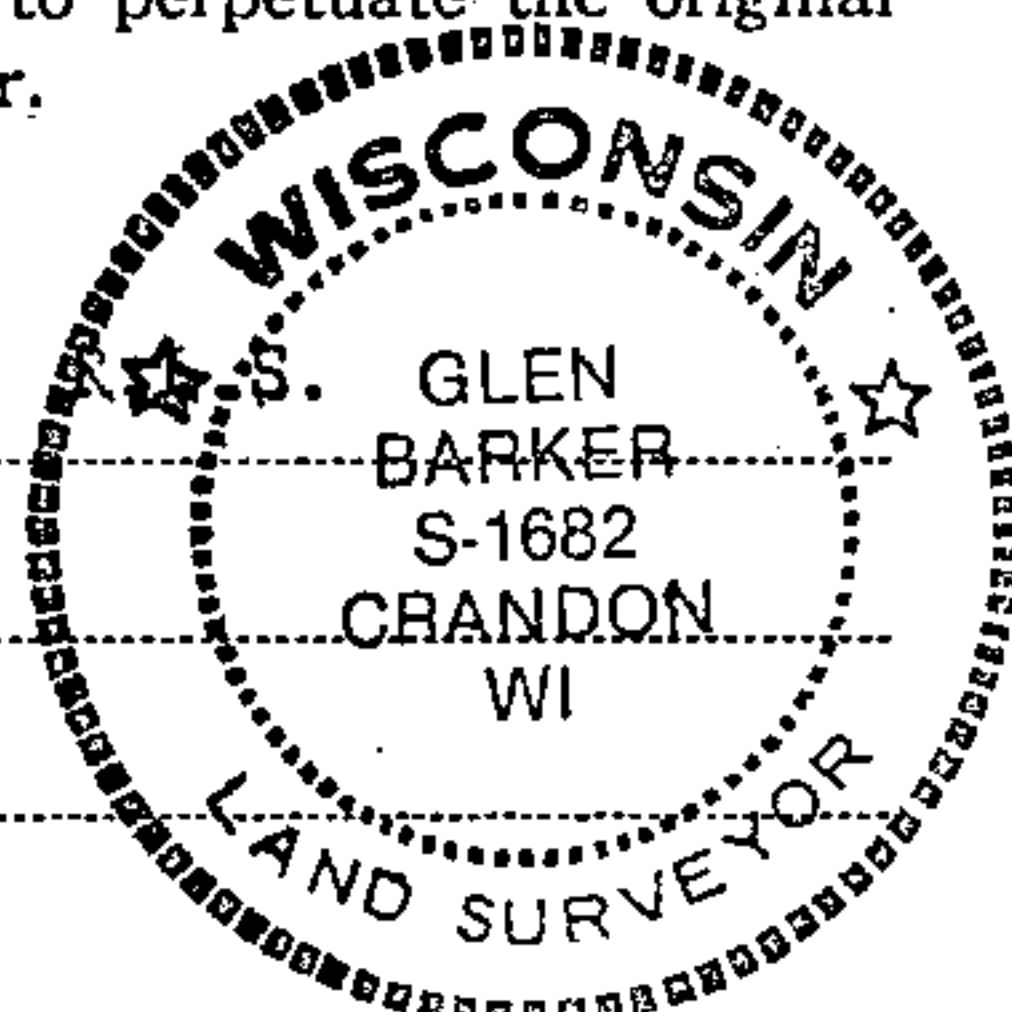

Description of monument and accessories I established to perpetuate the original location of this corner.

Set a 1" iron pipe with 2" diameter alloy cap stamped:
Monument projects 18" above ground

Marked NBTs

Black spruce 6" N72W 33.28 ft.
Black spruce 6" S22E 24.78 ft.
Scribed 1/16 - B.T.

S1682

T34N R13E

SW 1/16 S 35

CPI - 1983

Stock No. 26272

McMillan Company

FORM 985

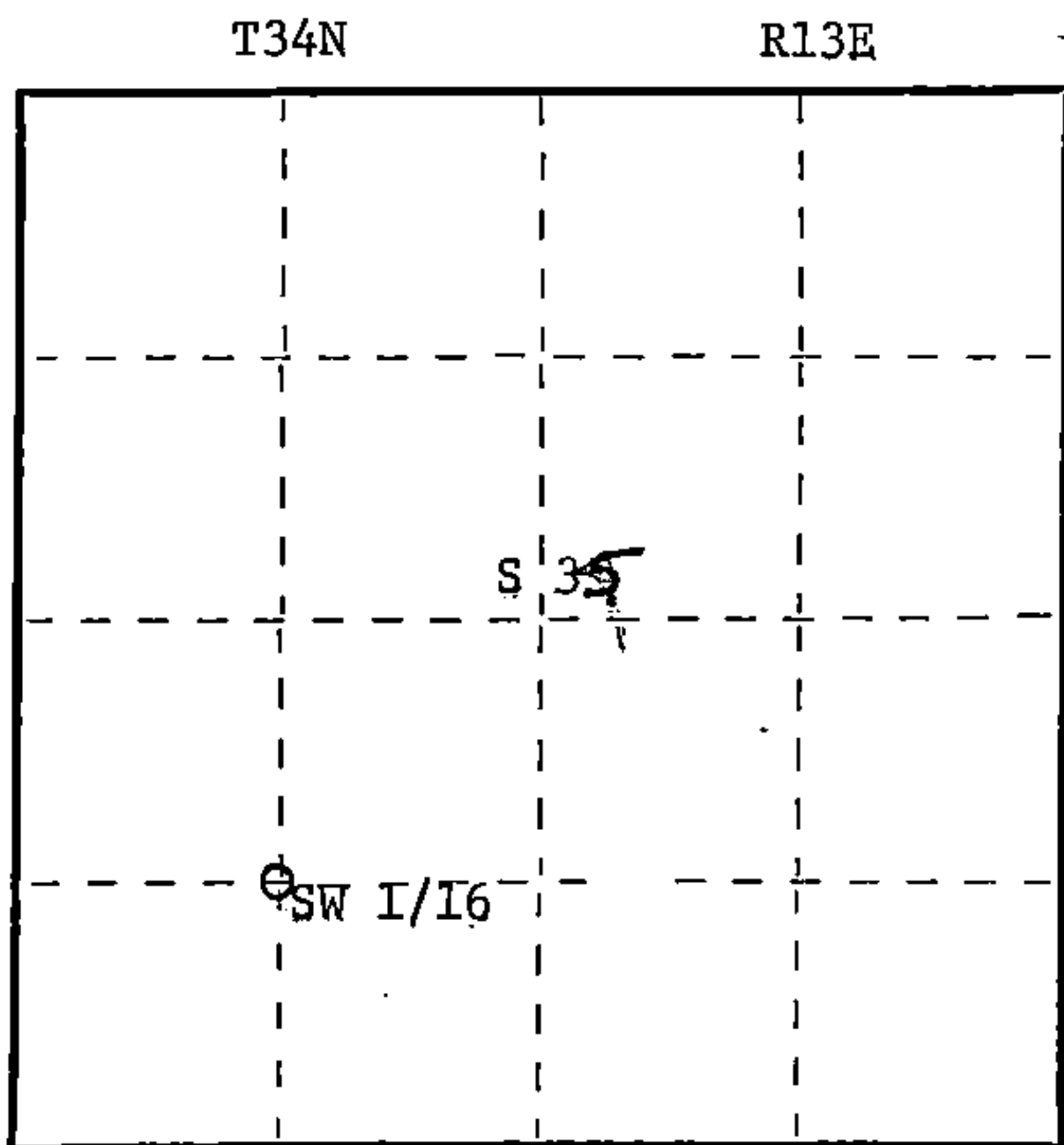

○ = Corner monument restored.

Dated at Rhinelander, Wis., this 6th day of May, 19 83

Signature Glen Barker Title Registered Land Surveyor Registration No. S1682
(County Surveyor, Registered Land Surveyor, or other duly authorized official)

Office of Register of Deeds, County of Forest, I hereby certify that the within
instrument was filed in this office for record on the 19th day of May, 19 83.
at 3:00 o'clock P. M.

Eugene Staszny
(Register of Deeds)
By.....Deputy

DOCUMENT NO.
123424

4341335 1030

CERTIFIED LAND CORNER RESTORATION

Index No. **V-13**

State of Wisconsin }
County of Forest } ss.

I Glen Barker, do hereby certify that on the 12th day of August, 1982, I ~~found~~ established ~~at the~~ SW 1/16 corner of section 35 Township 34, North, Range 13 East, Fourth Principal Meridian, as described hereon; and that from this evidence I established a new monument and accessories as described hereon to perpetuate the original location of this corner.

Resident witnesses:

J. Claflin, Reg. Land Surveyor

H. Wagoner

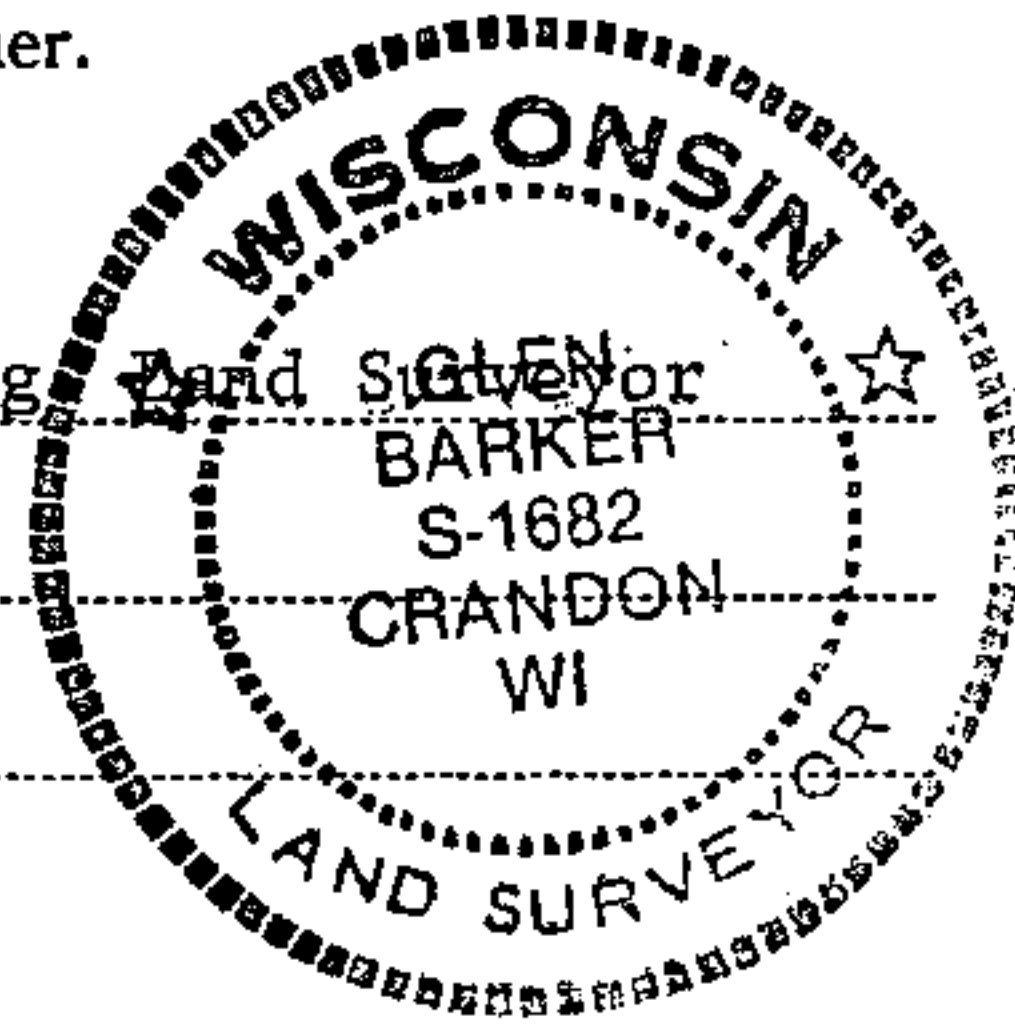

T34N. R13E.

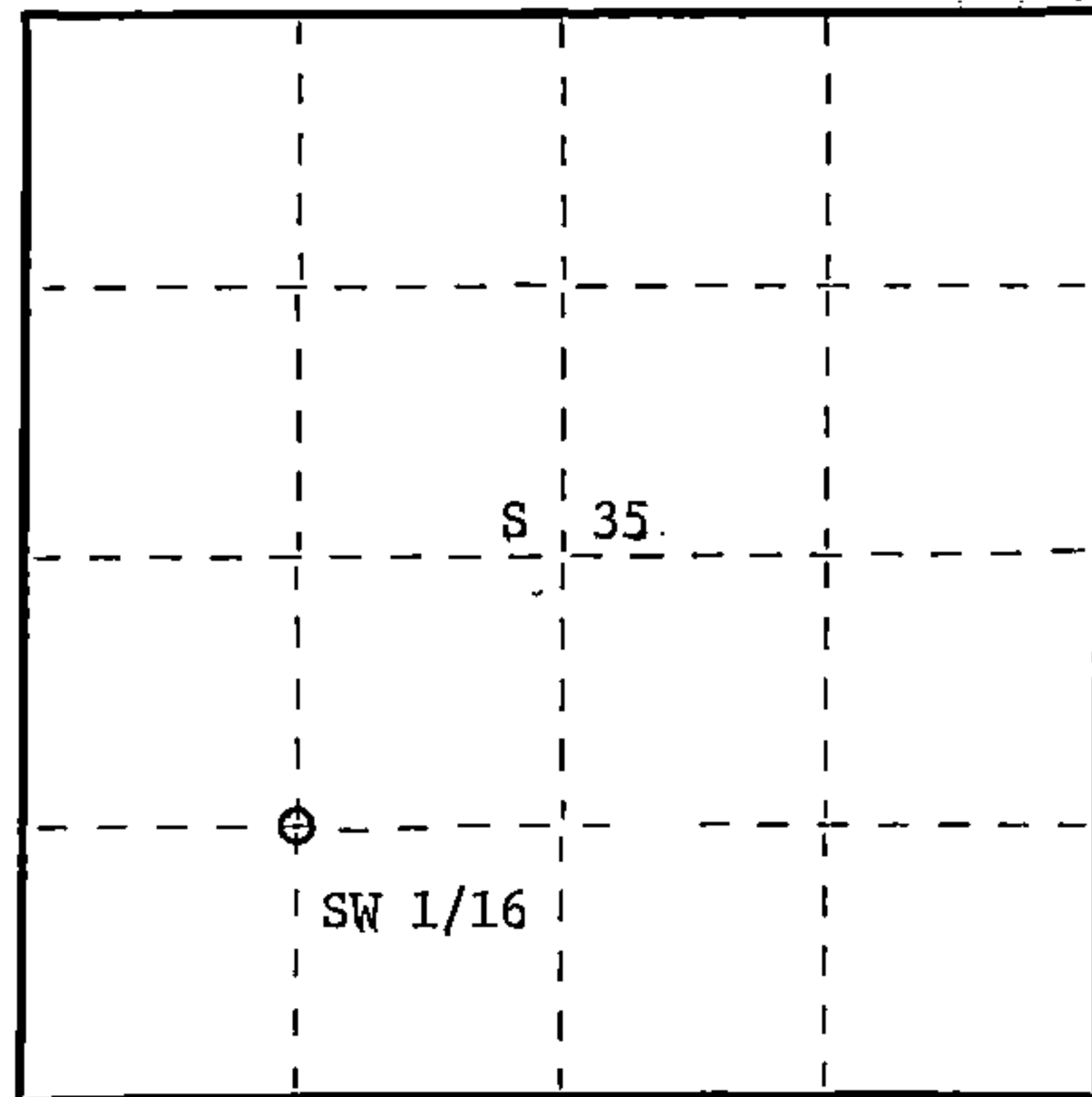

○ = Corner monument restored.

History of original corner establishment:

No evidence of any previous corner.

Description of corner evidence found:

Corner established by subdivision of the SW 1/4. Location of SW 1/16 is S88-50-25W 1315.50 feet of SC 1/16 and N 0-28-16 W 1381.60 feet of W 1/16 between section 2 and 35 T33 & 34 N R13E.

Description of monument and accessories I established to perpetuate the original location of this corner.

Set a 1" iron pipe with 2" diameter alloy cap, stamped:
Monument projects 18" above ground.
Marked NBT's: Black Spruce 6" N72W 33.28 feet
Black Spruce 6" S22E 24.78 feet.
scribed 1/16 - B.T.

S1682
T34N R13E
SW 1/16 S+35
CPI - 1982

43413351830

Dated at Rhineland, Wis., this 19th day of April, 1983

Signature Glen Barker Title Registered Land Surveyor Registration No. S-1682
(County Surveyor, Registered Land Surveyor, or other duly authorized official)

Office of Register of Deeds, County of Forest, I hereby certify that the within instrument was filed in this office for record on the 19th day of May, 1983 at 3:00 o'clock P. M.

Eugene Stutzman
(Register of Deeds)

By _____ Deputy

DOCUMENT NO. **123423**

Stock No. 26272
FORM 985
H.C. Miller Company