

CERTIFIED LAND CORNER RESTORATION

Index No. W-13

W13

State of Wisconsin }  
County of Forest } ss.

I Glen Barker, do hereby certify that on the 29th day of December, 19 82, I ~~found~~ ~~established~~ ~~corner of the~~ N 1/16 corner of Sections 33-34 Township 34, North, Range 13 East, Fourth Principal Meridian, as described hereon; and that from this evidence I established a new monument and accessories as described hereon to perpetuate the original location of this corner.

Resident witnesses:

J. Claflin, Reg. Land Surveyor

H. Wagoner

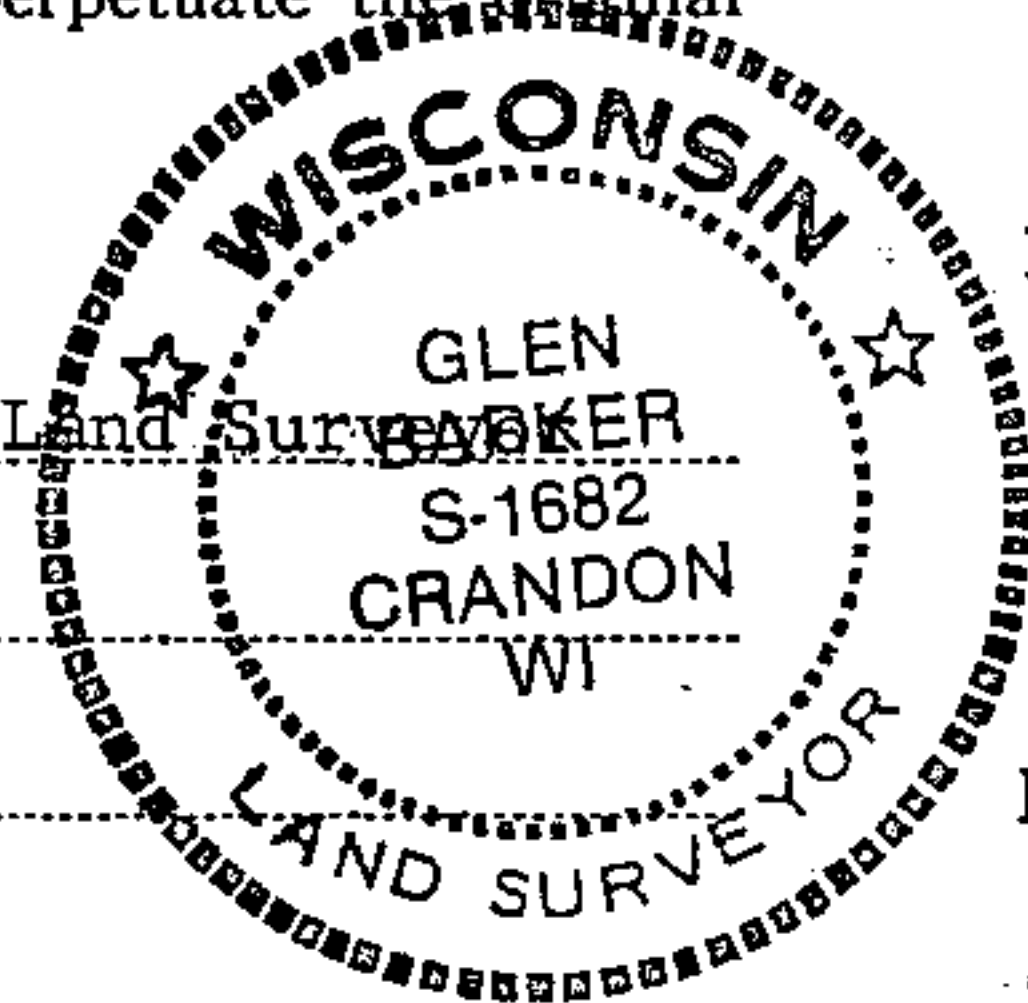

History of original corner establishment:

Corner previously established by Kimberly Clark.

Description of corner evidence found:

Total distance from section corner 27-28-33-34 to 1/4 corner between sections 33-34 is 2634.47 feet at bearing S 0-36-54 E.  
Set N 1/16 1317.24 feet intermediate.  
Kimberly Clark monument bears N 29-30-29 W 7.08 feet of our position.

Description of monument and accessories I established to perpetuate the original location of this corner.

Set a 1" iron pipe with 2" diameter alloy cap, stamped:  
Monument projects 18" above ground.  
Marked NBT's:

White Birch 6" N77°E 25.24 feet  
Sugar 5" N66°W 19.75 feet  
scribed 1/16 B.T.

S1682  
T34N R13E  
N 1/16 33+34  
CPI - 1982

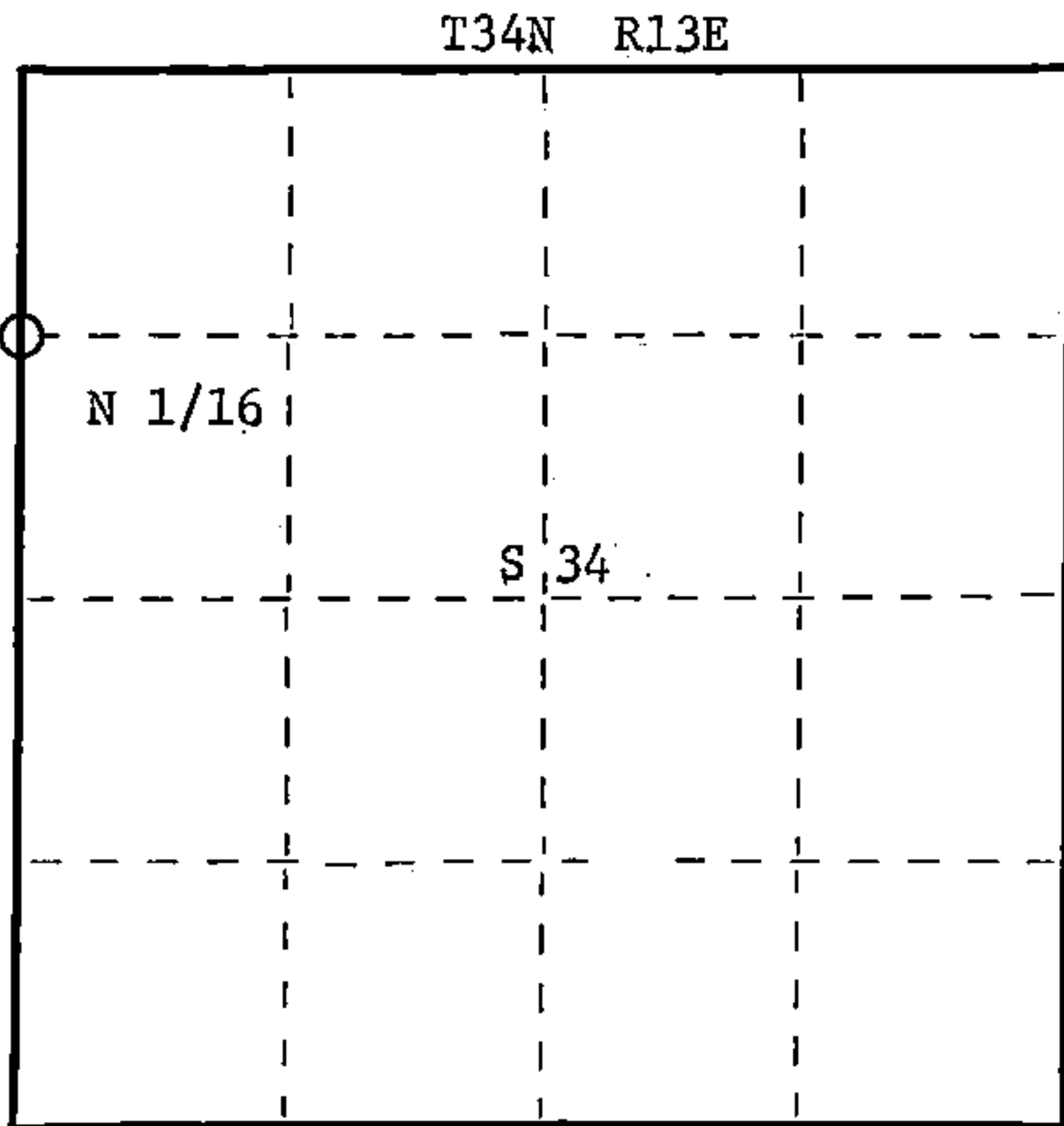

○ = Corner monument restored.

Dated at Rhinelander, Wis., this 21st day of March, 19 83

Signature Glen Barker Title Registered Land Surveyor Registration No. S-1682  
(County Surveyor, Registered Land Surveyor, or other duly authorized official)

Office of Register of Deeds, County of Forest, I hereby certify that the within instrument was filed in this office for record on the 7th day of April, 19 83 at 9:30 o'clock A. M.

Eugene Stutzman  
(Register of Deeds)

By \_\_\_\_\_ Deputy

DOCUMENT NO. 123154

Stock No. 26272

HC Miller Company

FORM 985

43413333000

State of Wisconsin  
County of FOREST

} ss. ESTABLISHMENT OF QUARTER - QUARTER SECTION CORNER BETWEEN ORIGINAL GOVERNMENT SURVEY CORNERS.

I NEAL SPERHAKE, do hereby certify that on the TWENTY-SECOND day of OCTOBER, 19 63, I established the NORTH ONE SIXTEENTH CORNER BETWEEN SECTIONS 33 AND 34, TOWNSHIP 34 NORTH, RANGE 13 EAST, Fourth Principal Meridian, as described hereon.

History: There is no record of this corner having ever been previously established.

Description of monument and accessories I established to perpetuate the location of this corner:

At the point determined for the location of the corner I emplaced a:

GALVANIZED IRON PIPE, THREE FEET LONG, ONE INCH IN DIAMETER, WITH ALUMINUM CAP DENOTED AS, "KIMBERLY CLARK CORP. T34N N 1/16 BTWN. 33 & 34 R13E SPERHAKE RLS 463 10/22/63."

The pipe is witnessed by:

- W. Birch 8 S 20°E 14 links. (SCRIBED S34 BT).
- W. Birch 4 S 81°W 13 links. (SCRIBED S33 BT).

Description as to how corner was located: The section corner 1/4 mile north and the quarter corner 1/4 mile south have been previously established with a distance of 40.14 chains between them. Thus, set the N 1/16 corner 20.07 chains from either corner and on a straight line between them.

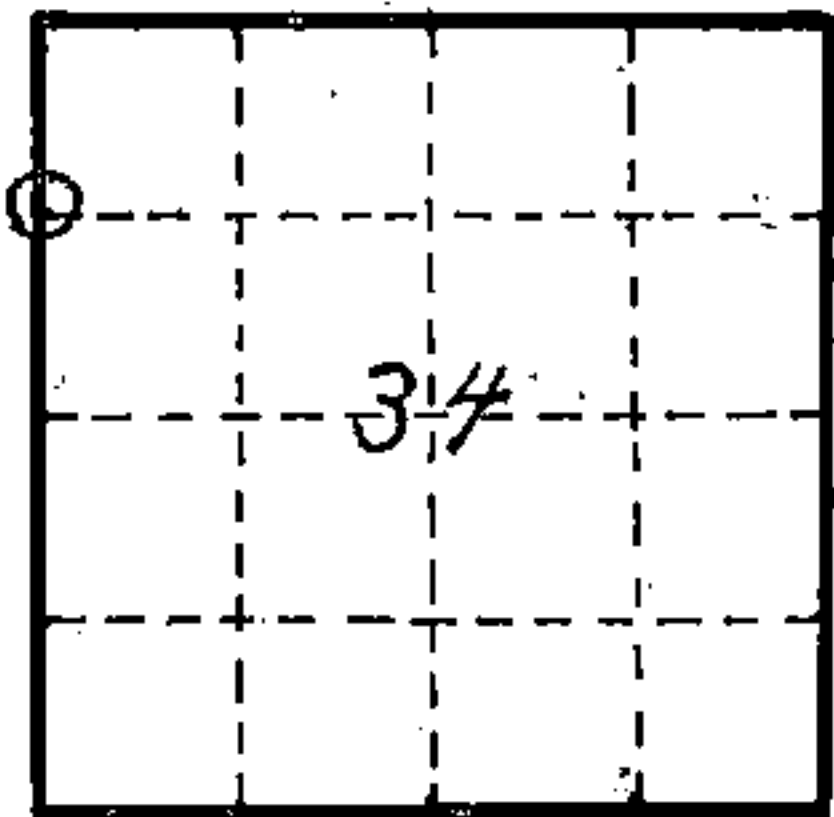

O = Corner monument restored

Subscribed & sworn to before me this 25 day Aug. 1964

Anna Peterson  
NOTARY PUBLIC, FOREST CO., WIS  
COM. EXPIRES 10/31/65

89042

Resident witnesses \_\_\_\_\_

Dated at Grandon, Wisconsin, this 25 day of Aug, 1964.

Signature Neal Sperhake

Title Registered Land Surveyor Registration No. 463

Office of Reg. Deeds County of Forest

I hereby certify that the within instrument was filed in this office for record on the 25 day of Aug 19 64, and was filed in Book No. \_\_\_\_\_ Page No. \_\_\_\_\_ of County Records.

Surveyor's Seal

Signature Anna Peterson Title Reg. of Deeds

43413333000

Index No. W 13 33