

CERTIFIED LAND CORNER RESTORATION

Index No. V-19

V14

State of Wisconsin }  
County of Forest } ss.

I Glen Barker, do hereby  
certify that on the 30th day  
of December, 1982, I ~~found~~  
~~discovered~~ the W 1/16  
corner of sections 27 & 34  
Township 34, North, Range  
13 East, Fourth Principal Meridian,  
as described hereon; and that from this evidence  
I established a new monument and accessories  
as described hereon to perpetuate the original  
location of this corner.

Resident witnesses:

J. Claflin - Reg. Land Surveyor

H. Wagoner

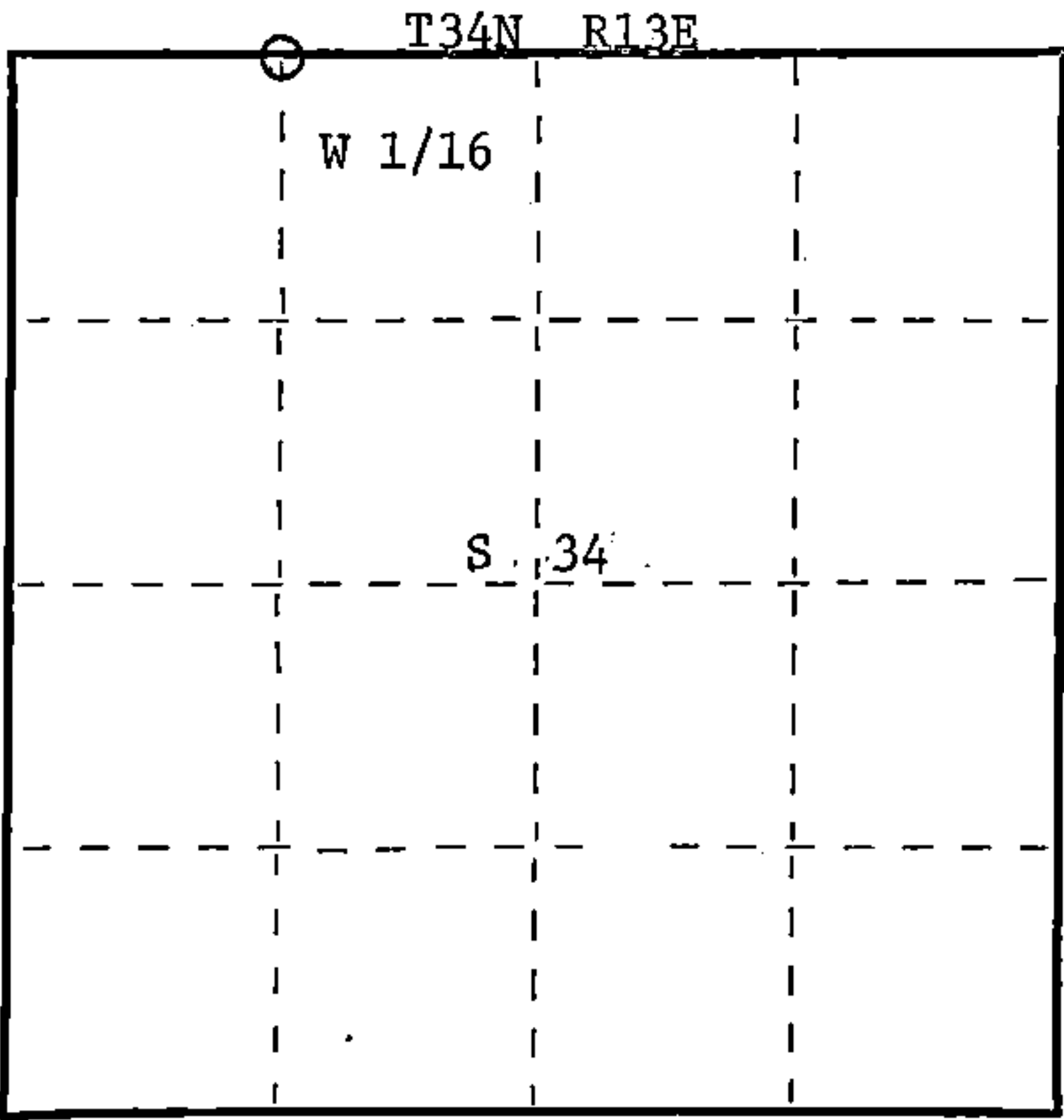
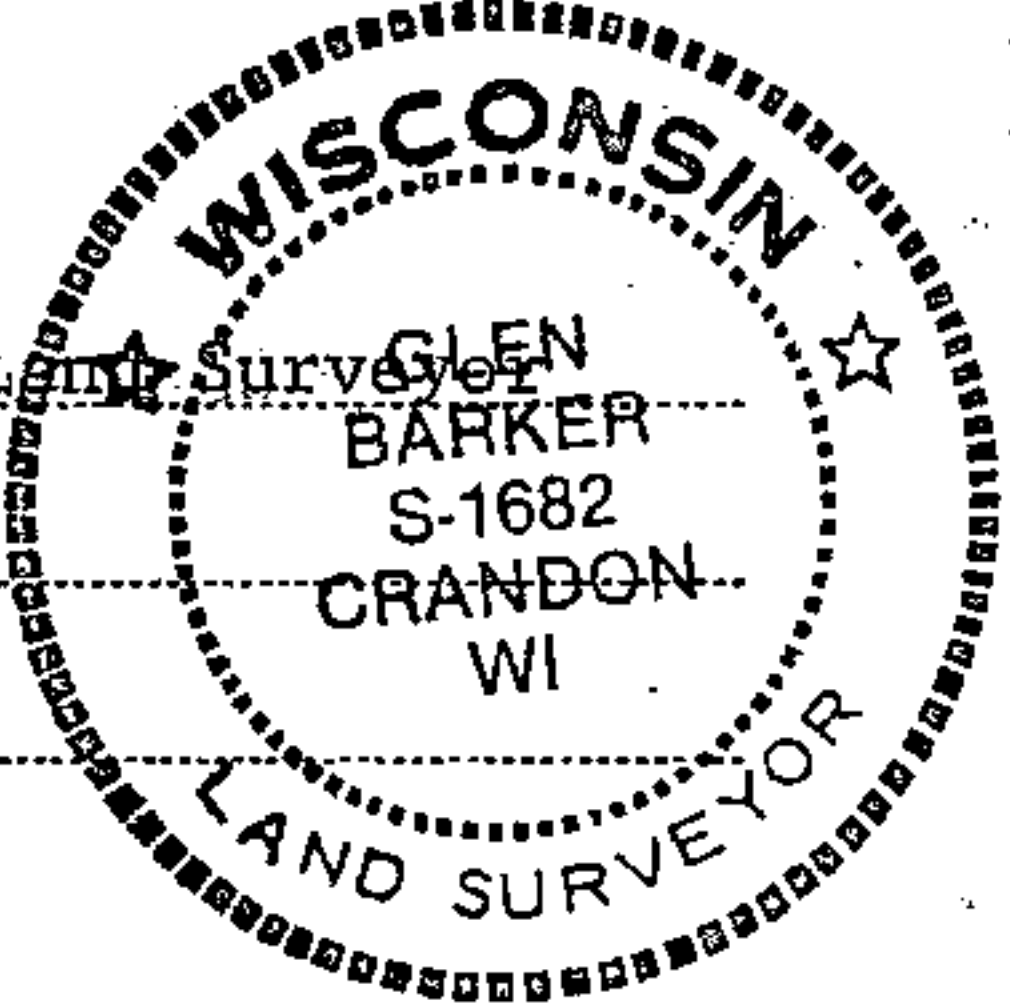

○ = Corner monument restored.

History of original corner establishment:

Corner previously established by Kimberly Clark Corp.

Description of corner evidence found:

Total distance from section corner 27-28-33-34 to 1/4 corner between sections 27 & 34  
is 2618.92 feet at bearing N 88-25-39 E.  
Set W 1/16 1309.46 feet intermediate.  
Kimberly Clark monument bears N 29-15 W 7.22 feet from established position.

Description of monument and accessories I established to perpetuate the original location of this corner.

Set a 1" iron pipe with 2" diameter alloy cap - stamped:  
Monument projects 18" above ground.  
Marked NBT's:

Sugar 8" N83°W 23.0 feet  
Sugar 7" S53°E 21.73 feet  
scribed 1/16 B.T.

S1682  
T34N R13E  
W 1/16 S 27  
S 34  
CPI-1982

Dated at Rhineland, Wis., this 21st day of March, 1983

Signature Glen Barker Title Registered Land Surveyor Registration No. S-1682  
(County Surveyor, Registered Land Surveyor, or other duly authorized official)

Office of Register of Deeds, County of Forest, I hereby certify that the within  
instrument was filed in this office for record on the 7th day of April, 1983  
at 9:30 o'clock A. M.

Eugene Stetson  
(Register of Deeds)  
By \_\_\_\_\_ Deputy

DOCUMENT NO. 123153

FORM 985  
H.C. Miller Company  
Stock No. 26272

43413270030

State of Wisconsin }  
County of FOREST } ss. ESTABLISHMENT OF QUARTER - QUARTER SECTION CORNER BETWEEN  
ORIGINAL GOVERNMENT SURVEY CORNERS.

I NEAL SPERHAKE, do hereby certify that on the NINETEENTH day of NOVEMBER 19 63, I established the WEST ONE SIXTEENTH CORNER BETWEEN SECTIONS 27 AND 34, TOWNSHIP 34 NORTH, RANGE 13 EAST, Fourth Principal Meridian, as described hereon.

History: There is no record of this corner having ever been previously established.

Description of monument and accessories I established to perpetuate the location of this corner:

At the point determined for the location of the corner I emplaced a:  
GALVANIZED IRON PIPE, THREE FEET LONG, ONE INCH IN DIAMETER, WITH ALUMINUM CAP DENOTED AS,  
"KIMBERLY CLARK CORP. T34N W 1/16 BTWN. 27 & 34 R13E SPERHAKE RLS 463 11/19/63."

The pipe is witnessed by:  
Maple 5 N 08°E 36 links. (SCRIBED S27 BT).  
Maple 6 S 27°E 11 links. (SCRIBED S34 BT).

Description as to how corner was located: The section corner 1/4 mile west and the quarter corner 1/4 mile east have been previously established with a distance of 39.79 chains between them. Thus, set the W 1/16 corner 19.89 1/2 chains from either corner and on a straight line between them.

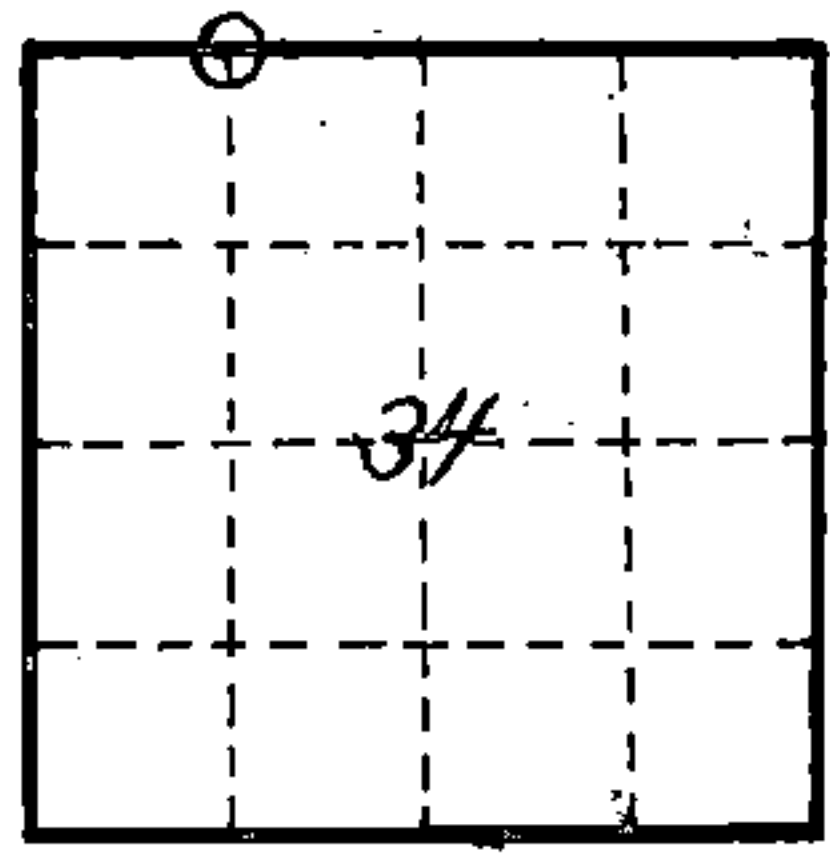

O = Corner monument restored

Subscribed & sworn to before me this 25 day of Aug. 1964

Anna Peterson  
NOTARY PUBLIC, FOREST CO., WIS  
COM. EXPIRES 10/31/65

89004

Resident witnesses

Dated at Crandon, Wisconsin, this 25 day of Aug, 19 64.

Signature Neal Sperhake  
Title Registered Land Surveyor Registration No. 463

Office of Reg. of Deeds County of Forest  
I hereby certify that the within instrument was filed in this office for record on the 25 day of Aug 19 64, and was filed in Book No. Page No. of County Records.

Surveyor's Seal

Signature Anna Peterson Title Reg. of Deeds

43413270030

Index No.

43413270030