

State of Wisconsin
County of FOREST

ss. ESTABLISHMENT OF QUARTER - QUARTER SECTION CORNER BETWEEN ORIGINAL GOVERNMENT SURVEY CORNERS.

I NEAL SPERHAKE, do hereby certify that on the THIRTY-FIRST day of OCTOBER, 19 63, I established the WEST ONE SIXTEENTH CORNER BETWEEN SECTIONS 24 AND 25, TOWNSHIP 34 NORTH, RANGE 13 EAST, Fourth Principal Meridian, as described hereon.

History: There is no record of this corner having ever been previously established.

Description of monument and accessories I established to perpetuate the location of this corner:

At the point determined for the location of the corner I emplaced a:

GALVANIZED IRON PIPE, THREE FEET LONG, ONE INCH IN DIAMETER, WITH ALUMINUM CAP DENOTED AS, "KIMBERLY CLARK CORP. T34N W 1/16 BTWN. 24 & 25 R13E SPERHAKE RLS 463 10/31/63".

The pipe is witnessed by:

Elm 9 N 09°E 43 links. (SCRIBED S24 BT).
Balsam 7 S 21°E 103½ links. (SCRIBED S25 BT).

Description as to how corner was located: The section corner ¼ mile west and the quarter corner ¼ mile east have been previously established with a distance of 39.53½ chains between them. Thus, set the W 1/16 corner 19.76¾ chains from either corner and on a straight line between them.

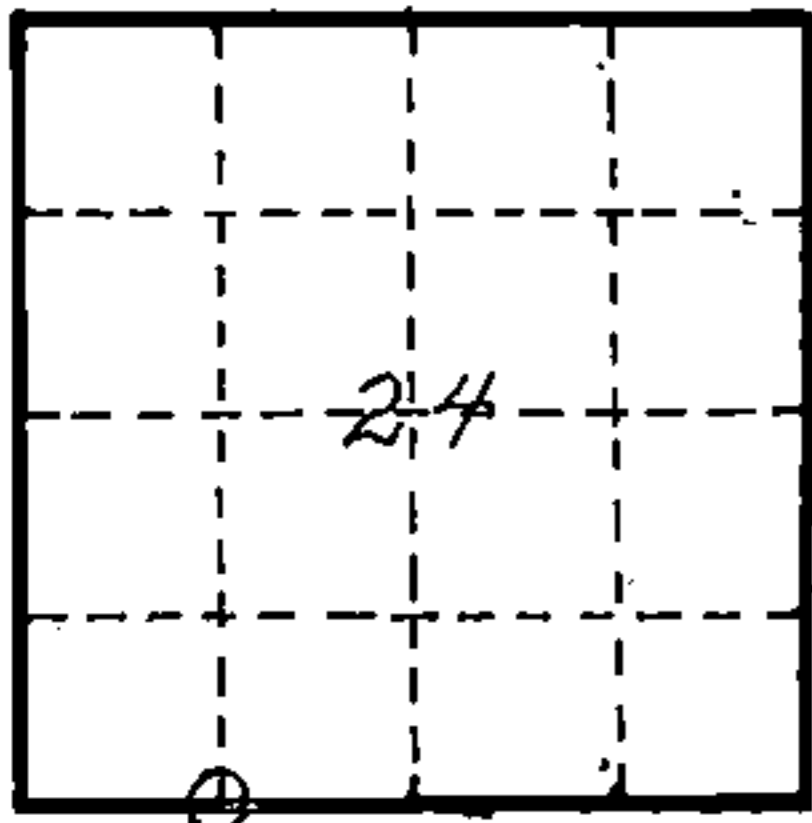

O = Corner monument restored

Subscribed & sworn to before me this 25 day of Aug 1964

Anna Peterson

NOTARY PUBLIC, FOREST CO., WIS
COM. EXPIRES 10/31/65

88984

Resident witnesses _____

Dated at Crandon, Wisconsin, this 25 day of Aug, 19 64.

Signature *Neal Sperhake*

Title Registered Land Surveyor Registration No. 463

Office of Reg. of Deeds County of Forest

I hereby certify that the within instrument was filed in this office for record on the 25 day of Aug 19 64, and was filed in Book No. _____ Page No. _____ of County Records.

Surveyor's Seal

Signature *Anna Peterson* Title Reg. of Deeds

434132A0030

Index No.

P-22
R-22