

State of Wisconsin

County of FOREST

ss. RESTORATION OF LOST ORIGINAL GOVERNMENT SURVEY CORNER.

I NEAL SPERHAKE, do hereby certify that on the FIRST day of NOVEMBER, 1963, I established the WEST QUARTER SECTION CORNER OF SECTION 24, TOWNSHIP 34 NORTH, RANGE 13 EAST, Fourth Principal Meridian, as described hereon.

History: This corner was established during the original survey of this township, as noted in the original field notes for the original survey of T34N-R13E, 4th. p.m.

Description of monument and accessories I established to perpetuate the location of this corner:

At the point determined for the location of the corner I emplaced a:

GALVANIZED IRON PIPE, THREE FEET LONG, ONE INCH IN DIAMETER, WITH ALUMINUM CAP DENOTED AS, "KIMBERLY-CLARK CORP. T34N 1/4 BTWN. 23 & 24 R13 E SPERHAKE RLS 463 11/1/63."

The pipe is witnessed by:

- Maple 6 N 20°E 40 links. (SCRIBED 1/4 S 24 NBT).
- Elm 6 S 75°W 28 1/2 links. (SCRIBED 1/4 S 23 NBT).

Description as to how corner was located: No evidence of original corner present. The section corner 1/2 mile south and the quarter corner 1 mile north have been previously established with a distance of 119.64 chains between them. Proportionately, therefore, the quarter corner should be 39.88 chains north of the section corner. A soo line railroad survey map shows the location of the quarter corner to be 425 feet east of the center line of the railroad track. 12 links north and 1 link west of the above stated position is the junction of two old fences and part of an old squared post in the ground beside the fence post. I believe the old post and fence junction mark the site of the original quarter corner and therefore I have accepted it and marked it as noted above. It is 40.00 chains south to the section corner common to sections 23, 24, 25 and 26 and 39.82 chains north to the corner of 13, 14, 23, 24.

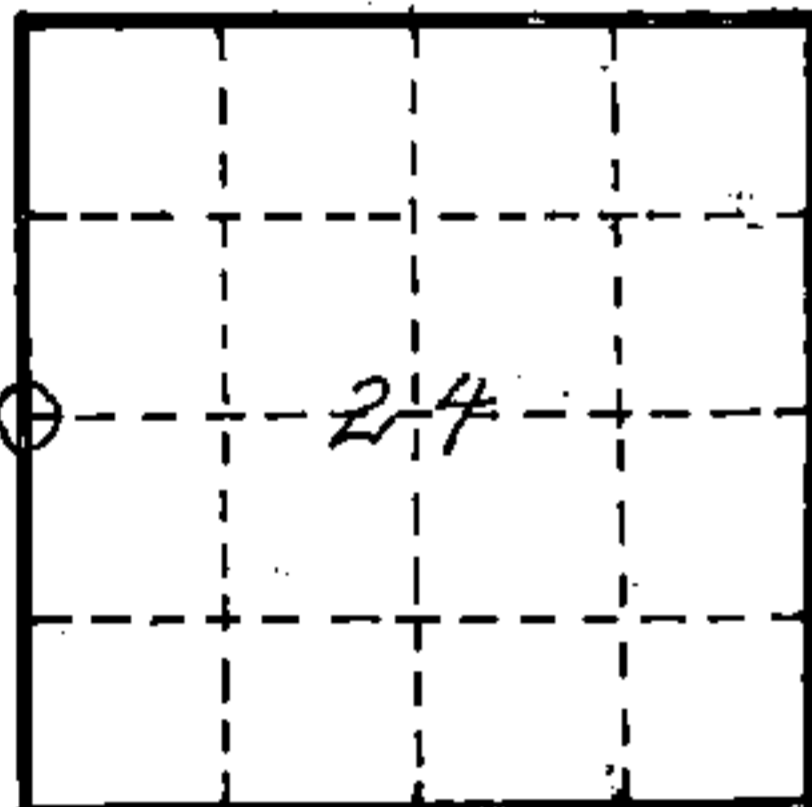

0 = Corner monument restored

Subscribed & sworn to before me this 25 day of Aug 1964

Anna Peterson

NOTARY PUBLIC, FOREST CO., WIS.
COM. EXPIRES 10/31/65

88986

Resident witnesses _____

Dated at Crandon, Wisconsin, this 25 day of Aug, 1964.

Signature Neal Sperhake

Title Registered Land Surveyor Registration No. 463

Office of Reg. of Deeds County of Forest,
I hereby certify that the within instrument was filed in this office for record on the 25 day of Aug 1964, and was filed in Book No. _____ Page No. _____ of County Records.

Surveyor's Seal

Signature Anna Peterson Title Reg. of Deeds

43413232000

Index No.

P-221
P-221