

CERTIFIED LAND CORNER RESTORATION

Index No. L-9

State of Wisconsin }
 County of Forest } ss.

History of original corner establishment:

Original corner established in 1865 by James L. Nowlin, Gov. Deputy Surveyor from which birch 8" bears N37W 6 lks and birch 22" S30E 50 lks.

I Glen Barker, do hereby certify that on the 22nd day of September, 19 83, I found evidence of the Quarter corner of Sections 16 & 17 Township 34, North, Range 13 East, Fourth Principal Meridian, as described hereon; and that from this evidence I established a new monument and accessories as described hereon to perpetuate the original location of this corner.

Description of corner evidence found:

Recovered a very old cedar post for N 1/16 between Sections 16 & 17 squared and scribed. Ran from old N 1/16 to Section corner 8-9-16-17 for a distance of 1315.34 ft. Doubled distance (2630.68) from Section corner on extended alignment. Set 1/4 corner. From this position found a large sugar 20" with north-south line blazes. On the recovered evidence reestablished 1/4 corner. Corner sets 2630.68 ft. of Sec. Corner 9-10-16-17 and 2605.18 ft. of Sec. Corner 9-10-16-17.

Resident witnesses:

J. Claflin - RL

H. Wagoner

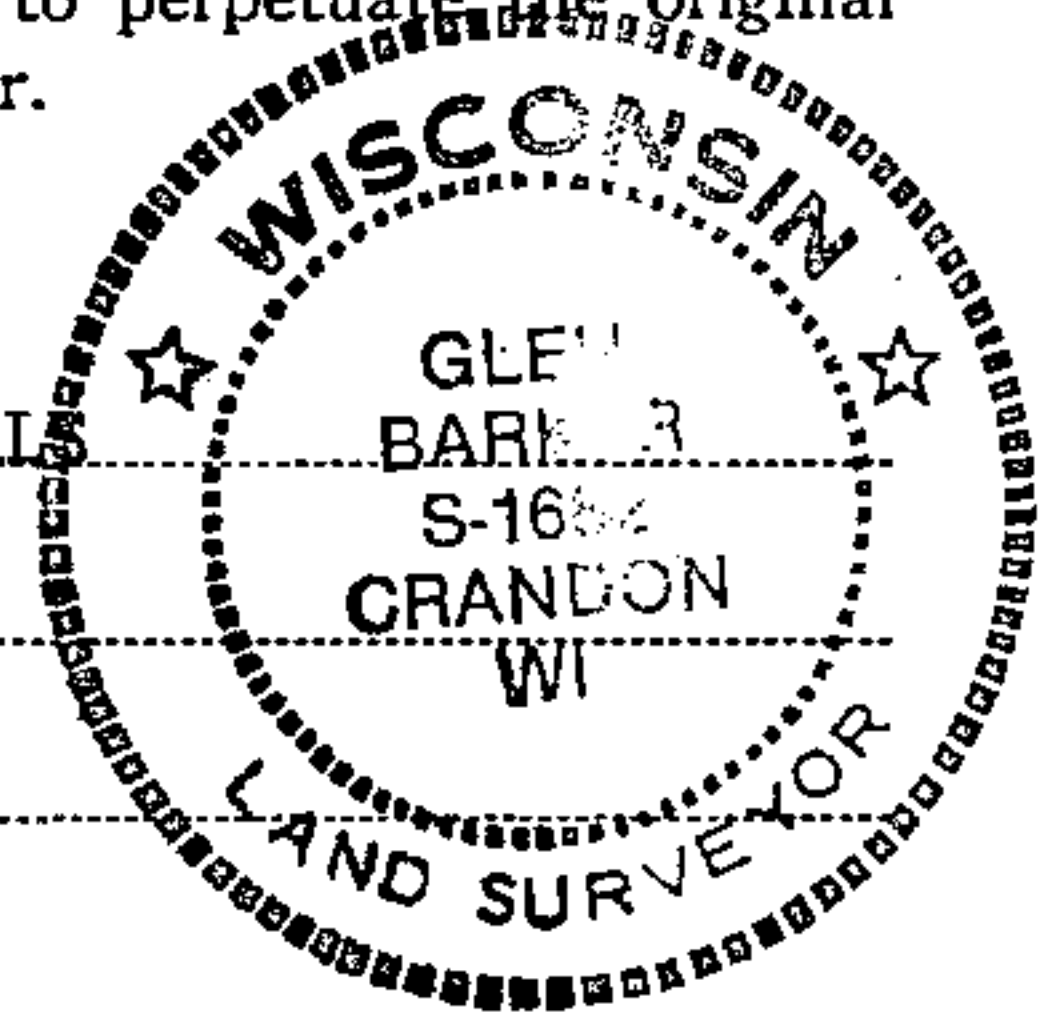

Description of monument and accessories I established to perpetuate the original location of this corner.

Set a 2 1/2" A-1 Forest County monument with alloy cap stamped: T34N R13E
 Monument projects 8" above ground. 1/4 17 16
 Marked NBTs S1682 - 1983
 Sugar 6" N45W 4.42 ft.)
 Sugar 4" S47E 11.94 ft.)
 Sugar 6" S41W 15.78 ft.) - Scribed 1/4 - B.T.
 Sugar 6" S84W 39.18 ft.)
 Ties to #16 nail center of tree

Stock No. 26272
 FORM 985

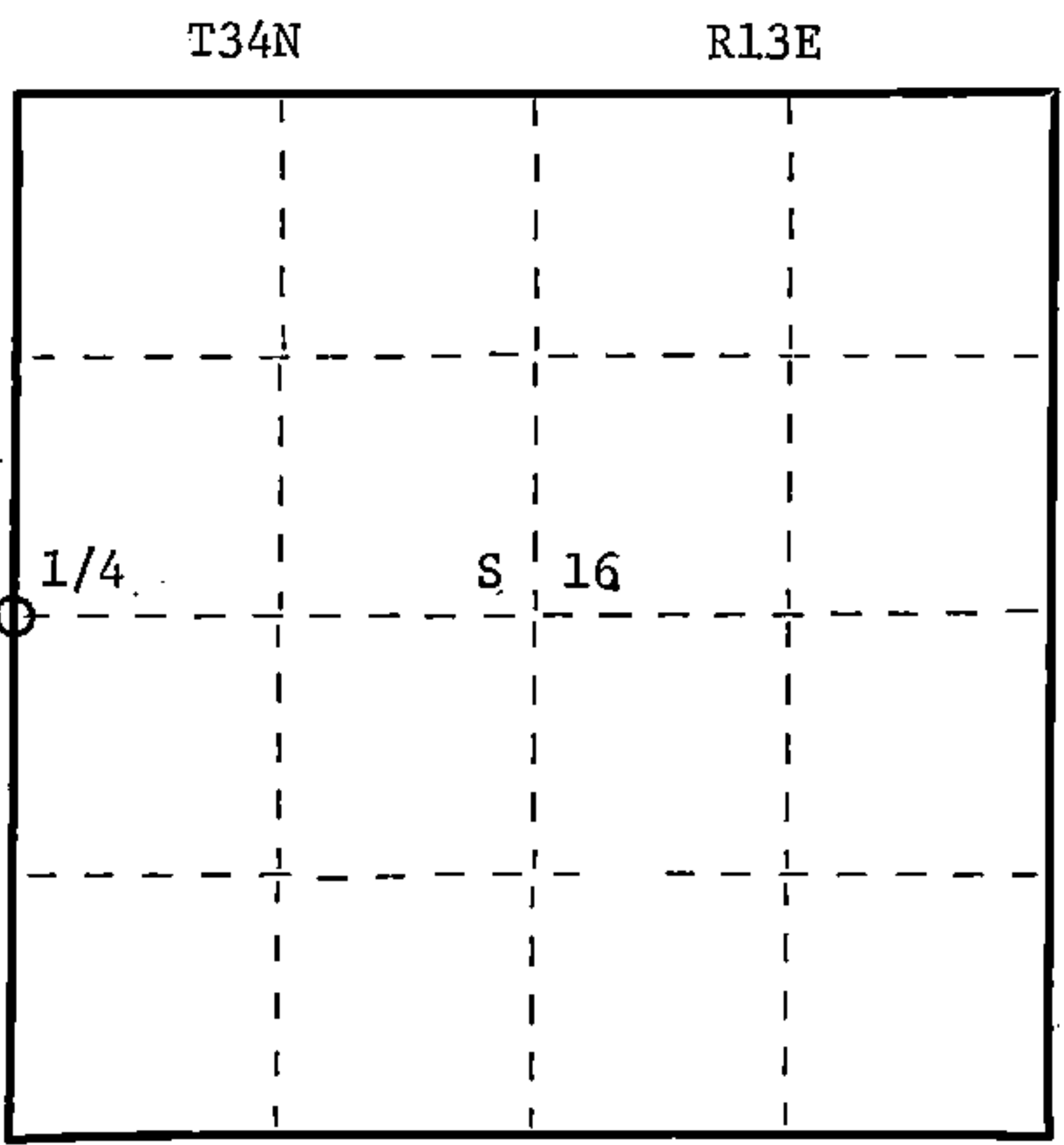

○ = Corner monument restored.

Dated at Rhineland, Wis., this 23rd day of November, 1983

Signature Glen Barker Title Registered Land Surveyor Registration No. S1682
 (County Surveyor, Registered Land Surveyor, or other duly authorized official)

Office of Register of Deeds, County of Forest, I hereby certify that the within instrument was filed in this office for record on the 22nd day of February, 1984 at 11:00 clock A. M.

Eugene Staryny
 (Register of Deeds)
 By _____ Deputy

DOCUMENT NO. **125204**

43413172000