

CERTIFIED LAND CORNER RESTORATION

Index No. **N-11**

State of Wisconsin }
County of Forest } ss.

I Glen Barker, do hereby
certify that on the 16th day
of May, 19 83, I ~~found~~ found estab'd.
evidence of the Quarter
corner of Sections 16 & 21
Township 34, North, Range
13 East, Fourth Principal Meridian,
as described hereon; and that from this evidence
I established a new monument and accessories
as described hereon to perpetuate the original
location of this corner.

Resident witnesses:

J. Claflin - R.L.

H. Wagoner

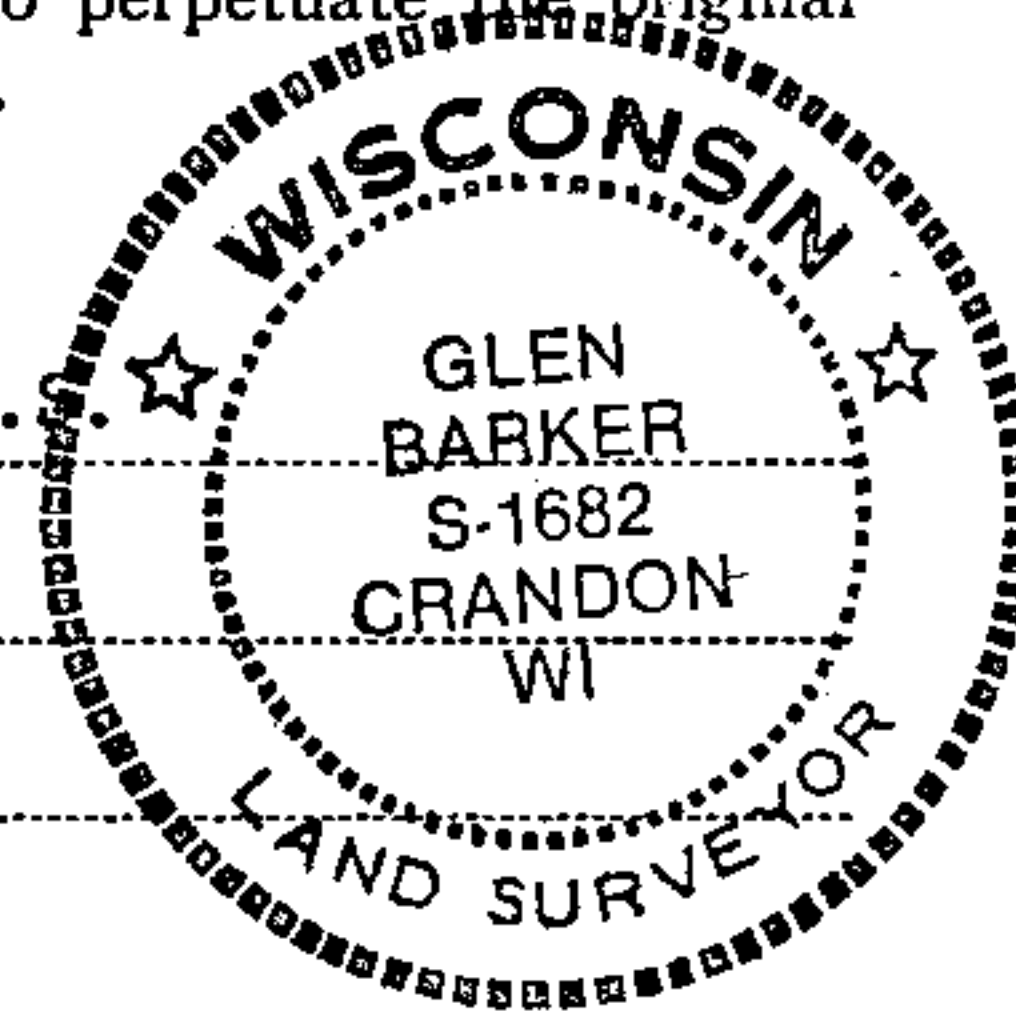

History of original corner establishment:

Original corner established in 1865 by James L. Nowlin, Gov. Deputy Surveyor
from which cedar 10" bears N52W 12 lks and hemlock 24" S17E 5 lks.

Description of corner evidence found:

Total distance from recovered section corner 16-17-20-21 to section corner 15-16-21-22
is 5295.60 ft. Set 1/4 corner 2647.80 ft. intermediate.

Description of monument and accessories I established to perpetuate the original location of this corner.

Set a 2 1/2" A-1 Forest County Monument with alloy cap stamped:
Monument projects 18" above ground.

T34N R13E

Marked NBTs:

- Maple 8" S21W 7.82 ft.
- Maple 10" N71W 7.72 ft.
- Maple 6" N31E 15.38 ft.
- Maple 10" S35E 18.75 ft.

1/4 S 16
S 21

S1682 - 1983

Scribed 1/4 - B.T.

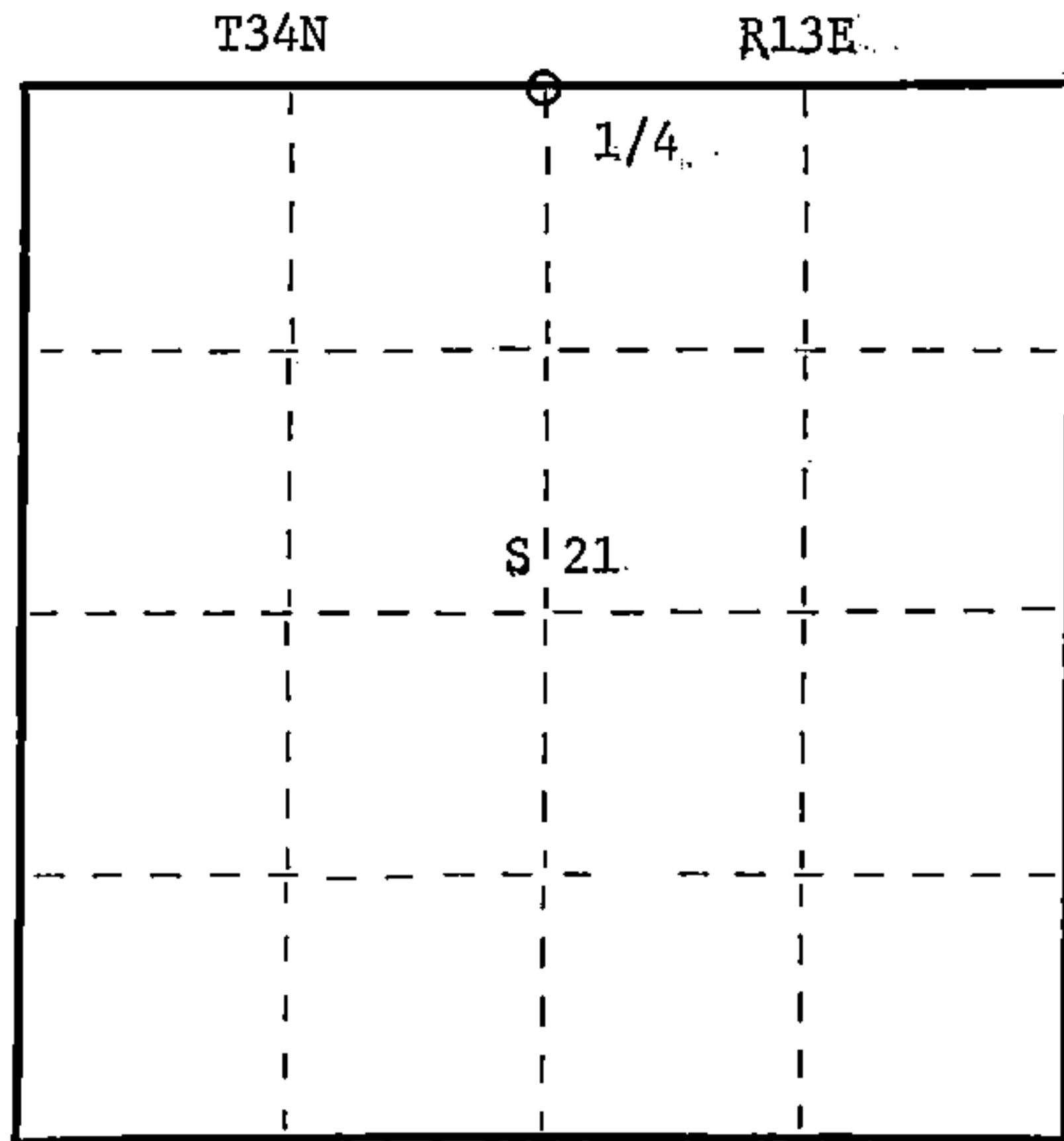

○ = Corner monument restored.

Dated at Rhineland, Wis., this 9th day of June, 19 83.

Signature Glen Barker Title Registered Land Surveyor Registration No. S1682
(County Surveyor, Registered Land Surveyor, or other duly authorized official)

Office of Register of Deeds, County of Forest, I hereby certify that the within
instrument was filed in this office for record on the 26th day of July, 19 83
at 11:55 clock A. M.

Eugene Staszny
(Register of Deeds)

DOCUMENT NO. **123856**

By..... Deputy

Stock No. 26272

McMillan Company

FORM 985

43413160020