

CERTIFIED LAND CORNER RESTORATION

Index No. **N-12**

State of Wisconsin }
County of Forest } ss.
Glen Barker

History of original corner establishment:
No evidence of any previous corner.

I, Glen Barker, do hereby
certify that on the 17th day
of May, 1983, I ~~found~~ found estab'd.
~~evidence of the~~ E 1/16
corner of Section 16 & 21
Township 34, North, Range
13 East, Fourth Principal Meridian,
as described hereon; and that from this evidence
I established a new monument and accessories
as described hereon to perpetuate the original
location of this corner.

Resident witnesses:

J. Claflin - R.L.
H. Wagoner

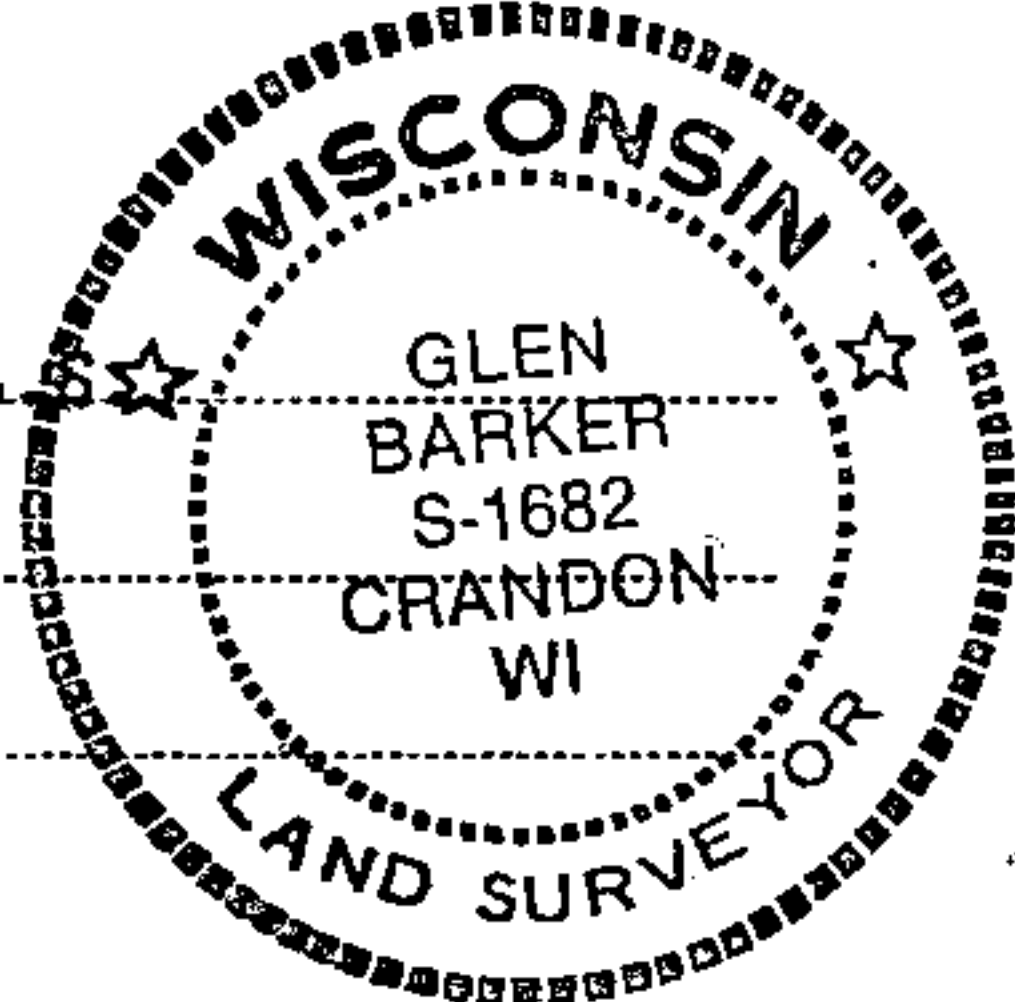

Description of corner evidence found:
Total distance from recovered section corner 15-16-21-22 to previously established
1/4 corner between sections 16 and 21 is 2647.80 ft. Set E 1/16 1323.90 ft. intermedi-
ate.

Description of monument and accessories I established to perpetuate the original location of this corner.
Set a 1" iron pipe with 2" diameter alloy cap stamped: S1682
T34N R13E
Monument projects 18" above ground.
Marked NBTs: E 1/16 S 16
S 21
CPI - 1983
Sugar 6" N38W 7.06 ft.
Sugar 6" S13W 23.17 ft.
Scribed 1/16 = B.T.

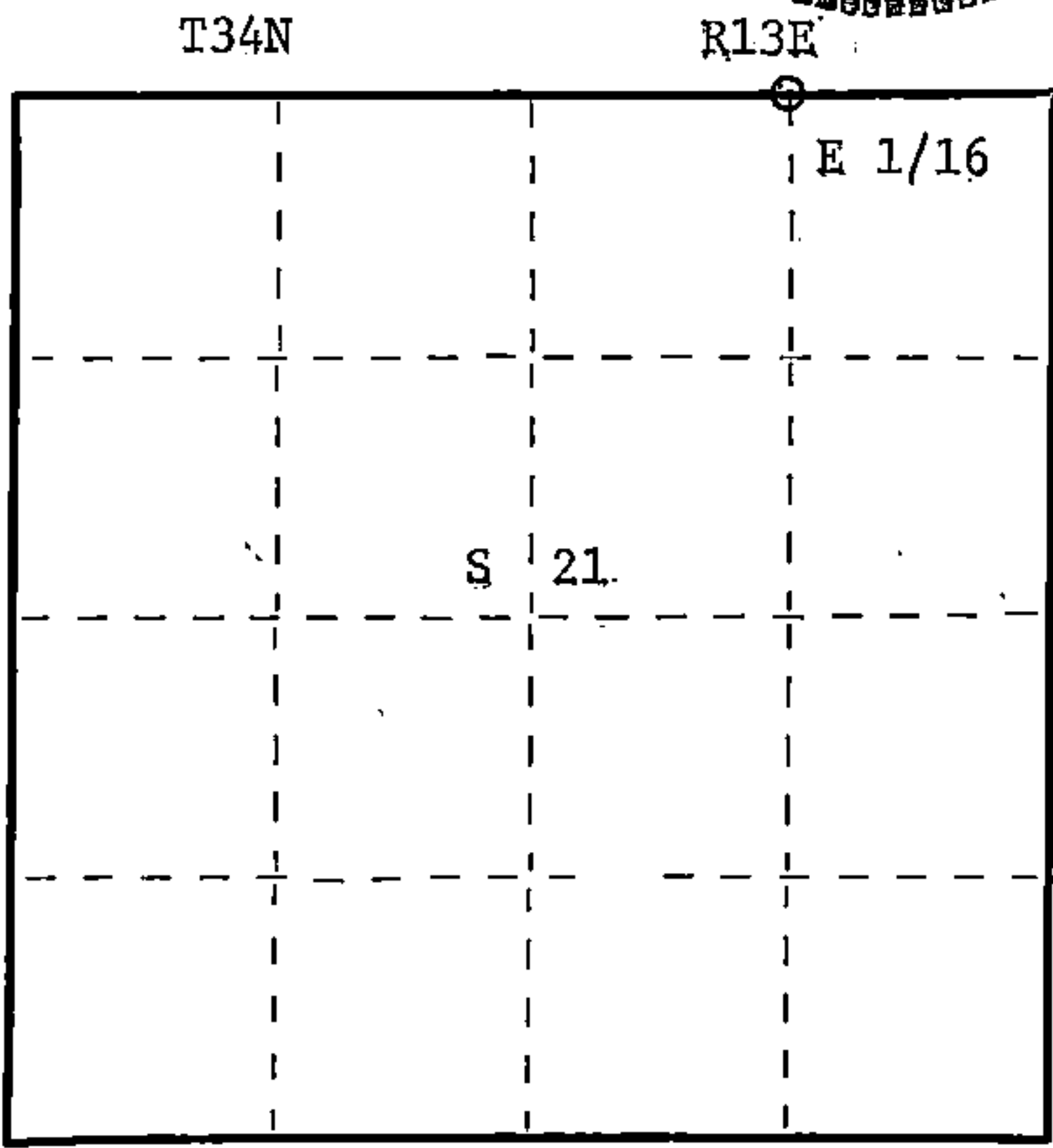

○ = Corner monument restored.

Dated at Rhineland, Wis., this 9th day of June, 1983.
Signature Glen Barker Title Registered Land Surveyor Registration No. S1682
(County Surveyor, Registered Land Surveyor, or other duly authorized official)

Office of Register of Deeds, County of Forest
I hereby certify that the within
instrument was filed in this office for record on the 15th day of June, 1983
at 2:00 o'clock P. M.

Eugene Statyny
(Register of Deeds)

DOCUMENT NO. **123606**

By..... Deputy

Stock No. 26272
FORM 985

43413160010