

CERTIFIED LAND CORNER RESTORATION

Index No. K-29

R 24

State of Wisconsin }
County of Forest } ss.

History of original corner establishment:
No evidence of any previous corner.

I Glen Barker, do hereby
certify that on the 10th day
of September, 1982, I ~~found~~
~~evidence of the~~ NE 1/16
corner of Section 13
Township 34, North, Range
13 East, Fourth Principal Meridian,
as described hereon; and that from this evidence
I established a new monument and accessories
as described hereon to perpetuate the original
location of this corner.

Description of corner evidence found:

Corner established by subdivision of the NE 1/4 Section 13.
Location of NE 1/16 is N1-04-39E 1312.18 ft. of EC 1/16 and S89-40-19E 1270.85 ft. of
NC 1/16.

Resident witnesses:

Jim Claflin - RLS

H. Wagoner

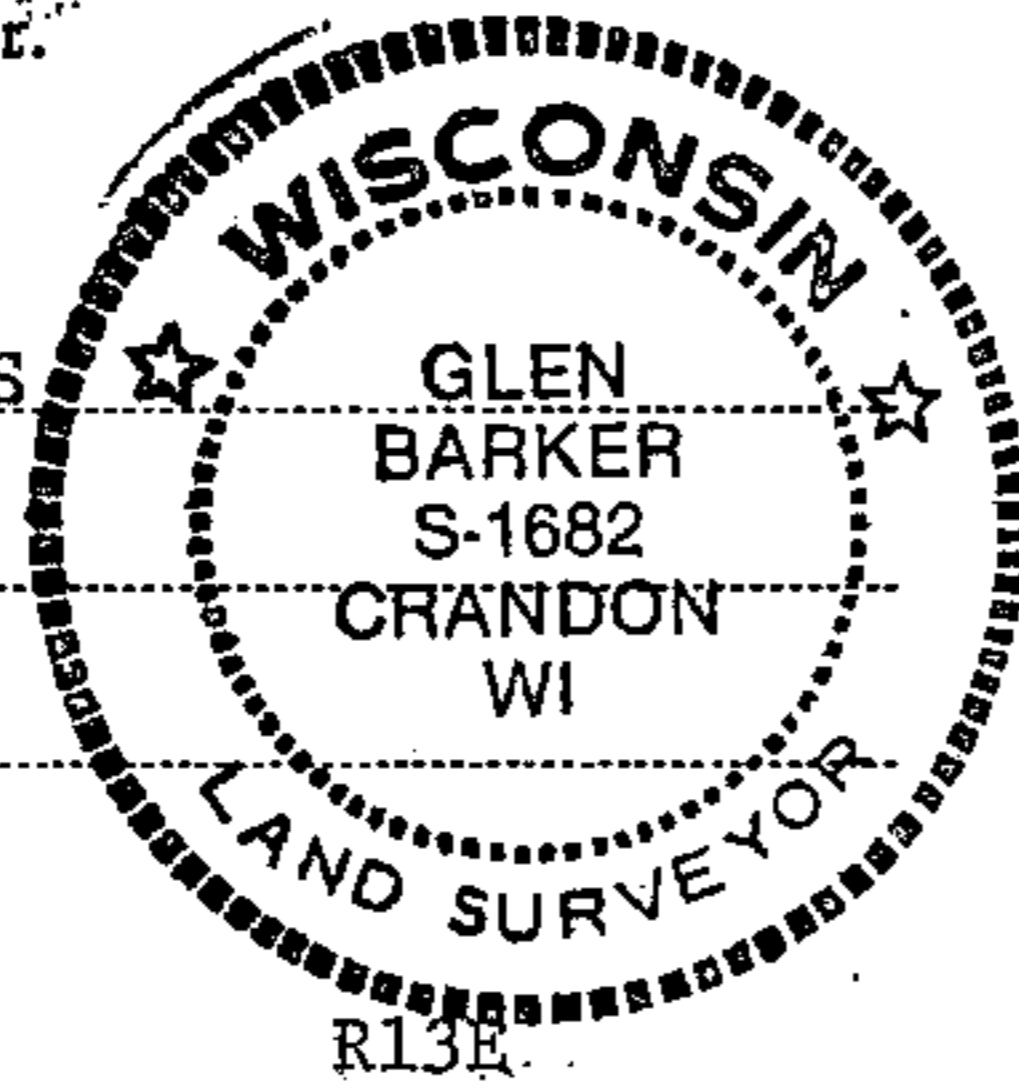

Description of monument and accessories I established to perpetuate the original location of this corner.

Set a 1" iron pipe with 2" diameter alloy cap stamped: S1682
Monument projects 18" above ground. T34N R13E
Marked NBTs: S 13
Aspen 5" N26E 6.53 ft. NE 1/16
Aspen 5" S50E 17.09 ft.
Scribed 1/16 - B.T. CPI - 1982

FORM 985 H. C. MILLER CO., MILWAUKEE

T34N R13E

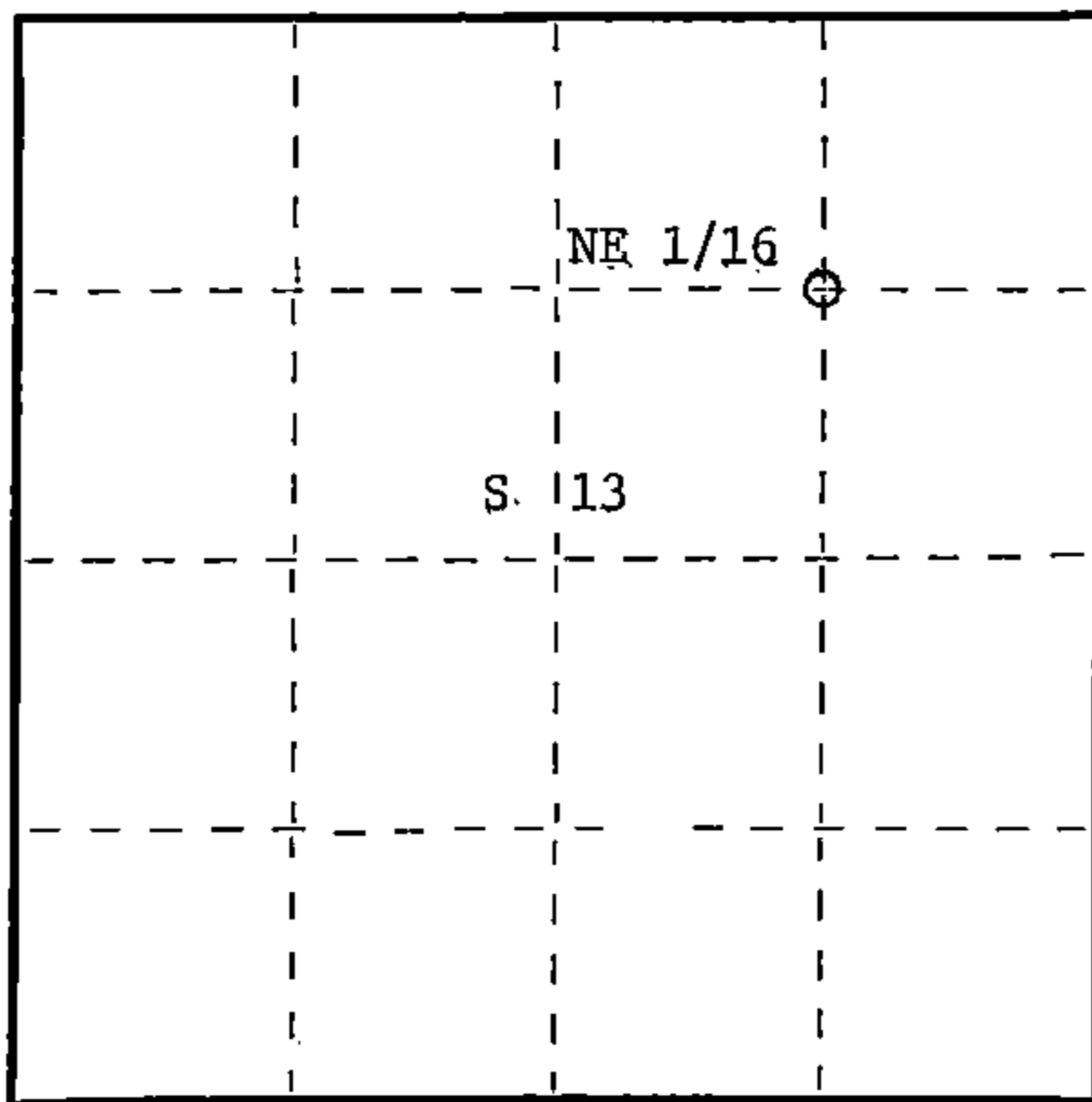

○ = Corner monument restored.

Dated at Rhineland, Wis., this 30th day of December, 1982.

Signature Glen Barker Title Registered Land Surveyor Registration No. S1682
(County Surveyor, Registered Land Surveyor, or other duly authorized official)

Office of Register of Deeds, County of Forest, I hereby certify that the within
instrument was filed in this office for record on the 16th day of February, 1983
at 10:30 o'clock A. M.

Eugene Staszny (Register of Deeds) DOCUMENT NO. 122902

By.....Deputy

43413133010