

CERTIFIED LAND CORNER RESTORATION

Index No. M-22

M 22

State of Wisconsin }
County of Forest } ss.

History of original corner establishment:
No evidence of any previous corner.

I Glen Barker, do hereby
certify that on the 8th day
of September, 19 82, I found Est.
~~evidence of the SW 1/16~~
corner of Section 13
Township 34, North, Range
13 East, Fourth Principal Meridian,
as described hereon; and that from this evidence
I established a new monument and accessories
as described hereon to perpetuate the original
location of this corner.

Description of corner evidence found:

Corner established by subdivision of the SW 1/4. Location of the SW 1/16 is
S0-47-32W 1318.42 ft of WC 1/16 and N89-18-17W 1261.08 ft. of SC 1/16.

Resident witnesses:
Jim Claflin - RLS

H. Wagoner

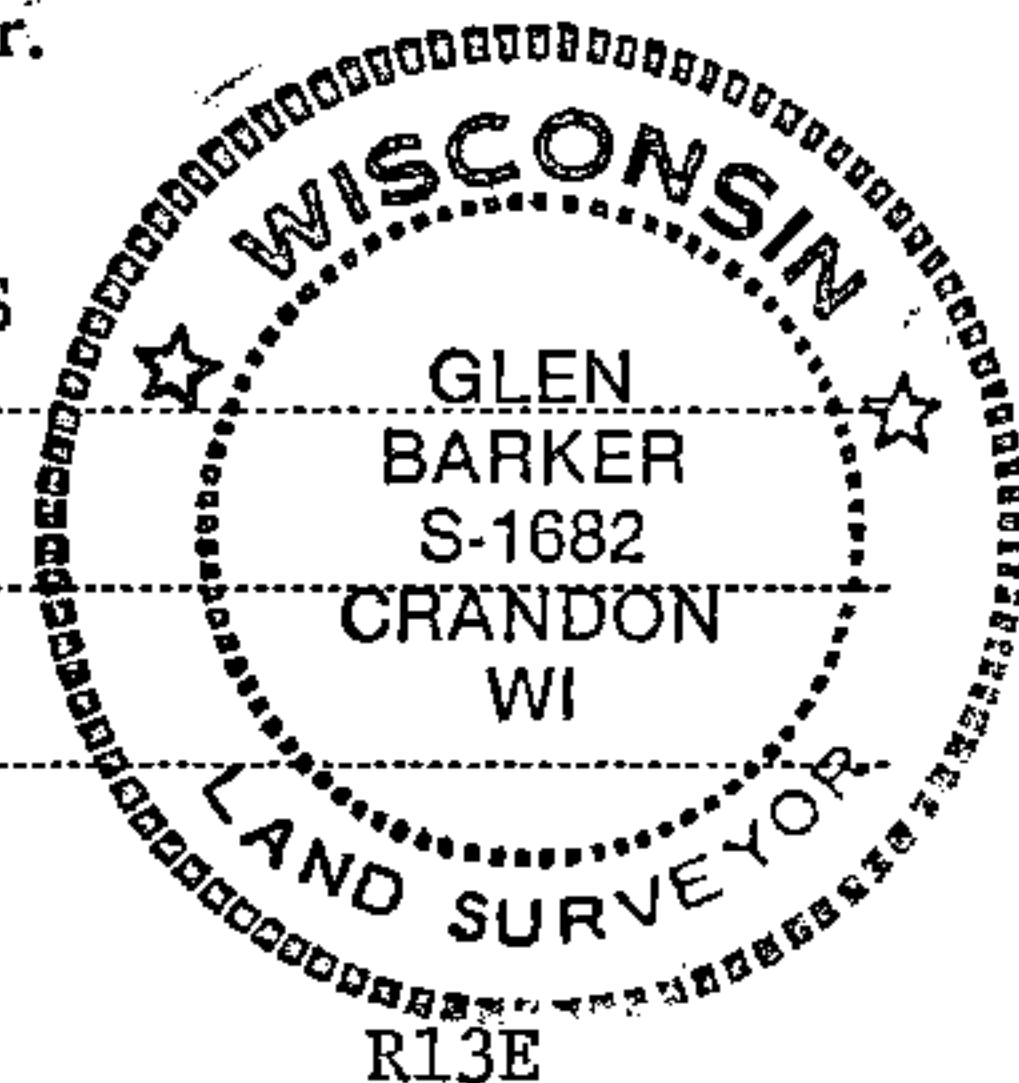

Description of monument and accessories I established to perpetuate the original location of this corner.
Set a 1" iron pipe with 2" diameter alloy cap stamped: S1682

Monument projects 18" above ground. T34N R13E
Marked NBTs: SW1/16 S13
CPI - 1982

Sugar 5" S72E 21.10 ft.
Sugar 6" S10W 32.65 ft.
Scribed 1/16 - B.T.

T34N

R13E

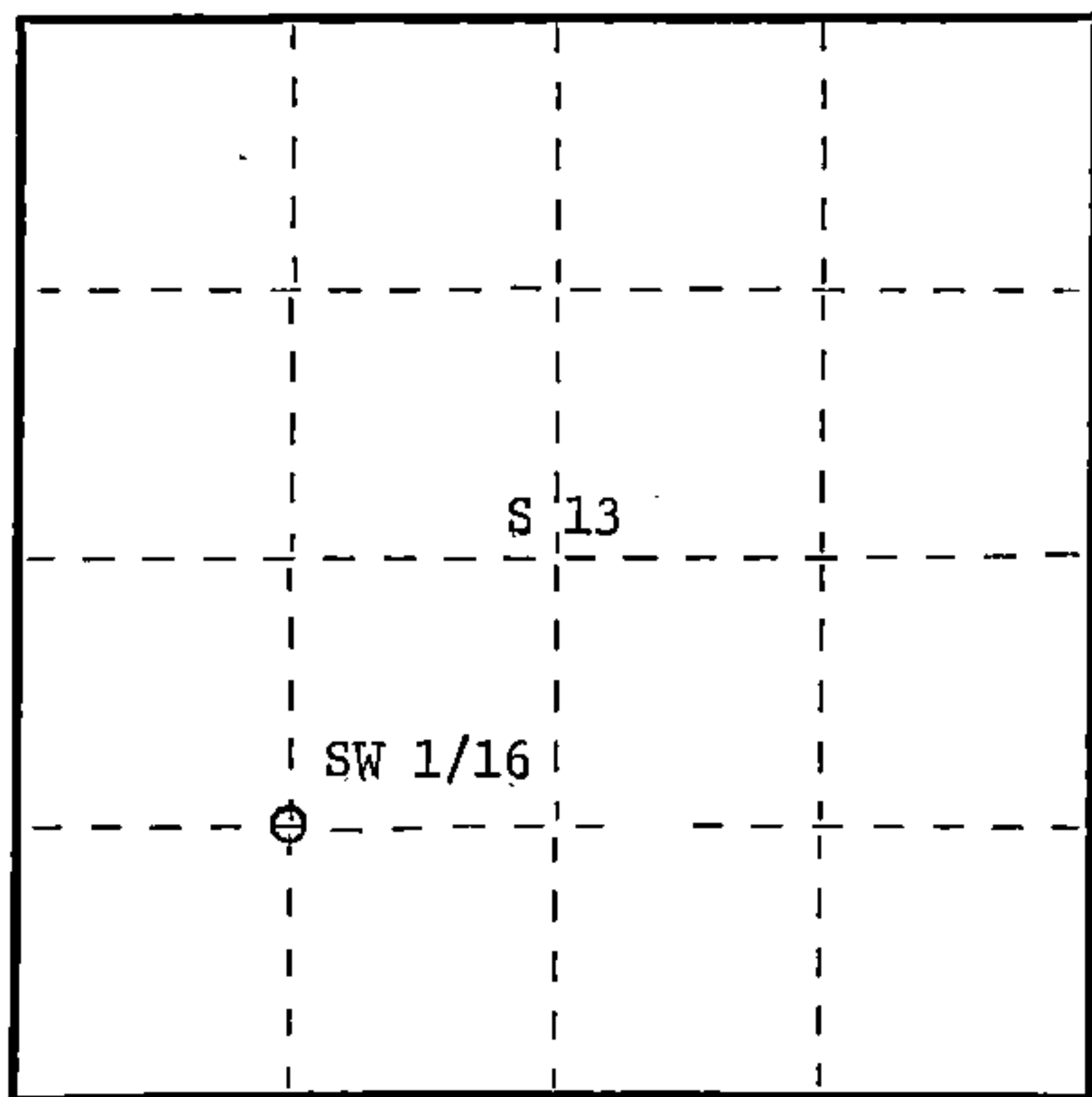

○ = Corner monument restored.

Dated at Rhineland, Wis., this 30th day of December, 19 82.

Signature Glen Barker Title Registered Land Surveyor Registration No. S1682
(County Surveyor, Registered Land Surveyor, or other duly authorized official)

Office of Register of Deeds, County of Forest. I hereby certify that the within
instrument was filed in this office for record on the 16th day of February, 19 83
at 10:30 o'clock A. M.

Eugene Stutzman
(Register of Deeds)
By _____ Deputy

DOCUMENT NO. **122907**

FORM 985 H. C. MILLER CO., MILWAUKEE

43413131030